

Application

Two-piece square pole base cover for use with hinged poles with 5" bottom diameter.

Materials

Aluminum housing
Stainless steel hardware

Finish

All BEGA standard finishes are matte, textured powder coat with minimum 3 mil thickness. BEGA Unidure® finish provides superior fade protection in Black, Bronze, and Silver. BEGA standard White is a super durable polyester powder. Optionally available RAL, custom, and premium colors provided in polyester powder and/or liquid paint.

Available colors

| | |
|--------------|--------------|
| Black (BLK) | Bronze (BRZ) |
| Silver (SLV) | White (WHT) |
| RAL: | CUS: |

Type:

BEGA Product:

Project:

Modified:

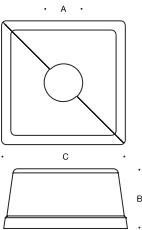

Base Cover · Square base cover

| | A | B | C |
|--------|-------|-------|--------|
| B19615 | 5 1/8 | 7 1/4 | 14 1/2 |

