

Tools Required:

- 3mm hex head screwdriver
- Phillips head screwdriver
- Adjustable wrench

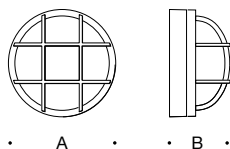

Dimensions

A: 8"

B: 4-5/8"

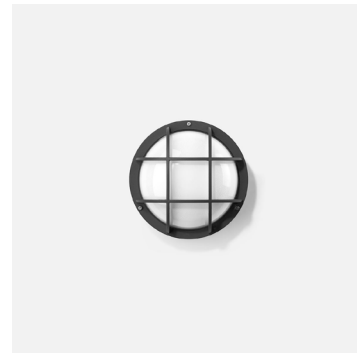

Overview:

LED Watts: 8.4W
 System Watts: 11.0W
 Controllability: 0-10V dimmable
 Weight: 3.1 lbs.
 Protection Class: IP65

Notice to Installer:

1. BEGA luminaires may be damaged if connected to conduit systems containing water. Article 300-5G of National Electric Code requires that "Conduits or raceways through which moisture may contact energized live parts shall be sealed or plugged at either or both ends."
2. See page 2 for specific product safety warnings.
3. Mounts directly to standard octagonal wiring box (by others) using KIT #41 (included); see Figure 1. The wiring box needs to be recessed into the wall and must be flush with the finished surface.
4. In conformance with U.L. Standards 1598, a silicone-based sealant **MUST** be used between the back casting edge and supporting wall.

WARNING: LEDs are high-quality electronic components! Please avoid touching the light output opening of the LED directly during installation.

Figure 1:

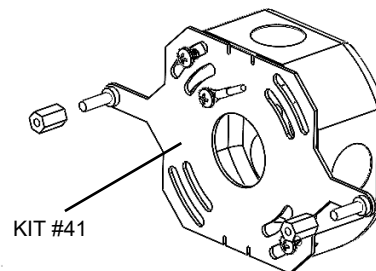

Installation: 22463

1. Remove glass and cage from luminaire housing by loosening (3) 3mm hex head screws. Set aside.
2. Attach KIT #41 to the recessed junction box using 8-32" x 1/2" hardware included.
3. Make supply wiring and luminaire wiring connections inside the recessed junction box:
 SUPPLY WIRING CONNECTIONS:
 - MAIN VOLTAGE (HOT) SUPPLY WIRE TO BLACK DRIVER WIRE
 - NEUTRAL (COMMON) SUPPLY WIRE TO WHITE DRIVER WIRE
 - GREEN (GROUND) WIRE TO GREEN DRIVER WIRE
 0-10V DIMMING (IF APPLICABLE):
 - DIM CONTROL (+) TO POSITIVE DRIVER DIM CONTROL WIRE
 - DIM CONTROL (-) TO NEGATIVE DRIVER DIM CONTROL WIRE
4. Attach the base of luminaire to KIT #41 by placing the mounting holes over the studs on the mounting kit. Secure into place by tightening the (2) hex standoffs.

Figure 2:

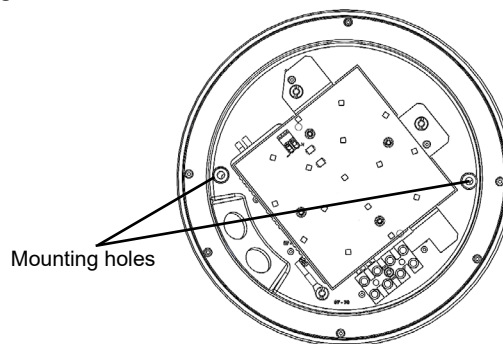
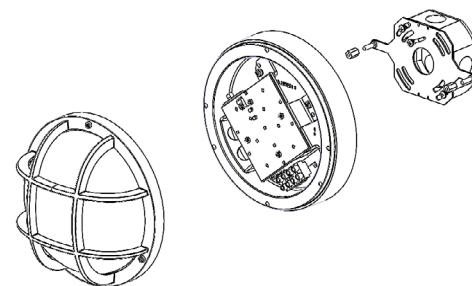

Figure 3:



WARNING: LEDs are high-quality electronic components! Please avoid touching the light output opening of the LED directly during installation.

5. Place glass and cage onto luminaire base and fasten (3) 3mm hex head set screws to secure into place. Ensure the gasket is seated correctly.
6. For exterior installations, apply a small bead of silicone around the luminaire and supporting wall.

Accessories

Please refer to the appropriate accessory installation sheet for further instruction when applicable.

Surface wiring box cover

SWBC

Maintenance:

Clean regularly with solvent-free cleaner removing dirt and debris. Do not use high pressure cleaners.

Replacement Parts

See label inside of fixture for LED replacement part number.

Consult factory for all other replacement components.

Product Safety Warnings:

THIS PRODUCT MUST BE INSTALLED IN ACCORDANCE WITH THE APPLICABLE INSTALLATION CODE BY A PERSON FAMILIAR WITH THE CONSTRUCTION AND OPERATION OF THE PRODUCT AND THE HAZARDS INVOLVED.

SUITABLE FOR WET LOCATIONS.

MIN 60°C SUPPLY CONDUCTORS.

SUITABLE FOR MOUNTING WITHIN 1.2m (4 ft) OF THE GROUND.

CE PRODUIT DOIT ÊTRE INSTALLÉ SELON LE CODE D'INSTALLATION PERTINENT, PAR UNE PERSONNE QUI CONNAÎT BIEN LE PRODUIT ET SON FONCTIONNEMENT AINSI QUE LES RISQUES INHÉRENTS.

CONVIENT AUX EMPLACEMENTS MOUILLÉS.

LES FILS D'ALIMENTATION 60°C MIN.

PUET ÊTRE INSTALLÉ À MOINS DE 1,2m (4 pi) DU SOL.