

REV	CHANGED BY	DESCRIPTION	DATE

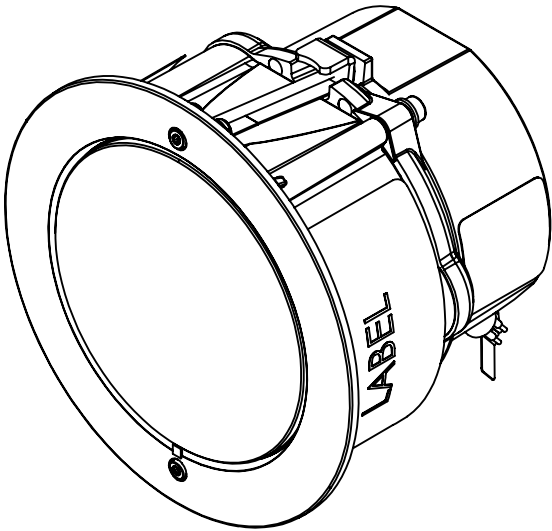
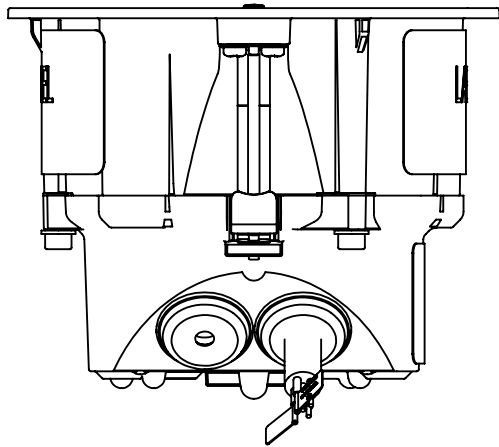
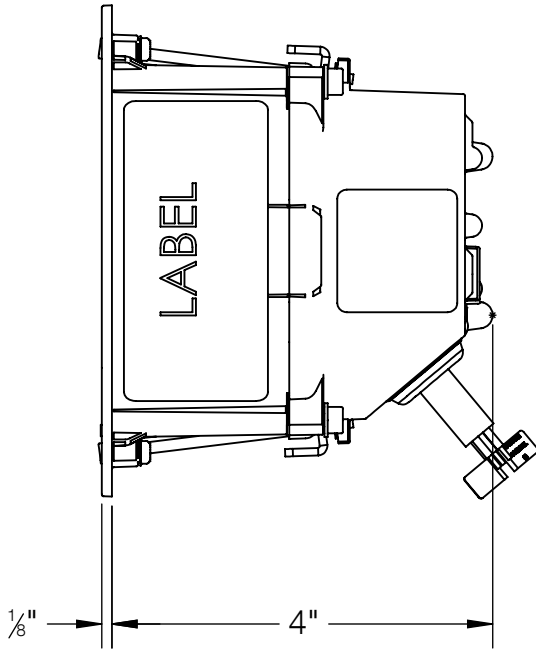
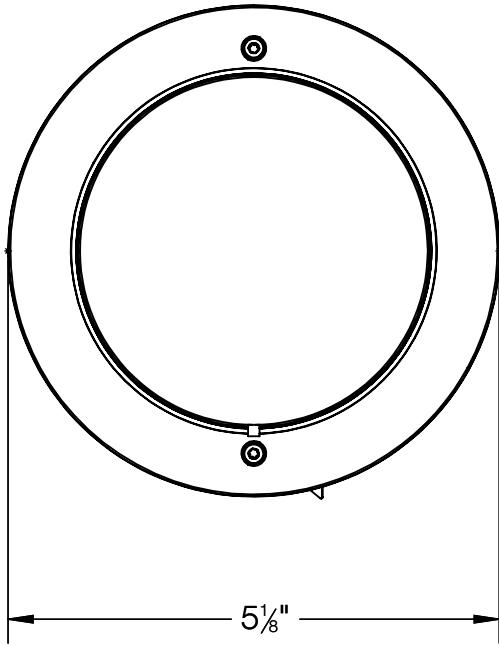

NOTES:
1. INCLUDES: BB24011 INSTALLATION HOUSING

BEGA				
1000 BEGA Way, Carpinteria, California 93013			P (805) 684-0533 - www.bega-us.com	
APPROVED: _____		DATE: _____		DESCRIPTION:
TYPE: _____				RECESSED WALL LUMINAIRE - UNSHIELDED
PROPRIETARY AND CONFIDENTIAL THE INFORMATION CONTAINED IN THIS DRAWING IS THE SOLE PROPERTY OF BEGA NORTH AMERICA, INC. ANY REPRODUCTION IN PART OR AS A WHOLE WITHOUT THE WRITTEN PERMISSION OF BEGA NORTH AMERICA, INC. IS PROHIBITED.		SIZE	PART NO.	REV
		B	24011	-
NOT TO SCALE		11/05/2020	SHEET 1 OF 2	

REV	CHANGED BY	DESCRIPTION	DATE

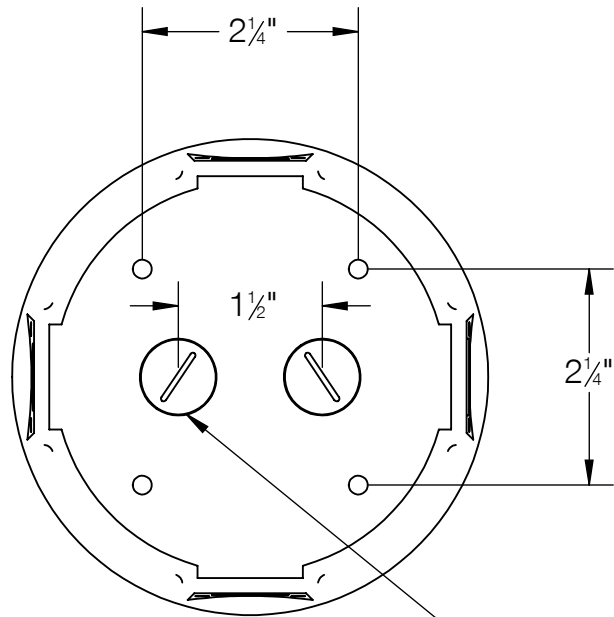
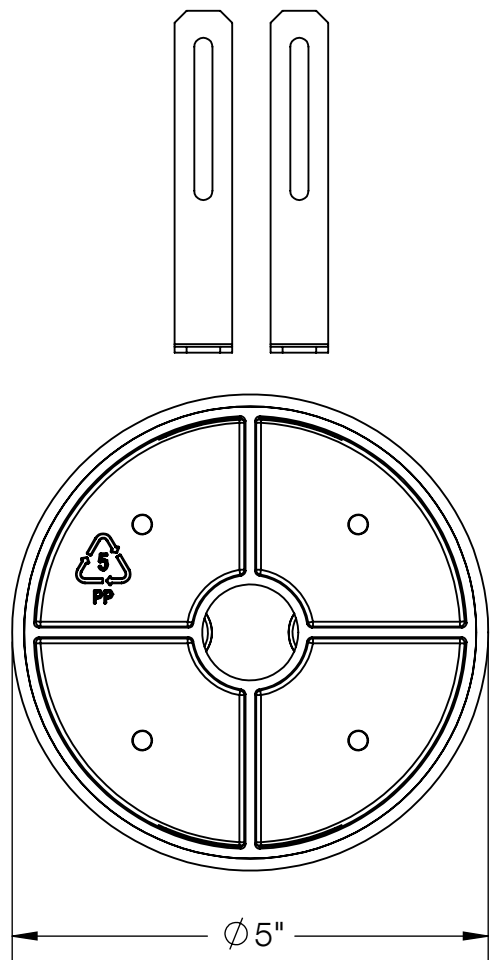

1/2" NPT
THREADED
REAR CONDUIT
ENTRY (2X)

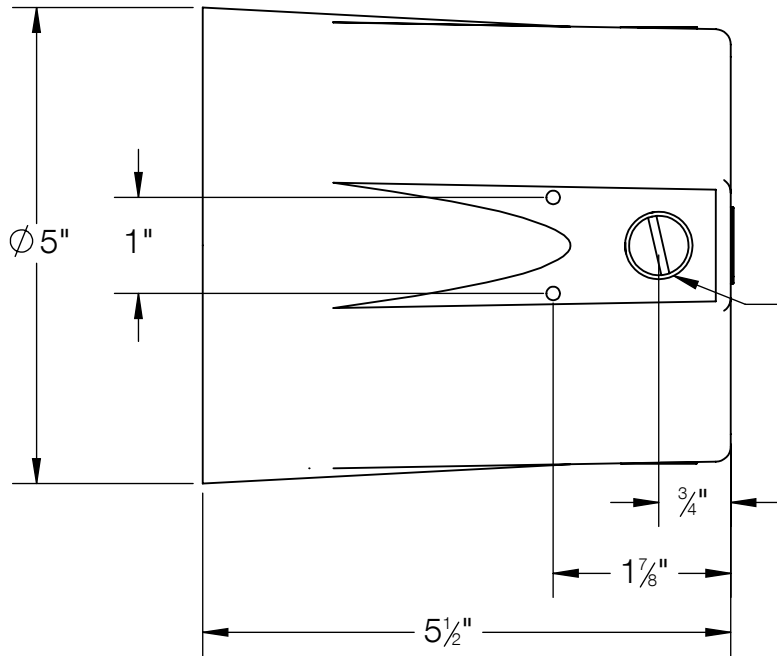

1/2" NPT
THREADED
SIDE CONDUIT
ENTRY (4X)

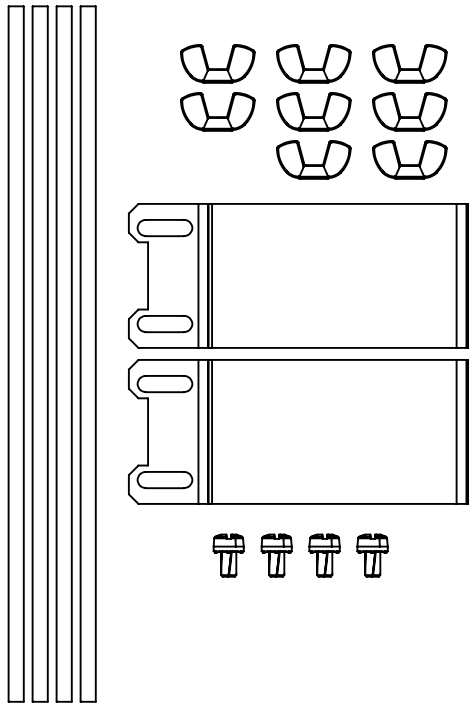

NOTES:
1. INCLUDES: KIT #90 MOUNTING KIT

BEGA

1000 BEGA Way, Carpinteria, California 93013 P (805) 684-0533 - www.bega-us.com

APPROVED: _____ DATE: _____
TYPE: _____

DESCRIPTION:
INSTALLATION HOUSING

PROPRIETARY AND CONFIDENTIAL
THE INFORMATION CONTAINED IN THIS DRAWING IS THE SOLE PROPERTY
OF BEGA NORTH AMERICA, INC.
ANY REPRODUCTION IN PART OR AS A WHOLE WITHOUT THE WRITTEN
PERMISSION OF BEGA NORTH AMERICA, INC. IS PROHIBITED.

SIZE	PART NO.	REV
B	BB24011	-
NOT TO SCALE	11/5/2020	SHEET 2 OF 2