

**Tools Required:**

- 2.5mm Hex Key
- 3mm Hex Key
- Phillips Head Screwdriver

**Overview:**

LED Watts: 0.95W  
 System Watts: 3W  
 Weight: 1.32 lbs.  
 Protection Class: IP65

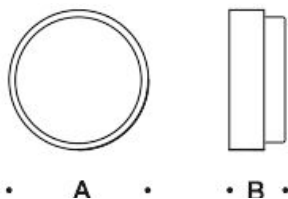

**Dimensions**

A: 4"

B: 2"

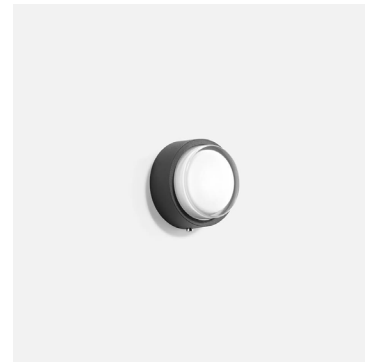

**Notice to Installer:**

1. See page 2 for specific product safety warnings.
2. BEGA luminaires may be damaged if connected to conduit systems containing water. Article 300-5G of National Electric Code requires that "Conduits or raceways through which moisture may contact energized live parts shall be sealed or plugged at either or both ends."
3. Mounts directly to recessed BEGA 19 538 small opening wiring box using mounting bracket (provided). (Figure 1)
4. This luminaire requires a UL listed class 2 remote 24V DC power supply. **DO NOT USE LINE VOLTAGE.**
5. Be sure to install 19 538 small wiring box with mounting holes oriented in the horizontal position.
6. In conformance with U.L. Standards 1598, a silicone-based sealant **MUST** be used between the mounting plate edge and supporting surface.

**Figure 1:**

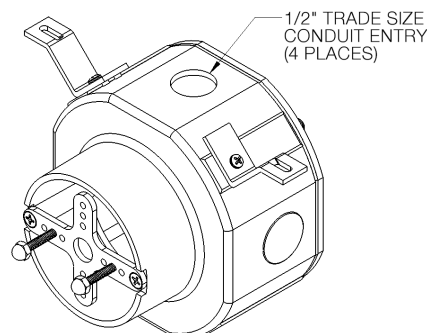

**19538 Wiring Box Installation:**

1. BEGA small opening wiring box intended for use with BEGA luminaires that can not be installed over a standard wiring box. Please note a 3-1/4" opening size in finished surface is required for proper installation. Round opening must be flush with the finished surface. (Figure 1)
2. **For stud ceiling installation:** Install mounting brackets (included) into 19538 wiring box using hardware (included) and then secure mounting brackets to stud using appropriate hardware by others. (Figure 2)
3. **For concrete installations:** Attach mounting bracket to box using hardware provided. Attach wiring box to concrete form ensuring round opening of box will be flush with the finished surface. (Figure 2)
4. Make conduit connection to wiring box and pull supply wire for connections to be made later. Wiring box provided includes (4) 1/2" trade size conduit openings.
5. Finish wall or ceiling.

**Figure 2:**

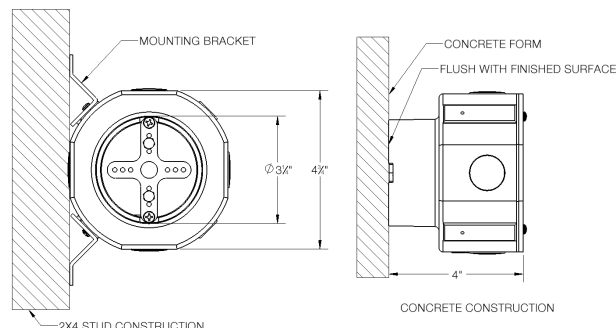

**24037 - Installation:**

1. Loosen 3mm set screw on luminaire outer trim ring and turn ring to the stop. Remove trim ring with glass from luminaire base.
2. Loosen (2) 2.5mm hex screws on LED module plate and **CAREFULLY** remove LED module - trying not to come into direct contact with the LED chips.
3. Route fixture wiring out through luminaire base and into small opening wiring box for connections to be made.
4. Make 24V DC supply wiring and luminaire connections in small opening wiring box:  
 NEGATIVE SUPPLY WIRE TO BLACK LED LUMINAIRE WIRE  
 POSITIVE SUPPLY WIRE TO RED LED LUMINAIRE WIRE
5. Attach mounting strap to wiring box using (2) 1/2" phillips head screws. (Figure 3)
6. Attach luminaire base to mounting strap with acorn nuts. (Figure 3)
7. Place a small bead of silicone around the back side of the luminaire base that will come in contact with the finished wall (exterior applications only).
8. Replace the LED module carefully along with luminaire lens and trim ring. Do not over tighten LED module screws. Turn trim ring to the stop and tighten outer set screw to secure. (Figure 3)

**Figure 3:**

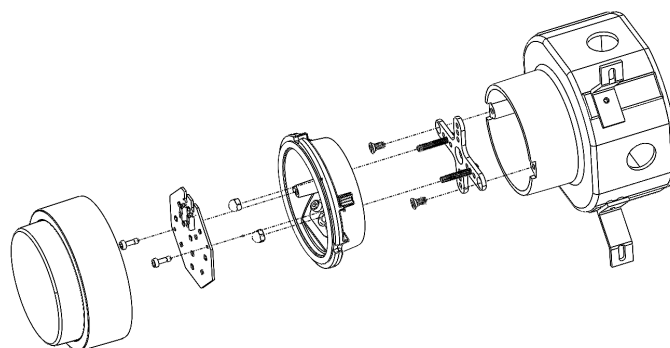

**Accessories**

Please refer to the appropriate accessory installation sheet for further instruction when applicable.

Remote 50W LED Driver and Box 19591  
 Remote 25W LED Driver and Box 19580

**Maintenance:**

Clean regularly with solvent-free cleaner removing dirt and debris. Do not use high pressure cleaners.

**Replacement Parts**

See label inside of fixture for LED replacement part number.

Consult factory for all other replacement components.

**Product Safety Warnings:**

**THIS PRODUCT MUST BE INSTALLED IN ACCORDANCE WITH THE APPLICABLE INSTALLATION CODE BY A PERSON FAMILIAR WITH THE CONSTRUCTION AND OPERATION OF THE PRODUCT AND THE HAZARDS INVOLVED.**

**USE ONLY WITH CLASS 2 POWER UNIT.**

**SUITABLE FOR WET LOCATIONS.**

**SUITABLE FOR MOUNTING WITHIN 1.2 M (4 FT) OF GROUND.**

**MIN 60°C SUPPLY CONDUCTORS.**

**CE PRODUIT DOIT ÊTRE INSTALLÉ SELON LE CODE D'INSTALLATION PERTINENT, PAR UNE PERSONNE QUI CONNAÎT BIEN LE PRODUIT ET SON FONCTIONNEMENT AINSI QUE LES RISQUES INHÉRENTS.**

**UTILISER SEULEMENT AVEC UNITÉ DE CLASSE 2.**

**CONVIENT AUX EMPLACEMENTS MOUILLÉS.**

**PUÊTRE INSTALLÉ À MOINS DE 1,2 M (4 PI) DU SOL.**

**LES FILS D'ALIMENTATION 60°C MIN.**