

REV	CHANGED BY	DESCRIPTION	DATE

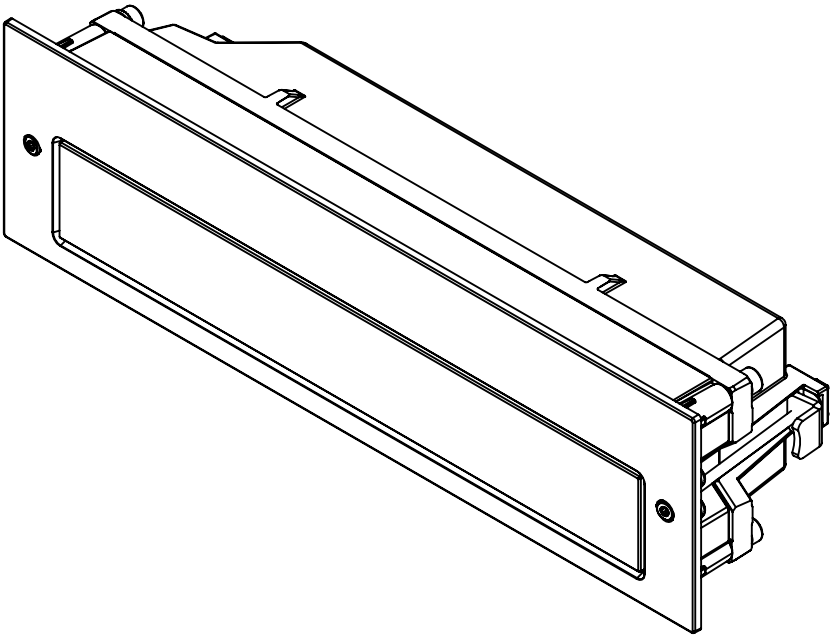
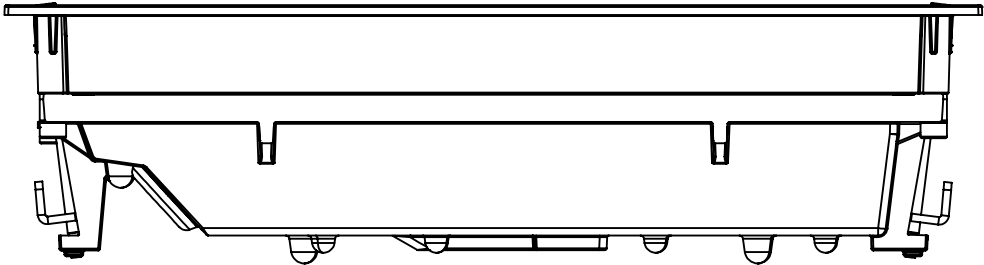
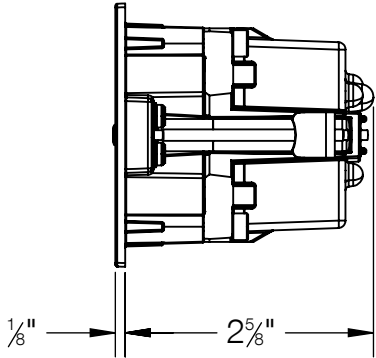
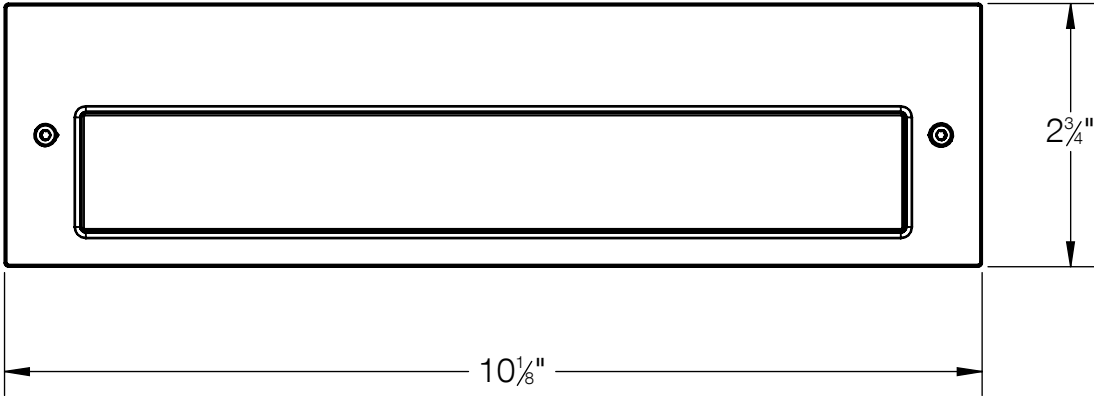

NOTES:  
1. INCLUDES BB24064 - INSTALLATION HOUSING

BEGA				
1000 BEGA Way, Carpinteria, California 93013			P (805) 684-0533 - www.bega-us.com	
APPROVED: _____ DATE: _____		DESCRIPTION: RECESSED WALL LUMINAIRE - EXTENDED THROW		
TYPE: _____				
PROPRIETARY AND CONFIDENTIAL  THE INFORMATION CONTAINED IN THIS DRAWING IS THE SOLE PROPERTY OF BEGA NORTH AMERICA, INC.  ANY REPRODUCTION IN PART OR AS A WHOLE WITHOUT THE WRITTEN PERMISSION OF BEGA NORTH AMERICA, INC. IS PROHIBITED.		SIZE	PART NO.	REV
		B	24064	-
		NOT TO SCALE	2/12/2025	SHEET 1 OF 2

REV	CHANGED BY	DESCRIPTION	DATE

FRONT VIEW

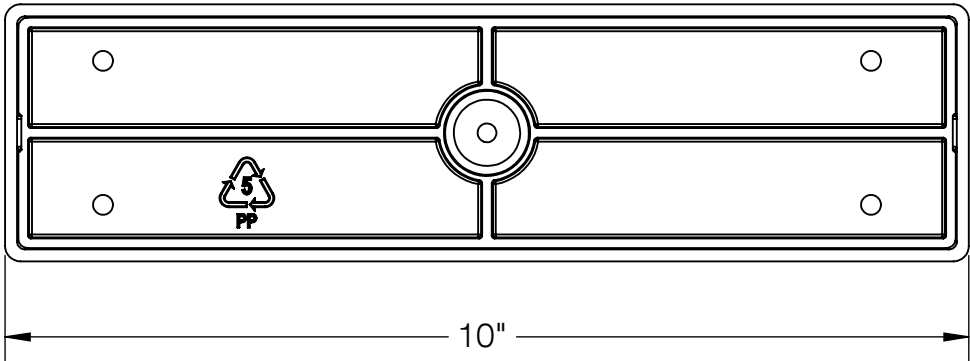

SIDE VIEW

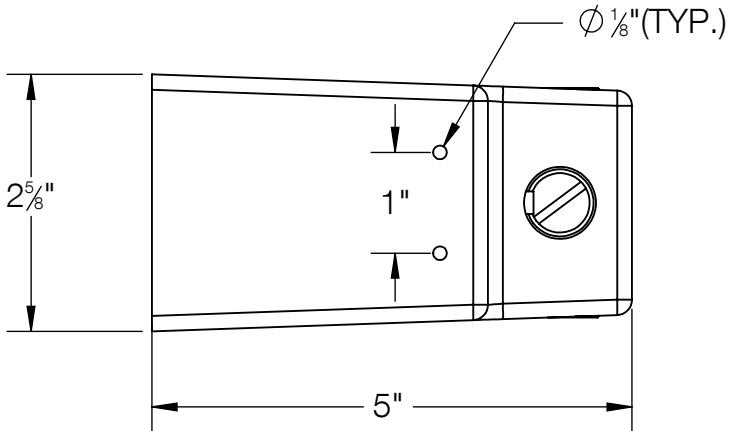

BACK VIEW

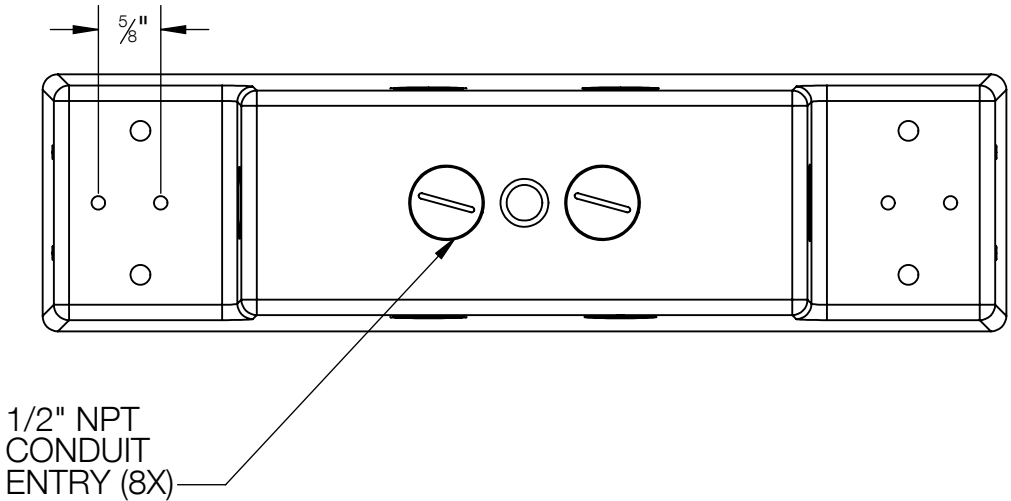

1/2" NPT  
CONDUIT  
ENTRY (8X)

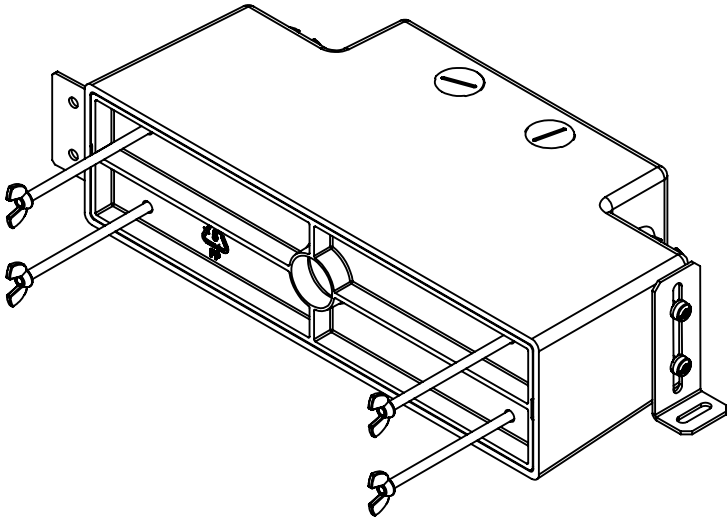

- NOTE:
- INCLUDES: KIT #73 - MOUNTING KIT (SHOWN IN ISOMETRIC VIEW ONLY):  
(4) THREADED RODS AND (8) WING NUTS, (2) BRACKETS FOR MASONRY INSTALLATION, (2) BRACKETS FOR STUD WALL INSTALLATION, BRACKET HARDWARE

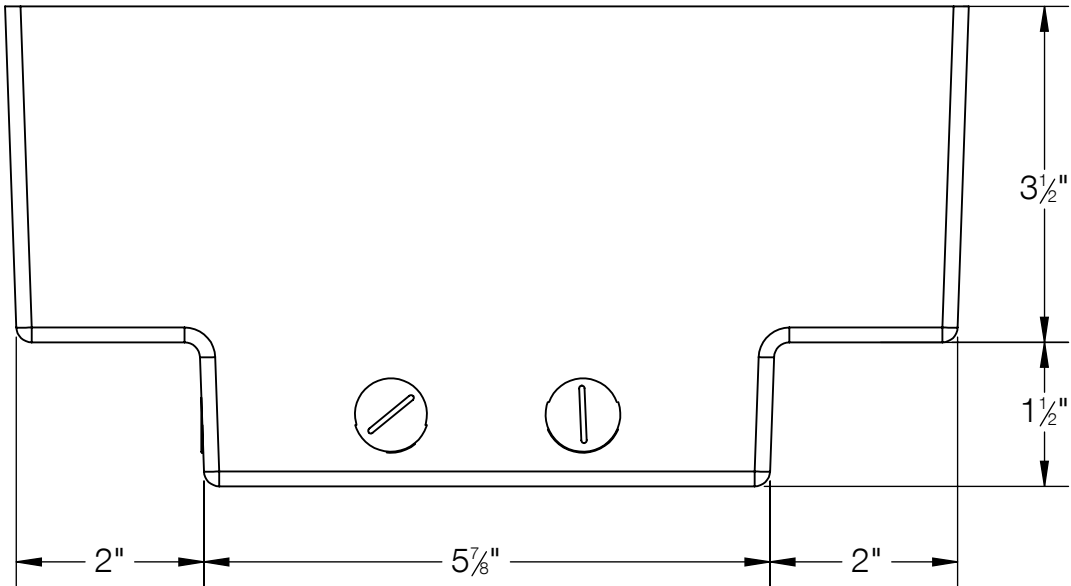

BEGA				
1000 BEGA Way, Carpinteria, California 93013			P (805) 684-0533 - www.bega-us.com	
APPROVED: _____ DATE: _____		DESCRIPTION: INSTALLATION HOUSING		
TYPE: _____				
PROPRIETARY AND CONFIDENTIAL THE INFORMATION CONTAINED IN THIS DRAWING IS THE SOLE PROPERTY OF BEGA NORTH AMERICA, INC. ANY REPRODUCTION IN PART OR AS A WHOLE WITHOUT THE WRITTEN PERMISSION OF BEGA NORTH AMERICA, INC. IS PROHIBITED.		SIZE	PART NO.	REV
		B	BB24064	-
		NOT TO SCALE	2/12/2025	SHEET 2 OF 2