

Tools Required:

- 3mm hex key
- Phillips head screw driver medium

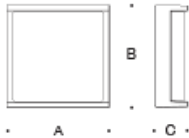

- Dimensions**
- A: 9-1/2 "
 - B: 9-1/2 "
 - C: 3-1/4 "

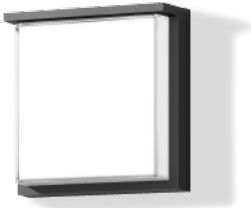

Protection Class: IP65

Weight: 8.6 lbs.

- Notice to Installer for 24 070:**
- 1. **BEGA luminaires may be damaged if connected to conduit systems containing water- Article 300-5G of National Electric Code requires that “Conduits or raceways through which moisture may contact energized live parts shall be sealed or plugged at either or both ends”.**
 - 2. Mounts directly to wall OVER standard recessed 4" wiring box (by others).
 - 3. In conformance with U.L. Standards 1598, a silicone-based sealant **MUST** be used between the luminaire base edge and supporting wall.
 - 4. LEDs are high-quality electronic components! Please avoid touching the light output opening of the LED directly during installation.

- 24 070 - installation:**
- 1. Loosen (2) M6 set screws on bottom edge of fixture to remove luminaire top casting and glass with gasket from luminaire base.
 - 2. Feed luminaire wires through wall mounting bracket.
 - 3. Make supply wiring and luminaire wiring connections in the octagonal wiring box:
MAIN VOLTAGE SUPPLY WIRE TO BLACK LUMINAIRE WIRE
NEUTRAL (COMMON) SUPPLY WIRE TO WHITE LUMINAIRE WIRE
WIRE GREEN GROUND WIRE TO GREEN LUMINAIRE WIRE
Dimming (if applicable):
DIMMING CONTROL WIRE (+) TO POSITIVE DRIVER DIM CONTROL WIRE
DIMMING CONTROL WIRE (-) TO NEGATIVE DRIVER DIM CONTROL WIRE
 - 4. Attach wall mounting bracket to recessed wiring box with (2) Phillips head screws provided.
 - 5. Place a small bead of silicone around the back side of the luminaire base that will come in contact with the finished surface (exterior applications only).
 - 6. Secure luminaire base to wall mounting bracket with (2) hex nuts provided on mounting kit.
 - 7. Replace luminaire top casting with glass and gasket. Ensure that gasket is seated properly. Tighten (2) set screws to secure luminaire top with luminaire base.

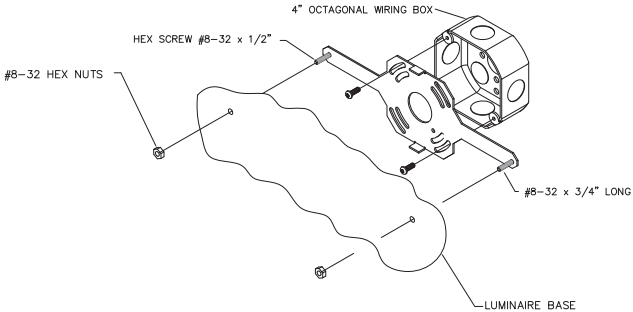

Relamping/Maintenance
No relamping required.

Accessories
Please refer to the appropriate accessory installation sheet for further instruction when applicable.

Replacement Parts	
Description	Part No
Lens	113285
Lens Gasket	831667
LED Driver (120-277V)	75987
LED Module (3000K)	LED-0841/930
LED Module (4000K)	LED-0841/940

Lamp: 11.5W LED

Product Safety Warnings:

THIS PRODUCT MUST BE INSTALLED IN ACCORDANCE WITH THE APPLICABLE INSTALLATION CODE BY A PERSON FAMILIAR WITH THE CONSTRUCTION AND OPERATION OF THE PRODUCT AND THE HAZARDS INVOLVED. SUITABLE FOR WET LOCATIONS.

MIN 90°C SUPPLY CONDUCTORS.

CE PRODUIT DOIT ÊTRE INSTALLÉ SELON LE CODE D'INSTALLATION PERTINENT, PAR UNE PERSONNE QUI CONNAÎT BIEN LE PRODUIT ET SON FONCTIONNEMENT AINSI QUE LES RISQUES INHÉRENTS. CONVIENT AUX EMPLACEMENTS MOUILLÉS.

LES FILS D'ALIMENTATION 90°C MIN.
