

Tools Required:

4mm hex key
Phillips medium screw driver

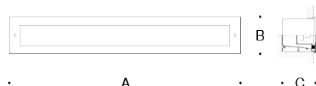

Dimensions

A: 60-7/8 "
B: 5 "
C: 5 "

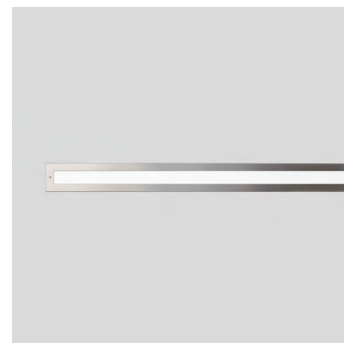

Protection Class: IP67

Weight: 23.0 lbs.

Notice to Installer for 24 106:

1. In conformance with UL Standard 1598, a silicone based sealant must be used between luminaire and supporting wall.
2. Outer housing must be installed so that the front face of housing is flush with the finished wall.
3. Do not pump or drop concrete directly on top of the back housing.
4. Do not leave inner housing hanging from aircraft cable for extended periods of time.
5. To service internal components, place inner housing on ground or suitable surface to remove front faceplate.

Hollow wall construction installation for BB24106:

1. Assemble mounting brackets (**Figure 2**): Attach [2] Phillips screws into the [2] U-bracket as shown. Attach [2] L-brackets to each side of U-bracket using wing nuts (Included) as shown.
2. Use [2] Phillips self tapping screws to attach U-bracket to back housing shown.
3. Adjust brackets (by adjusting wing nuts) that the front face of back housing will be flush to the finished wall surface; failure to do so will result in luminaire not sealing properly.
4. Secure mounting brackets to wood or metal horizontal blocking with hardware [by others].
5. Connect conduit and pull wires for electrical connections to be made later.

Poured concrete Installation for BB24106:

1. Screw (2) #8-32 threaded rods into the back side of the back housing. (**Figure 3**)
2. Attach back housing to concrete form using (2) wing nuts and (2) washers provided. (**Figure 3**)
3. Connect conduit to back housing.
4. Pour concrete. Do not pump or drop concrete directly on top of the back housing.
5. Remove form work and pull wires for electrical connections to be made later.

Installation for 24 106:

1. Connect [2] aircraft cables from outer housing to inner housing using 8-30 nuts, for future servicing of fixture. (**Figure 1**)
2. Make necessary wiring connections inside the housing:
MAIN VOLTAGE SUPPLY WIRE TO BLACK LUMINAIRE WIRE
NEUTRAL (COMMON) SUPPLY WIRE TO WHITE LUMINAIRE WIRE
GREEN GROUND WIRE TO GREEN LUMINAIRE WIRE

Dimming (if applicable):

1. DIMMING CONTROL WIRE (+) TO POSITIVE DIM CONTROL WIRE
2. DIMMING CONTROL WIRE (-) TO NEGATIVE DIM CONTROL WIRE
3. Extra ground connection located on outer house must be connected to incoming leads
4. Place a small bead of silicone around the back side of the luminaire flange that will come in contact with the finished wall (exterior applications only).
5. Replace luminaire in installation housing and tighten (2) faceplate screws to secure to outer housing.

Figure 1:

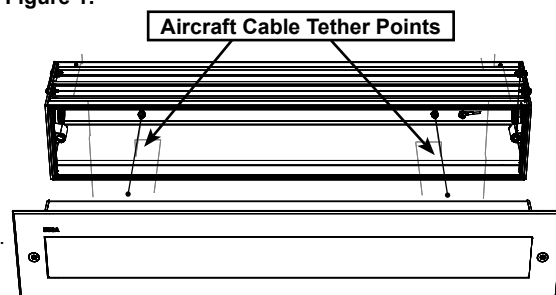

Figure 2:

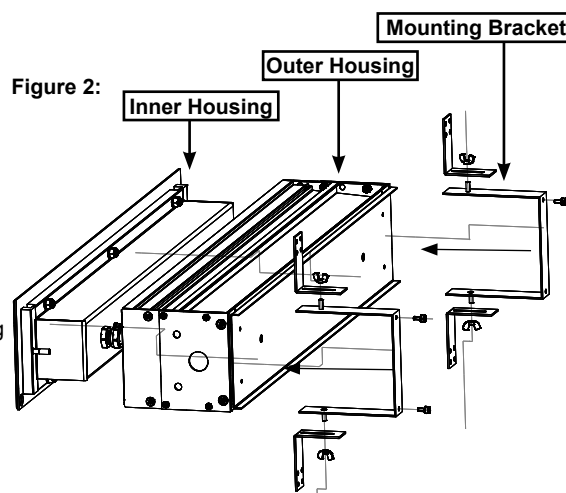
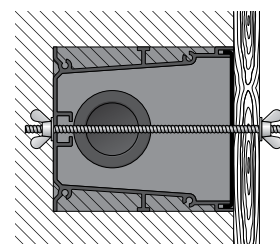

Figure 3:



Relamping/Maintenance

Clean luminaire regularly with solvent-free cleansers from dirt and debris. Do not use high pressure cleaners.

LED module: 30.4W LED

Accessories

Please refer to the appropriate accessory installation sheet for further instruction when applicable.

Replacement Parts

Description	Part No
LED Driver (120-277V)	(1X) 75989-01
LED Module (2700K)	(4X) LED-0379/827
LED Module (3000K)	(4X) LED-0379/830
LED Module (3500K)	(4X) LED-0379/835
LED Module (4000K)	(4X) LED-0379/840