

REV	CHANGED BY	DESCRIPTION	DATE

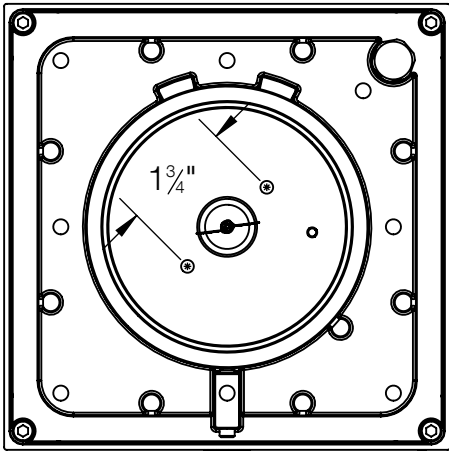
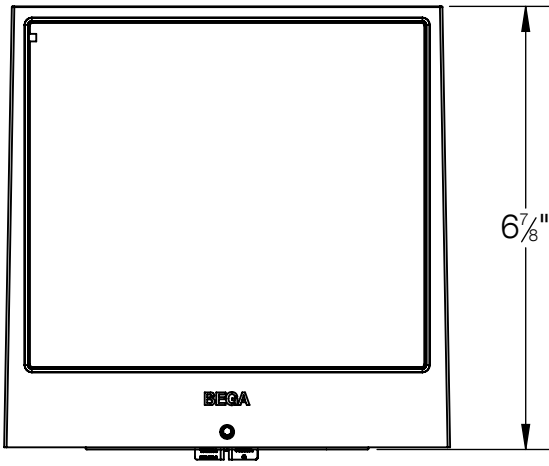
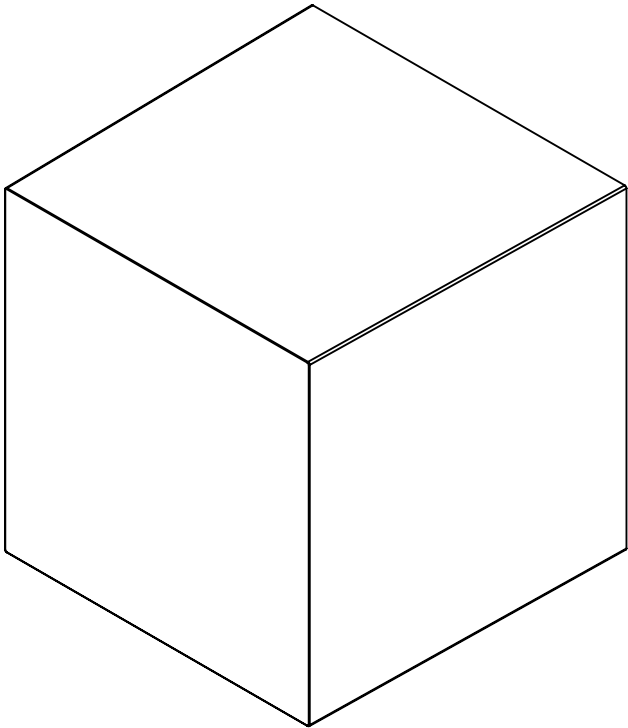
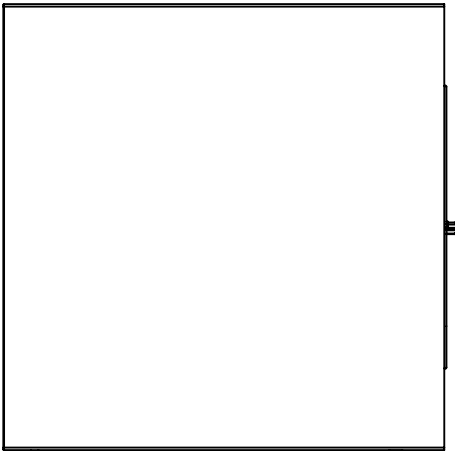
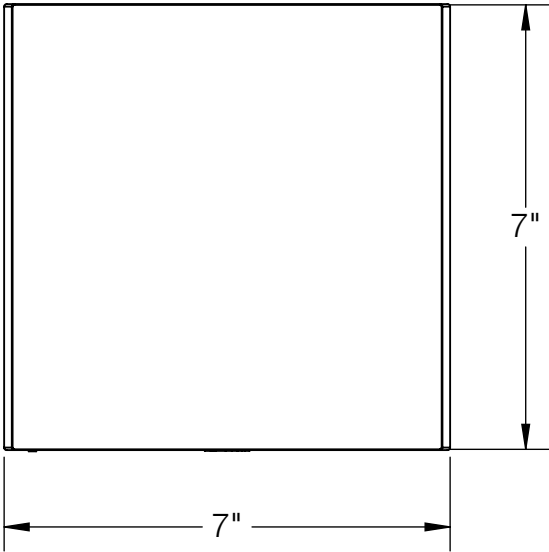

NOTES:
1. INCLUDES MOUNTING KIT #96

BEGA				
1000 BEGA Way, Carpinteria, California 93013			P (805) 684-0533 - www.bega-us.com	
APPROVED: _____		DATE: _____		DESCRIPTION: WALL WASHER - DIRECTED LIGHT
TYPE: _____				
PROPRIETARY AND CONFIDENTIAL		SIZE B	PART NO. 24134	REV -
THE INFORMATION CONTAINED IN THIS DRAWING IS THE SOLE PROPERTY OF BEGA NORTH AMERICA, INC. ANY REPRODUCTION IN PART OR AS A WHOLE WITHOUT THE WRITTEN PERMISSION OF BEGA NORTH AMERICA, INC. IS PROHIBITED.		NOT TO SCALE	02/04/2021	SHEET 1 OF 2

REV	CHANGED BY	DESCRIPTION	DATE

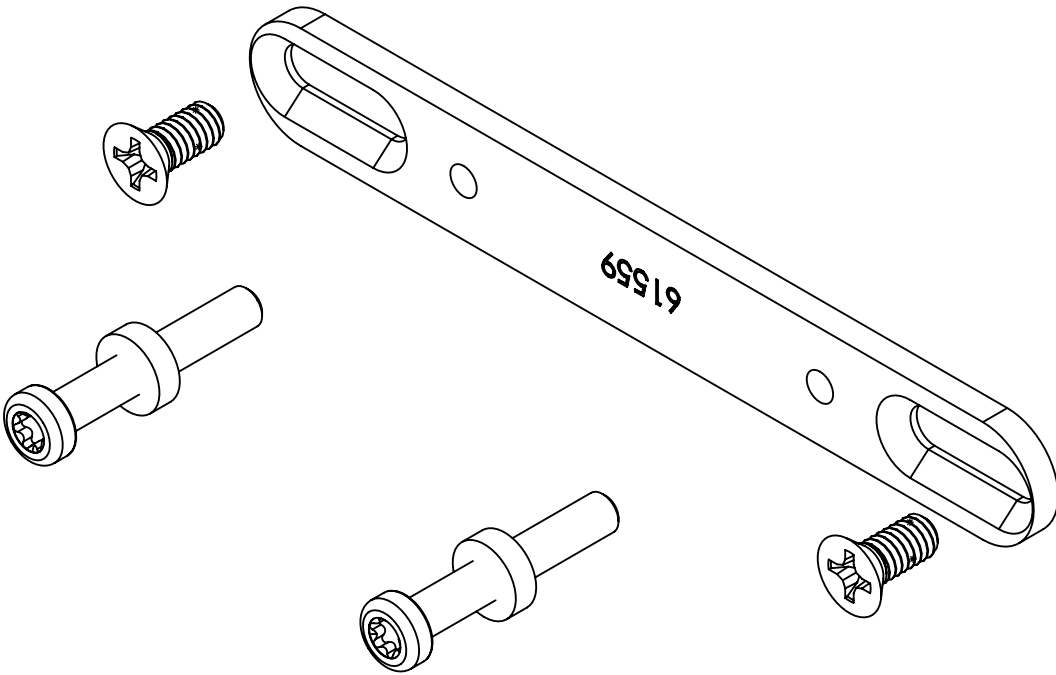
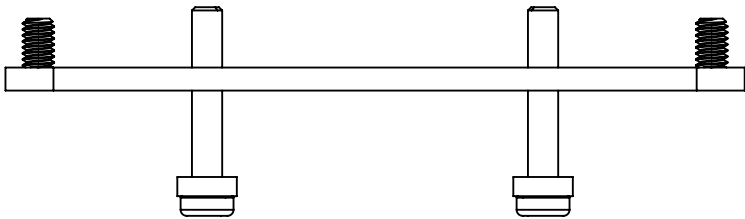
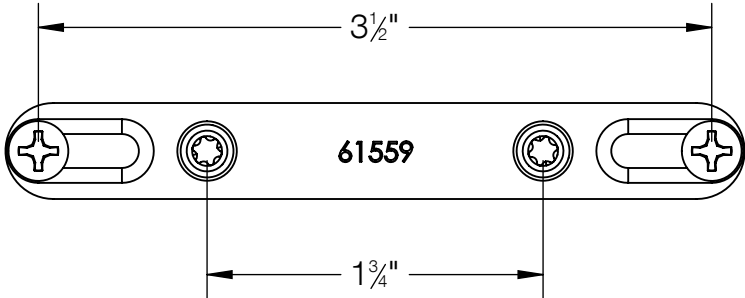

BEGA

1000 BEGA Way, Carpinteria, California 93013 P (805) 684-0533 - www.bega-us.com

APPROVED: _____ DATE: _____
TYPE: _____

DESCRIPTION:
MOUNTING KIT

PROPRIETARY AND CONFIDENTIAL
THE INFORMATION CONTAINED IN THIS DRAWING IS THE SOLE PROPERTY
OF BEGA NORTH AMERICA, INC.
ANY REPRODUCTION IN PART OR AS A WHOLE WITHOUT THE WRITTEN
PERMISSION OF BEGA NORTH AMERICA, INC. IS PROHIBITED.

SIZE B	PART NO. KIT #96	REV -
NOT TO SCALE	02/04/2021	SHEET 2 OF 2