

Tools Required:

- Hammer
Phillips medium screwdriver
T25 torx screwdriver

Dimensions

- A: 60-3/8"
B: 3"
C: 3-1/2"



Weight: 14.55 lbs

Notice to Installer for 24 302:

- See page 2 for specific product safety warnings.
- Luminaire is non-IC rated. Insulation must be at least 3" from luminaire.
- Supplied with rough-in kit (Figure 1). Includes bar hanger brackets for mounting to the ceiling structure (Kit #39). Plaster ring option available, see note below and Figure 2.
- Luminaire not suitable for poured concrete construction.
- Suitable for installation in covered ceilings only.
- Required recessed opening is 60-1/8" x 2-3/4"
- Luminaire supplied with 18" whip. Wiring connections must be made in separate junction box (by others), installed next to ceiling opening to allow for inspection.

Rough-in kit installation instructions:

- Measure distance between available ceiling studs.
- Place provided conduit brackets (Kit #39) in correct position by aligning vertically and tightening single bar hanger screw.
- Level the rough-in pan and nail both brackets to available ceiling studs. For attachment to T-Bar type acoustical ceilings, the brackets can be attached to Caddy Fastners (not included)

Figure 1 (Standard Rough-in Kit)

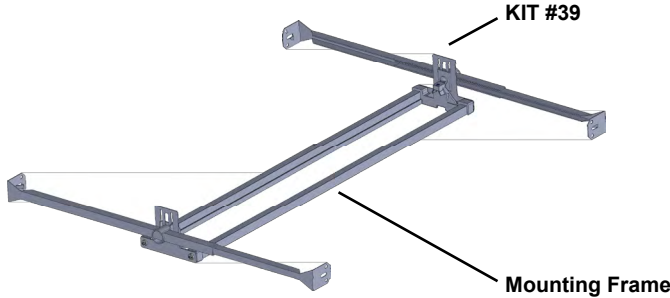

24 302 Installation Instructions:

- Connect loose end of the flexible conduit whip to junction box (by others) and make supply wiring connections:
MAIN VOLTAGE SUPPLY WIRE TO BLACK DRIVER WIRE(S);
NEUTRAL (COMMON SUPPLY WIRE TO WHITE DRIVER WIRE(S);
GREEN GROUND WIRE TO GREEN DRIVER WIRE(S).
- Dimming (if applicable):**
DIMMING CONTROL WIRE (+) TO POSITIVE DRIVER DIM CONTROL WIRE
DIMMING CONTROL WIRE (-) TO NEGATIVE DRIVER DIM CONTROL WIRE
- Push luminaire up into rough-in frame. Secure into place by tightening (x2) T25 torx screws.
- Finished ceiling may now be installed. Required recessed opening is 60-1/8" x 2-3/4"

Figure 2 (Rough-in Kit with Plaster Ring Option)

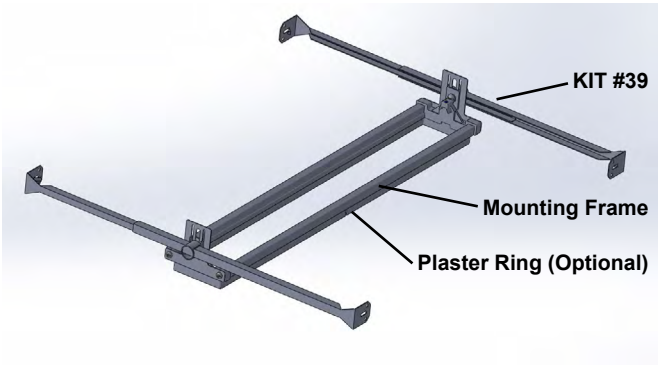

Relamping/Maintenance

Clean luminaire regularly with solvent-free cleansers from dirt and debris. Do not use high pressure cleaners.

Lamp: 48.0W LED

Accessories

Please refer to the appropriate accessory installation sheet for further instruction when applicable.

Replacement Parts

Description	Part No
LED Driver (120-277V)	(1X) 75969-02
LED Module (2700K)	(6X) LED-0772/827
LED Module (3000K)	(6X) LED-0772/830
LED Module (3500K)	(6X) LED-0772/835
LED Module (4000K)	(6X) LED-0772/840

In the interest of product improvement, BEGA reserves the right to make technical changes without notice.

Product Safety Warnings:

THIS PRODUCT MUST BE INSTALLED IN ACCORDANCE WITH THE APPLICABLE INSTALLATION CODE BY A PERSON FAMILIAR WITH THE CONSTRUCTION AND OPERATION OF THE PRODUCT AND THE HAZARDS INVOLVED. SUITABLE FOR WET LOCATIONS.

MIN 90°C SUPPLY CONDUCTORS.

CE PRODUIT DOIT ÊTRE INSTALLÉ SELON LE CODE D'INSTALLATION PERTINENT, PAR UNE PERSONNE QUI CONNAÎT BIEN LE PRODUIT ET SON FONCTIONNEMENT AINSI QUE LES RISQUES INHÉRENTS. CONVIENT AUX EMPLACEMENTS MOUILLÉS.

LES FILS D'ALIMENTATION 90°C MIN.
