

REV	CHANGED BY	DESCRIPTION	DATE

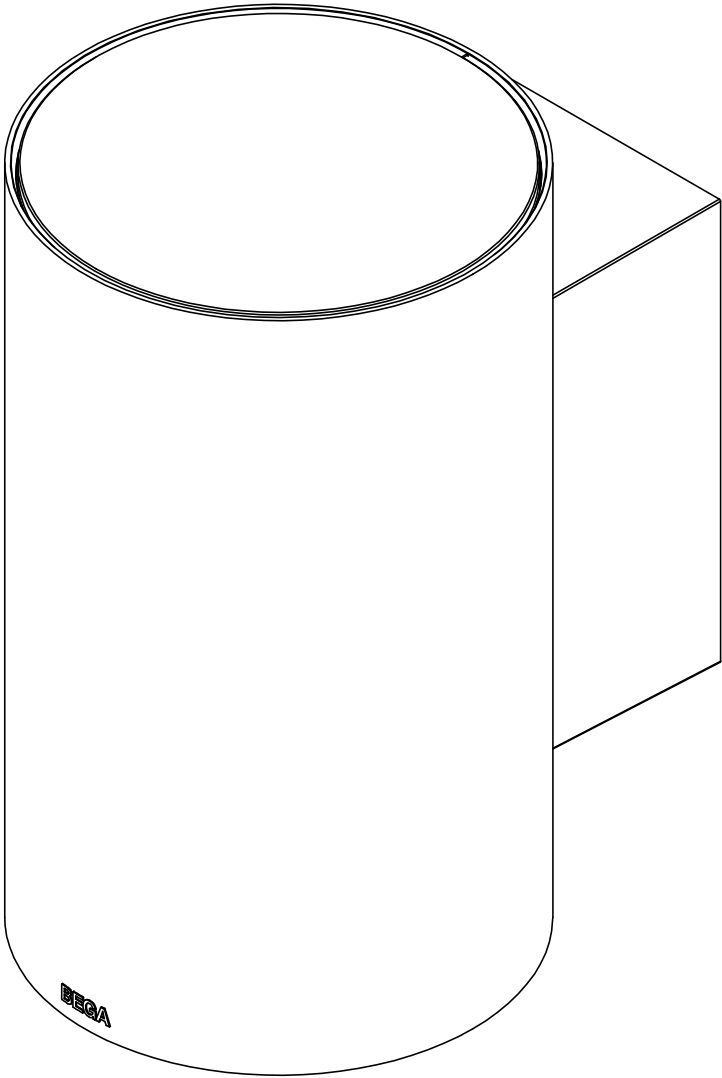

- NOTES:
- 1. INCLUDES 19542 - SMALL OPENING LINEAR WIRING BOX
  - 2. INCLUDES KIT #107 FOR ATTACHMENT TO WIRING BOX

BEGA				
1000 BEGA Way, Carpinteria, California 93013			P (805) 684-0533 - www.bega-us.com	
APPROVED: _____ DATE: _____		DESCRIPTION:		
TYPE: _____		WALL LUMINAIRE · WIDE BEAM IN BOTH DIRECTIONS		
PROPRIETARY AND CONFIDENTIAL THE INFORMATION CONTAINED IN THIS DRAWING IS THE SOLE PROPERTY OF BEGA NORTH AMERICA, INC. ANY REPRODUCTION IN PART OR AS A WHOLE WITHOUT THE WRITTEN PERMISSION OF BEGA NORTH AMERICA, INC. IS PROHIBITED.	SIZE B	PART NO. 24481		REV -
	NOT TO SCALE	10/26/2023	SHEET 1 OF 2	

REV	CHANGED BY	DESCRIPTION	DATE

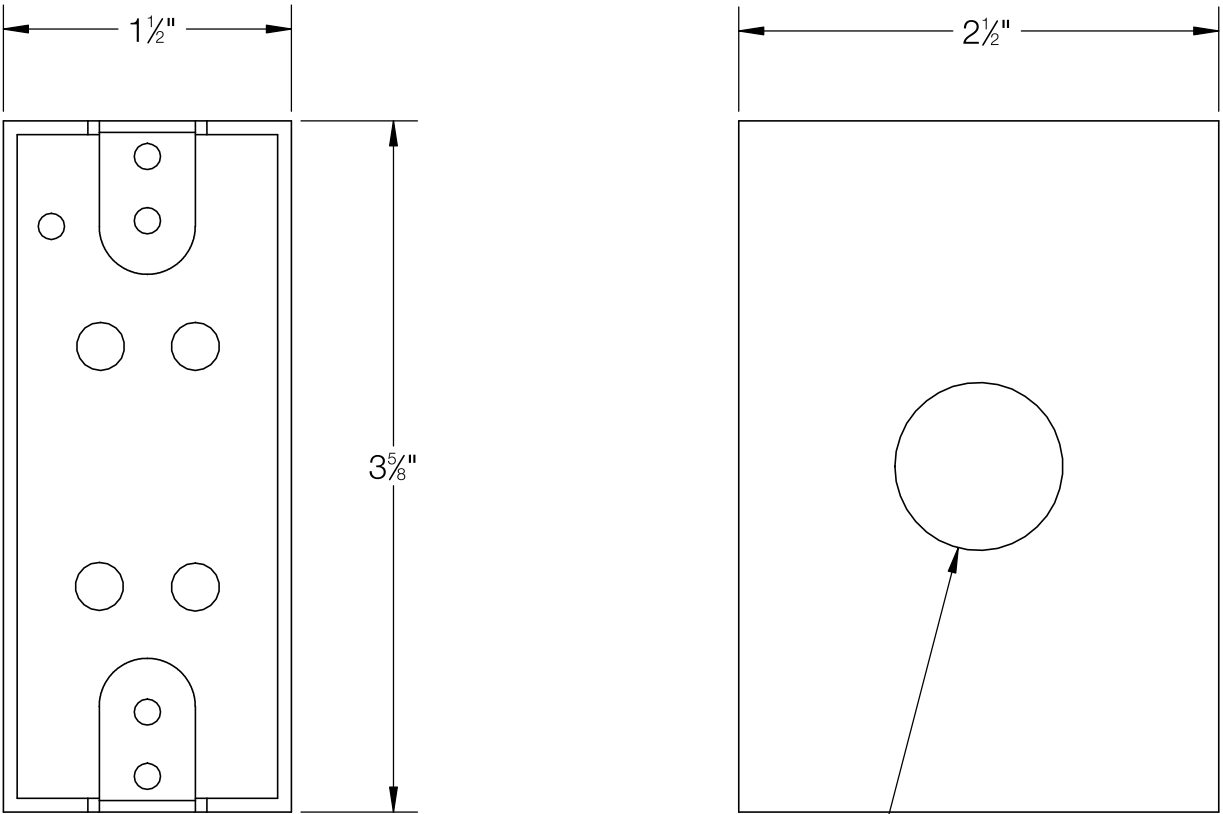

1/2" TRADE SIZE CONDUIT  
ENTRY (4 PLACES)

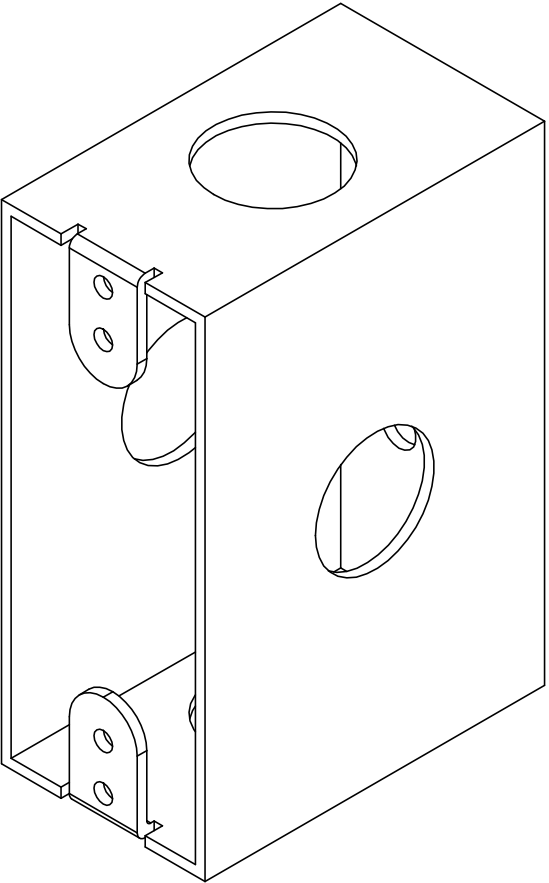

NOTE: SMALL OPENING LINEAR WIRING BOX REQUIRED FOR  
INSTALLATION

BEGA				
1000 BEGA Way, Carpinteria, California 93013			P (805) 684-0533 - <a href="http://www.bega-us.com">www.bega-us.com</a>	
APPROVED: _____		DATE: _____		DESCRIPTION: SMALL OPENING LINEAR WIRING BOX
TYPE: _____				
PROPRIETARY AND CONFIDENTIAL THE INFORMATION CONTAINED IN THIS DRAWING IS THE SOLE PROPERTY OF BEGA NORTH AMERICA, INC. ANY REPRODUCTION IN PART OR AS A WHOLE WITHOUT THE WRITTEN PERMISSION OF BEGA NORTH AMERICA, INC. IS PROHIBITED.		SIZE B	PART NO. 19542	REV -
		NOT TO SCALE	10/26/2023	SHEET 2 OF 2