

Tools Required:

3mm Hex Key
4mm Hex Key

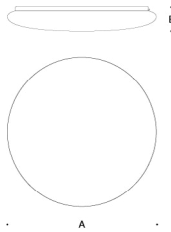

Dimensions

A: 51 1/8"
B: 6 5/8"



Weight: 75.84 lbs.

Notice to Installer for 24 731:

1. For ceiling or wall applications only.
2. Mounts directly to finished surface over standard recessed 4" octagonal wiring box (by others).
3. In conformance with UL Standard 1598, a silicone based sealant must be used between luminaire and supporting surface.
4. LEDs are high-quality electronic components! Please avoid touching the light output opening of the LED directly during installation.
5. **IMPORTANT:** The installation surface must have an adequate load-bearing capacity.

24 731 - Installation:

1. Remove mounting plate from back of luminaire by loosening (1) 3mm hex screw on side of the canopy, then turn the mounting plate counter-clockwise to remove from housing. **[Figure 1]**
2. Unhook each of the (4) steel cables from luminaire housing by unscrewing each 4mm hex head screw.
3. Route wires to wiring box and make supply and luminaire wiring connections inside wiring box:
MAIN VOLTAGE SUPPLY WIRE TO BLACK LUMINAIRE WIRE
NEUTRAL (COMMON) SUPPLY WIRE TO WHITE LUMINAIRE WIRE
GREEN GROUND WIRE TO GREEN LUMINAIRE WIRE
Dimming (if applicable):
DIMMING CONTROL WIRE (+) TO POSITIVE DRIVER DIM CONTROL WIRE
DIMMING CONTROL WIRE (-) TO NEGATIVE DRIVER DIM CONTROL WIRE
4. Install mounting plate onto finished surface using appropriate hardware (by others).
5. Place a small bead of silicone around the back side of the luminaire base in contact with the finished wall (exterior applications only).
6. Re-connect (4) steel cables by routing each through catch and tightening the 4mm hex screw to lock into place. **[Figure 3]**
7. To close luminaire, fit diffuser and frame over mounting plate and turn clockwise into the four guides. Ensure the gasket is seated properly.
8. Tighten (1) 3mm hex head screws to secure.

Figure 1: Open / Close Fixture

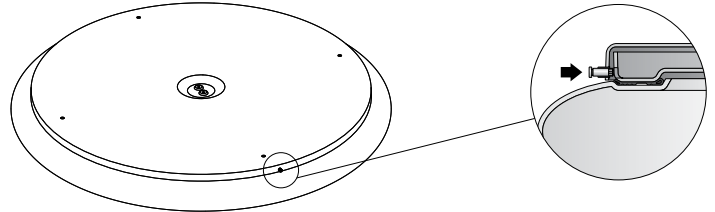

Figure 2: Mounting Plate

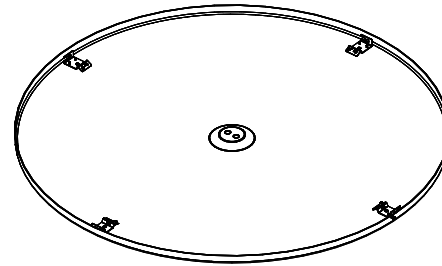
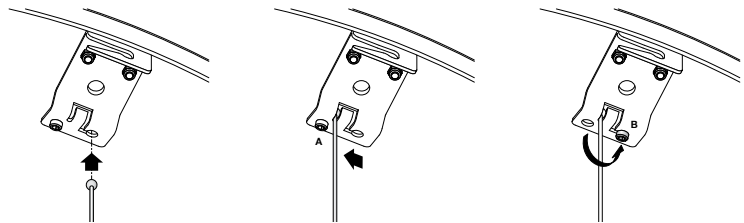

Figure 3: Steel Cable Detail



Relamping/Maintenance

Clean luminaire and lens using only solvent-free cleansers. No relamping required.

Accessories

Please refer to the appropriate accessory installation sheet for further instruction when applicable.

Replacement Parts

See label inside of fixture for LED replacement part number.

Consult factory for all other replacement components.

Lamp: 123.2W LED

Product Safety Warnings:

THIS PRODUCT MUST BE INSTALLED IN ACCORDANCE WITH THE APPLICABLE INSTALLATION CODE BY A PERSON FAMILIAR WITH THE CONSTRUCTION AND OPERATION OF THE PRODUCT AND THE HAZARDS INVOLVED. SUITABLE FOR WET LOCATIONS.

MIN 90°C SUPPLY CONDUCTORS.

CE PRODUIT DOIT ÊTRE INSTALLÉ SELON LE CODE D'INSTALLATION PERTINENT, PAR UNE PERSONNE QUI CONNAÎT BIEN LE PRODUIT ET SON FONCTIONNEMENT AINSI QUE LES RISQUES INHÉRENTS. CONVIENT AUX EMPLACEMENTS MOUILLÉS.

LES FILS D'ALIMENTATION 90°C MIN.
