

Tools Required:

- Phillips head screwdriver

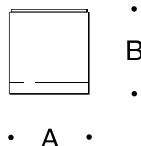

Dimensions

A: 7-3/8

B: 7-1/4

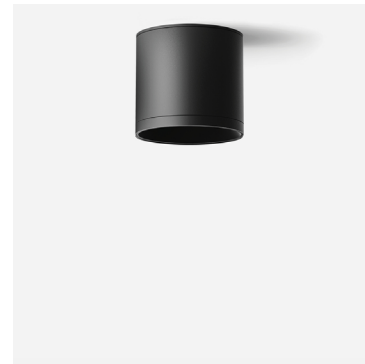

Overview:

LED Watts: 40.3W

System Watts: 46W

Controllability: 0-10V, TRIAC, and ELV dimmable

Weight: 6.2 lbs.

Protection Class: IP65

Notice to Installer:

1. BEGA luminaires may be damaged if connected to conduit systems containing water. Article 300-5G of National Electric Code requires that "Conduits or raceways through which moisture may contact energized live parts shall be sealed or plugged at either or both ends"
2. Fixture mounts to recessed 4" octagonal wiring box (by others) using KIT #3 (included).
3. In order to maintain wet location listing, fixture must be used with finished ceiling construction. Do not install in open ceilings, corrugated ceilings, exposed beams, or in any installation where the top of the fixture is exposed to the elements.
4. In conformance with U.L. Standards 1598, a silicone-based sealant **MUST** be used between the mounting plate edge and supporting wall.

WARNING: do not remove plastic cover (pictured in Figure 1) from face of luminaire until installation is fully complete. The Ultradark painted surfaces should not be handled directly if possible to avoid damage to the structural coating. If touching is unavoidable, use powder free latex/nitrile gloves.

B24750 Installation:

1. Detach mounting plate from fixture by turning fixture counter-clockwise.
2. Disconnect the quick-connect between the LED and driver.
3. Fasten KIT #3 with mounting plate to 4" octagonal wiring box (by others). Figure 1.
4. Make supply wiring and LED driver connections in wiring box:
MAIN VOLTAGE SUPPLY WIRE TO BLACK LED DRIVER WIRE
NEUTRAL (COMMON) SUPPLY WIRE TO WHITE LED DRIVER WIRE
GREEN GROUND WIRE TO GREEN LUMINAIRE WIRE
0-10V Dimming (if applicable):
DIMMING CONTROL WIRE (+) TO POSITIVE DRIVER DIM CONTROL WIRE
DIMMING CONTROL WIRE (-) TO NEGATIVE DRIVER DIM CONTROL WIRE
5. Use included mounting hardware to attach the mounting plate to KIT #3 using phillips head screwdriver.
6. Place a small bead of silicone between the mounting plate and the finished surface (exterior applications only).
7. Connect quick connect between LED and driver and replace fixture over mounting plate. Turn clockwise to lock into place. Use caution and watch for pinched wires.
8. Once fixture is fully installed, remove plastic cover, taking care not to touch Ultradark coating.

NOTE: It is highly recommended that the plastic cover remains in place until construction is complete to protect the Ultradark surface from excess dust and debris common with active construction environments.

Figure 1:

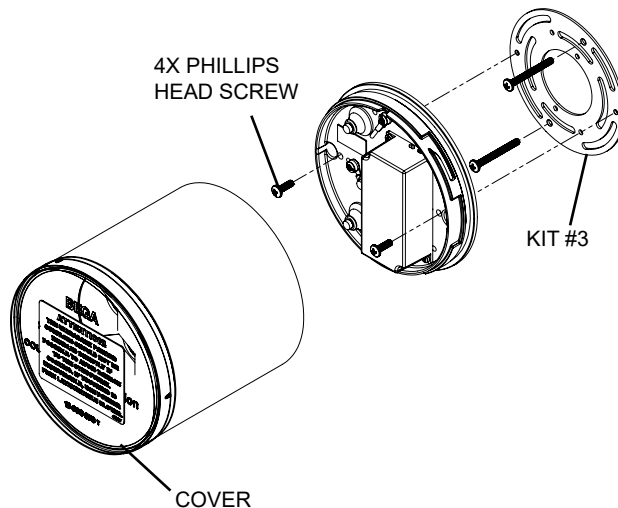

Accessories

Please refer to the appropriate accessory installation sheet for further instruction when applicable.

Maintenance:

Contact with the inner surface of the luminaire reflector should be avoided in order to protect the light absorbing properties of the ultra-black coating.

Replacement Parts

See label inside of fixture for LED replacement part number.

Consult factory for all other replacement components.

Product Safety Warnings:

THIS PRODUCT MUST BE INSTALLED IN ACCORDANCE WITH THE APPLICABLE INSTALLATION CODE BY A PERSON FAMILIAR WITH THE CONSTRUCTION AND OPERATION OF THE PRODUCT AND THE HAZARDS INVOLVED.
SUITABLE FOR WET LOCATIONS.
SUITABLE FOR MOUNTING WITHIN 1.2 m (4 ft) OF THE GROUND
MIN 60°C SUPPLY CONDUCTORS.

CE PRODUIT DOIT ÊTRE INSTALLÉ SELON LE CODE D'INSTALLATION PERTINENT, PAR UNE PERSONNE QUI CONNAÎT BIEN LE PRODUIT ET SON FONCTIONNEMENT AINSI QUE LES RISQUES INHÉRENTS.
CONVIENT AUX EMPLACEMENTS MOUILLÉS.
PEUT ÊTRE INSTALLÉ À MOINS DE 1,2 m (4 pi) DU SOL
LES FILS D'ALIMENTATION 60°C MIN.