

Tools Required:

- 2.5mm hex head screwdriver
- 3mm hex head screwdriver

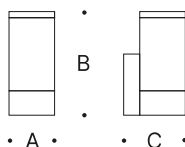

Dimensions

A: 4 3/8"

B: 9 3/4"

C: 6"

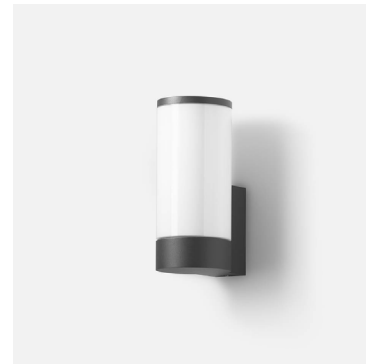

Overview:

LED Watts: 4.7W
System Watts: 7.4W
Controllability: 0-10V dimmable
Weight: 3.8 lbs.
Protection Class: IP65

Notice to Installer:

1. BEGA luminaires may be damaged if connected to conduit systems containing water. Article 300-5G of National Electric Code requires that "Conduits or raceways through which moisture may contact energized live parts shall be sealed or plugged at either or both ends."
2. See page 2 for specific product safety warnings.
3. Mounts directly to BEGA 19542 small opening linear wiring box (included) using KIT #107 (included); see Figure 1. The wiring box needs to be recessed into the wall and must be flush with the finished surface.
4. In conformance with U.L. Standards 1598, a silicone-based sealant **MUST** be used between the back casting edge and supporting wall.

WARNING: LEDs are high-quality electronic components! Please avoid touching the light output opening of the LED directly during installation.

Figure 1:

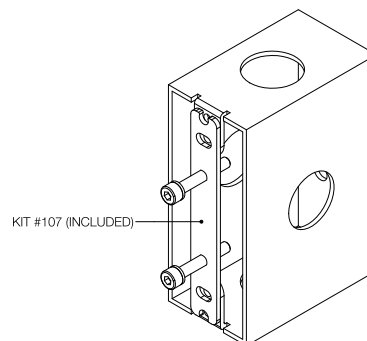

Installation: 19542 Wiring Box

1. Hollow (stud) wall construction - Secure wiring box to wood or metal vertical blocking. Connect conduit to wiring box (if needed) and pull wires for electrical connections to be made later.
2. Poured concrete construction - Attach wiring box to the concrete form. Connect conduit to wiring box (if needed) and pull wires for electrical connections to be made later. Pour concrete and remove form.

IMPORTANT: Do not pour concrete directly on to box.

Figure 2:

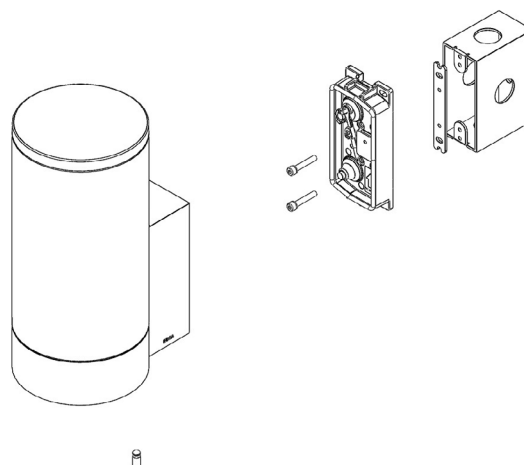

Installation: 24 849

1. Attach KIT #107 to the recessed junction box using hardware by others.
2. Make supply wiring and luminaire wiring connections inside the recessed junction box:
SUPPLY WIRING CONNECTIONS:
- MAIN VOLTAGE (HOT) SUPPLY WIRE TO BLACK DRIVER WIRE
- NEUTRAL (COMMON) SUPPLY WIRE TO WHITE DRIVER WIRE
- GREEN (GROUND) WIRE TO GREEN DRIVER WIRE
0-10V DIMMING (IF APPLICABLE):
- DIM CONTROL (+) TO POSITIVE DRIVER DIM CONTROL WIRE
- DIM CONTROL (-) TO NEGATIVE DRIVER DIM CONTROL WIRE
3. Loosen 2.5mm hex head set screw on the underside of the mounting base and remove mounting plate. Attach the mounting plate to KIT #107 using the (2) provided 3mm hex head screws.
4. Place the front luminaire housing over the secured mounting plate and fasten the 2.5mm hex head set screw at the bottom of the mounting base. Ensure the gasket is properly positioned between the mounting base and mounting plate.
5. For exterior installations, apply a small bead of silicone around the luminaire back casting and supporting wall.

Accessories

Please refer to the appropriate accessory installation sheet for further instruction when applicable.

Maintenance:

Clean regularly with solvent-free cleaner removing dirt and debris. Do not use high pressure cleaners.

Replacement Parts

See label inside of fixture for LED replacement part number.

Consult factory for all other replacement components.

Product Safety Warnings:

THIS PRODUCT MUST BE INSTALLED IN ACCORDANCE WITH THE APPLICABLE INSTALLATION CODE BY A PERSON FAMILIAR WITH THE CONSTRUCTION AND OPERATION OF THE PRODUCT AND THE HAZARDS INVOLVED.
SUITABLE FOR WET LOCATIONS.
MIN 60°C SUPPLY CONDUCTORS.
SUITABLE FOR MOUNTING WITHIN 1.2m (4 ft) OF THE GROUND.
WALL MOUNT ONLY.

CE PRODUIT DOIT ÊTRE INSTALLÉ SELON LE CODE D'INSTALLATION PERTINENT, PAR UNE PERSONNE QUI CONNAÎT BIEN LE PRODUIT ET SON FONCTIONNEMENT AINSI QUE LES RISQUES INHÉRENTS.
CONVIENT AUX EMPLACEMENTS MOUILLES.
LES FILS D'ALIMENTATION 60°C MIN.
PUET ÊTRE INSTALLÉ À MOINS DE 1,2m (4 pi) DU SOL.
INSTALLATION MURALE SEULEMENT.