

Tools Required:

- 3mm hex key
- Phillips medium screwdriver

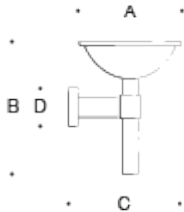

Dimensions

- A: 14 "
- B: 18-1/8 "
- C: 15-1/2 "
- D: 5-1/8 "



Protection Class: IP44

Weight: 20.9 lbs.

Notice to Installer for 31 190:

1. See page 2 for specific product safety warnings.
2. For wall applications only.
3. Mounts directly to a standard recessed 4" octagonal wiring box (by others).
4. This product must be installed in accordance with the applicable installation code by a person familiar with the construction and operation of the product and the hazards involved.
5. In conformance with UL Standard 1598, a silicone based sealant must be used between luminaire and supporting wall.

NOTE: LEDs are high-quality electronic components! Please avoid touching them directly during installation.

NOTE: To avoid fingerprints on the luminaire use enclosed protective gloves during installation. This luminaire is made of copper and bronze and is delivered with the metal's natural finish. Time and weather factors will create a natural patina on the copper and bronze.

31 190 - Installation:

1. Undo set screw at wall box and remove mounting plate.
 2. Attach mounting plate to wiring box (by others). Feed luminaire wires through mounting plate.
 3. Make supply wiring connections inside the linear wiring box:
MAIN VOLTAGE SUPPLY WIRE TO BLACK LUMINAIRE WIRE
NEUTRAL (COMMON) SUPPLY WIRE TO WHITE LUMINAIRE WIRE
GREEN GROUND WIRE TO GREEN LUMINAIRE WIRE
- Dimming (if applicable):**
DIMMING CONTROL WIRE (+) TO POSITIVE DRIVER DIM CONTROL WIRE
DIMMING CONTROL WIRE (-) TO NEGATIVE DRIVER DIM CONTROL WIRE
4. Place a small bead of silicone around the back side of the luminaire base that will come in contact with the finished wall (exterior applications only).
 5. Mount luminaire over mounting plate and tighten set screw to secure.

Figure 1 (Generic image)

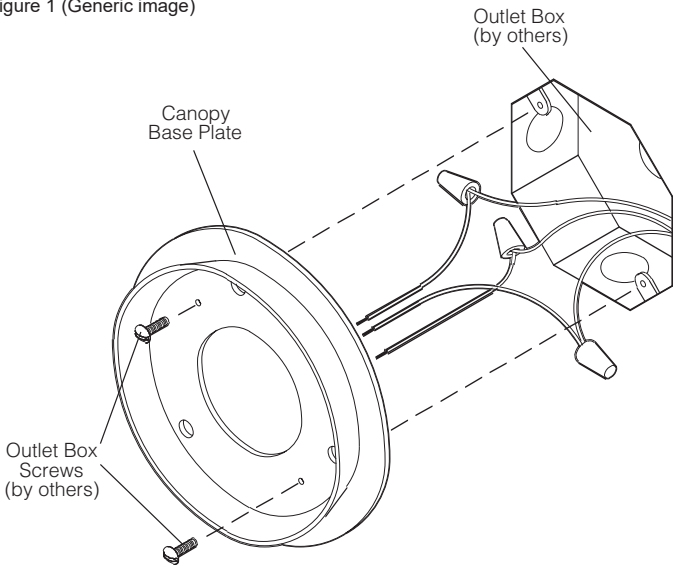

Relamping/Maintenance

No relamping necessary.

Accessories

Please refer to the appropriate accessory installation sheet for further instruction when applicable.

Replacement Parts

Description	Part No
Glass	140612
Gasket	831050
LED Module (3000K)	LED-0281/830A
LED Driver (120-277V)	75940

Lamp: 17.8W LED

In the interest of product improvement, BEGA reserves the right to make technical changes without notice.

Product Safety Warnings:

THIS PRODUCT MUST BE INSTALLED IN ACCORDANCE WITH THE APPLICABLE INSTALLATION CODE BY A PERSON FAMILIAR WITH THE CONSTRUCTION AND OPERATION OF THE PRODUCT AND THE HAZARDS INVOLVED. SUITABLE FOR WET LOCATIONS.

MIN 90°C SUPPLY CONDUCTORS.

CE PRODUIT DOIT ÊTRE INSTALLÉ SELON LE CODE D'INSTALLATION PERTINENT, PAR UNE PERSONNE QUI CONNAÎT BIEN LE PRODUIT ET SON FONCTIONNEMENT AINSI QUE LES RISQUES INHÉRENTS. CONVIENT AUX EMPLACEMENTS MOUILLÉS.

LES FILS D'ALIMENTATION 90°C MIN.
