

Application

Recessed wall luminaires with asymmetric light distribution ideal for the glare-free illumination of ground surfaces, building entrances, stairs and footpaths.

Materials

- Clear safety glass with optical texture
- Corrosion-resistant 304 grade stainless steel
- High temperature silicone gasket
- Mechanically captive stainless steel fasteners
- Aluminum installation housing
- Pure anodized aluminum reflector surface

NRTL listed to North American Standards, suitable for wet locations
Protection class IP 65

Weight: 2.2 lbs.

Electrical

Operating voltage	120-277VAC
Minimum start temperature	-30° C
LED module wattage	3.0W
System wattage	6.2W
Controllability	0-10V dimmable
Color rendering index	Ra > 80
Luminaire lumens	221 lm
LED service life (L70)	60000hrs

LED color temperature

- 4000K (K4)
- 3500K (K35)
- 3000K (K3)
- 2700K (K27)

BEGA can supply you with suitable LED replacement modules for up to 20 years after the purchase of LED luminaires - see website for details

Finish

#4 brushed stainless steel. Custom colors are not available.

Type:
BEGA Product:
Project:
Modified:

Included (available for pre-shipment)
BB3020LED Installation housing

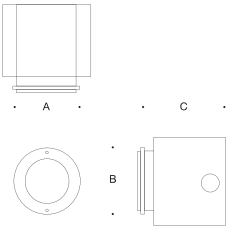

Recessed wall luminaire · Asymmetric				
		LED	A	B
B33020	ADA	3.0W	6	4 ³ / ₄

