

Tools Required:

Philips medium screwdriver
5mm hex key
Adjustable wrench

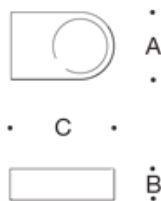

Dimensions

A: 5-1/2 "
B: 2-3/8 "
C: 7-3/8 "



Protection Class: IP65

Weight: 3.1 lbs.

Notice to Installer for 33 224:

1. See page 2 for specific product safety warnings.
2. For attachment to wall over separate small opening linear wiring box (19 543 provided by BEGA).
3. Wiring box needs to be recessed into wall and must be flush with the finished surface.
4. In conformance with UL Standard 1598, a silicone based sealant **MUST** be used between luminaire and supporting wall.
5. **WARNING:** LEDs are high quality electrical components. Please avoid touching them directly during installation.

19 543 - wiring box installation:

Hollow (stud) wall construction - Secure wiring box to wood or metal horizontal blocking as shown in Fig 1. Connect conduit to wiring box (if needed) and pull wires for electrical connections to be made later.

Poured concrete construction - Attach wiring box to the concrete form. Connect conduit to wiring box (if needed) and pull wires for electrical connections to be made later. Pour concrete and remove form.

IMPORTANT: Do not pour concrete directly on to box!

33 224 - luminaire installation:

1. Loosen (2) 5mm set screws and remove luminaire main casting off of luminaire base.
2. Feed luminaire wires through rear opening of luminaire and through luminaire base wireway hole.
3. Make supply wiring and luminaire wiring connections inside the small opening linear wiring box:
 - MAIN VOLTAGE SUPPLY WIRE TO BLACK LUMINAIRE WIRE
 - NEUTRAL (COMMON) SUPPLY WIRE TO WHITE LUMINAIRE WIRE
 - GREEN GROUND WIRE TO GREEN LUMINAIRE WIRE.

Dimming (if applicable):

 - DIMMING CONTROL WIRE (+) TO POSITIVE DRIVER DIM CONTROL WIRE
 - DIMMING CONTROL WIRE (-) TO NEGATIVE DRIVER DIM CONTROL WIRE
4. Attach and secure luminaire base to wall using hardware by others (minimum screw size 8-32 screws).
5. Mount luminaire to luminaire base using (2) 5mm hex screws. Tighten screws evenly.

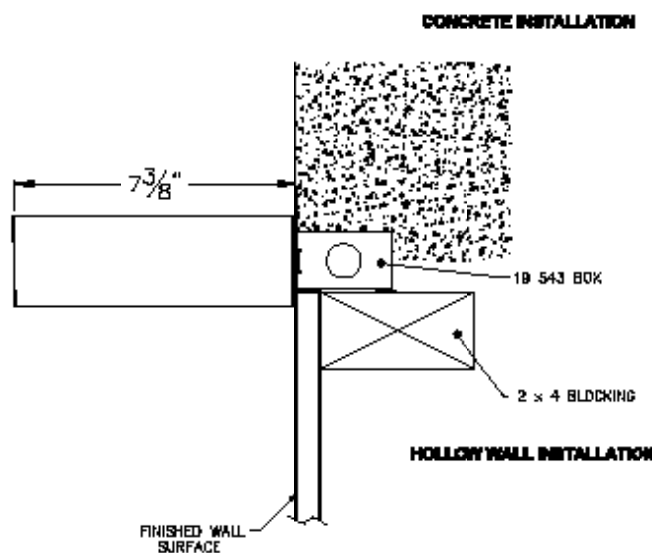

Relamping/Maintenance

No relamping necessary.

Accessories

Please refer to the appropriate accessory installation sheet for further instruction when applicable.

Wiring Box 19 543

Replacement Parts

Description	Part No
Face Plate	FP3224
Driver (120-277V)	76066
LED Module (3000K)	LED-0265/930
LED Module (4000K)	LED-0265/940

Lamp: 3.9W LED

Product Safety Warnings:

THIS PRODUCT MUST BE INSTALLED IN ACCORDANCE WITH THE APPLICABLE INSTALLATION CODE BY A PERSON FAMILIAR WITH THE CONSTRUCTION AND OPERATION OF THE PRODUCT AND THE HAZARDS INVOLVED. SUITABLE FOR WET LOCATIONS.

MIN 90°C SUPPLY CONDUCTORS.

CE PRODUIT DOIT ÊTRE INSTALLÉ SELON LE CODE D'INSTALLATION PERTINENT, PAR UNE PERSONNE QUI CONNAÎT BIEN LE PRODUIT ET SON FONCTIONNEMENT AINSI QUE LES RISQUES INHÉRENTS. CONVIENT AUX EMPLACEMENTS MOUILLES.

LES FILS D'ALIMENTATION 90°C MIN.
