

Tools Required:

- 4mm hex key
- 11/32" Nut driver
- Philips medium screwdriver

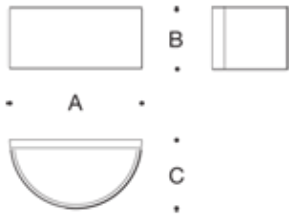

Dimensions

- A: 9-7/8 "
- B: 4-5/8 "
- C: 5-3/8 "



Protection Class: IP65

Weight: 4.9 lbs.

Notice to Installer for 33 334:

1. Mounts directly to a standard octagonal 4" wiring box (by others) using mounting kit (supplied).
2. In conformance with UL Standard 1598, a silicone based sealant must be used between luminaire and supporting wall.

Figure 1 - Generic Image

33 334 - installation:

1. Loosen (2) 4mm hex screws on front luminaire cover and remove cover, lens, and lens gasket.
2. Feed luminaire wires through fixture base, and center hole in mounting strap.
3. Make supply wiring and luminaire wiring connections inside the octagonal wiring box:

MAIN VOLTAGE SUPPLY WIRE TO BLACK LUMINAIRE WIRE
NEUTRAL (COMMON) SUPPLY WIRE TO WHITE LUMINAIRE WIRE
GREEN GROUND WIRE TO GREEN LUMINAIRE WIRE

Dimming (if applicable):

DIMMING CONTROL WIRE (+) TO POSITIVE DRIVER DIM CONTROL WIRE
DIMMING CONTROL WIRE (-) TO NEGATIVE DRIVER DIM CONTROL WIRE

4. Attach mounting plate (provided) to wiring box using outlet box screws (by others).
5. Replace lens and gasket. Install cover and tighten (2) hex screws to secure, making sure that the gasket is seated properly.

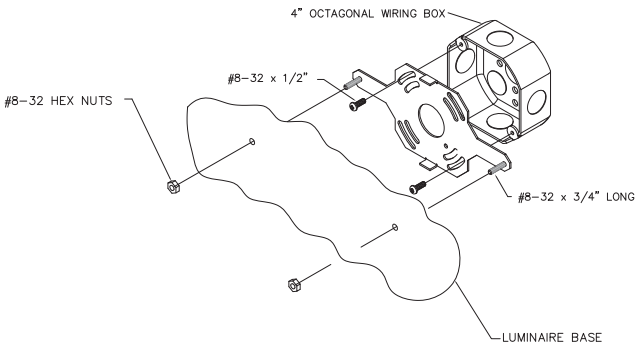

Relamping/Maintenance

Loosen screws and remove cover and lens. Clean luminaire and lens using only solvent-free cleansers. Replace guard and tighten screws evenly, making sure that the gasket is seated properly.

Accessories

Please refer to the appropriate accessory installation sheet for further instruction when applicable.

Replacement Parts

Description	Part No
Lens	11276611
Lens gasket	831221
Driver (120-277V)	76066
LED Module (3000K)	LED-0263/830
LED Module (4000K)	LED-0263/840

Lamp: 3.9W LED

In the interest of product improvement, BEGA reserves the right to make technical changes without notice.

Product Safety Warnings:

THIS PRODUCT MUST BE INSTALLED IN ACCORDANCE WITH THE APPLICABLE INSTALLATION CODE BY A PERSON FAMILIAR WITH THE CONSTRUCTION AND OPERATION OF THE PRODUCT AND THE HAZARDS INVOLVED. SUITABLE FOR WET LOCATIONS.

MIN 90°C SUPPLY CONDUCTORS.

CE PRODUIT DOIT ÊTRE INSTALLÉ SELON LE CODE D'INSTALLATION PERTINENT, PAR UNE PERSONNE QUI CONNAÎT BIEN LE PRODUIT ET SON FONCTIONNEMENT AINSI QUE LES RISQUES INHÉRENTS. CONVIENT AUX EMPLACEMENTS MOUILLÉS.

LES FILS D'ALIMENTATION 90°C MIN.
