

**Tools Required:**

- 3mm hex head screwdriver
- 4mm hex head screwdriver
- Phillips head screwdriver

**Overview:**

LED Watts: 3.0W  
 System Watts: 7.0W  
 Controllability: 0-10V dimmable  
 Weight: 1.1 lbs.  
 Protection Class: IP65

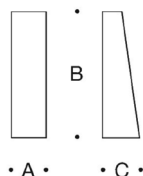

**Dimensions**

**A:** 2-1/8"

**B:** 7-7/8"

**C:** 2-3/8"



**Notice to Installer:**

1. See page 2 for specific product safety warnings.
2. BEGA luminaires may be damaged if connected to conduit systems containing water - Article 300-5G of National Electric Code requires that "Conduits or raceways through which moisture may contact energized live parts shall be sealed or plugged at either or both ends"
3. Suitable for wall applications only. (No ceiling or in-grade applications).
4. Mounts directly to BEGA-provided 19545 wiring box.
5. **Warning: LEDs are high-quality electronic components! Please avoid touching the light output opening of the LED directly during installation.**

**B19545 installation in hollow (stud) wall or masonry construction:**

1. Secure 19545 wiring box to wood or metal horizontal blocking using hardware (by others).
2. Adjust the wiring box so that the front face of the wiring box will be flush with the finished wall surface after installation.
3. Connect conduit to wiring box and pull wires for electrical connections to be made later.
4. Finish wall.

**B19545 installation in poured concrete construction:**

1. Attach installation housing to the concrete form.
2. Connect conduit to wiring box and pull wires for electrical connections to be made later.
3. Attach the wiring box to concrete forms. Ensure that the front face of the wiring box will be flush with the finished surface.
4. Pour concrete. Do not pump or drop concrete directly on top of the wiring box. Doing so could deform or damage the wiring box.
5. After concrete has cured, remove the forms.

**33514 luminaire installation:**

1. Remove the (1) 2.5mm hex screw on the faceplate of the fixture and remove it.
2. Feed luminaire wires through rubber grommet in mounting base.
3. Make wiring connections:  
 MAIN VOLTAGE SUPPLY WIRE TO BLACK DRIVER WIRE  
 NEUTRAL (COMMON) SUPPLY WIRE TO WHITE DRIVER WIRE  
 GREEN GROUND WIRE TO GREEN DRIVER WIRE  
 Dimming (if applicable):  
 DIMMING CONTROL WIRE (+) TO POSITIVE DRIVER DIM CONTROL WIRE  
 DIMMING CONTROL WIRE (-) TO NEGATIVE DRIVER DIM CONTROL WIRE
4. Place a small bead of silicone around the back side of the luminaire mounting base that will come in contact with the finished surface (exterior applications only). Mount luminaire base directly to the wall surface, referring to Figure 2 for mounting hole layout.
5. Attach luminaire base to wall box and secure using (2) M3 screws, ensuring that orientation labels on the luminaire base correspond to mounting direction.
6. Replace fixture faceplate and tighten (1) 4mm hex screw to secure, ensuring that the gasket is sealed correctly.

**Figure 1: Mounting**

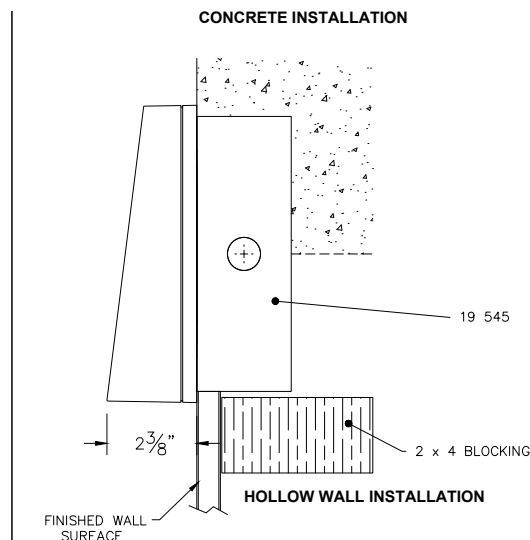

**Figure 2: Wiring box hole pattern**



**Accessories**

Please refer to the appropriate accessory installation sheet for further instruction when applicable.

**Maintenance:**

Clean regularly with solvent-free cleaner removing dirt and debris. Do not use high pressure cleaners.

**Replacement Parts**

See label inside of fixture for LED replacement part number.

Consult factory for all other replacement components.

**Product Safety Warnings:**

**THIS PRODUCT MUST BE INSTALLED IN ACCORDANCE WITH THE APPLICABLE INSTALLATION CODE BY A PERSON FAMILIAR WITH THE CONSTRUCTION AND OPERATION OF THE PRODUCT AND THE HAZARDS INVOLVED.**  
**SUITABLE FOR WET LOCATIONS.**  
**SUITABLE FOR MOUNTING WITHIN 1.2m (4ft) OF THE GROUND**  
**WALL MOUNT ONLY**

**MIN 60°C SUPPLY CONDUCTORS.**

**CE PRODUIT DOIT ÊTRE INSTALLÉ SELON LE CODE D'INSTALLATION PERTINENT, PAR UNE PERSONNE QUI CONNAÎT BIEN LE PRODUIT ET SON FONCTIONNEMENT AINSI QUE LES RISQUES INHÉRENTS.**  
**CONVIENT AUX EMPLACEMENTS MOUILLÉS.**  
**PEUT ÊTRE INSTALLÉ À MOINS DE 1,2 m (4 pi) DU SOL**  
**INSTALLATION MURALE SEULEMENT**

**LES FILS D'ALIMENTATION 60°C MIN.**