

**Tools Required:**

- Medium flathead screwdriver
- Medium Phillips-head screwdriver
- 1.5mm Hex key
- 8mm socket wrench

**Overview:**

LED Watts: 67.2W  
 System Watts: 83.0W  
 Controllability: 0-10V dimmable down to 0.1%  
 Weight: 24.5 lbs.

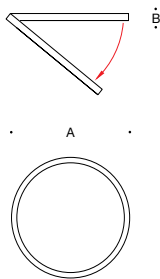

**Dimensions**

A: 19-5/8"

B: 3"

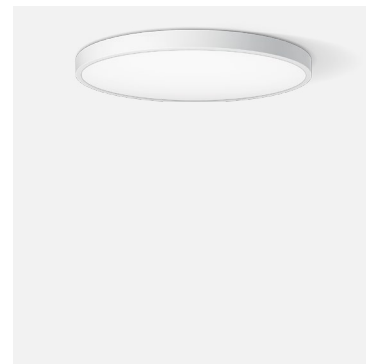

**Notice to Installer:**

1. Surface ceiling or surface wall applications only.
2. Wiring connections made inside fixture or within standard wiring box.
3. LEDs are high-quality electronic components! Please avoid touching LED directly during installation.
4. IMPORTANT: The installation surface must have an adequate load-bearing capacity.
5. When installing the luminaire please consider sufficient load capacity of ceiling or wall

**24 230 - Installation:**

1. Use a 1.5mm hex key to open the mounting bracket on the luminaire trim with a quarter turn to the left. [Figure 1]
2. Open the mounting bracket fully by slightly tilting the torsion spring back till completely removed from hook. [Figure 2] [Figure 3]
3. Raise the mounting bracket carefully and disconnect the LED connector.
4. Unscrew the 3 nuts above the hinge until the end of thread using a 8mm socket wrench. [Figure 4]
5. Pull the safety clamp forward and take off the mounting bracket upwards. [Figure 5]
6. Note position of application "arrow down" when installed at the wall; the safety clamp has to show to the top!
7. Fix mounting bracket with hardware (by others) onto the mounting surface.
8. Make connections from driver to supply wiring:  
 MAIN VOLTAGE SUPPLY WIRE TO BLACK DRIVER WIRE(S);  
 NEUTRAL (COMMON SUPPLY WIRE TO WHITE DRIVER WIRE(S);  
 GREEN GROUND WIRE TO GREEN DRIVER WIRE(S).  
 Dimming (if applicable):  
 DIMMING CONTROL WIRE (+) TO POSITIVE DRIVER DIM CONTROL WIRE  
 DIMMING CONTROL WIRE (-) TO NEGATIVE DRIVER DIM CONTROL WIRE
9. Pick up the luminaire and insert the hinge laterally to the arrester. [Figure 6]
10. Screw the three hex-nuts sitings above the hinge tightly - torque 3.4 Nm. [Figure 6]
11. **Attention:**  
 The luminaire is only then securely attached to the mounting bracket when all three nuts are tightened!
12. Reconnect the LED plug connectors to the left and right of the mounting bracket.
13. Close luminaire till the spring arrester has hooked onto mounting bracket.
14. Insert an 1.5mm Hex wrench into the locking system at the luminaire trim and turn it against the spring resistance to the left.
15. Press the luminaire into the final position and tighten the set screw using a 1.5mm hex key to properly locked in the initial position. [Figure 7]

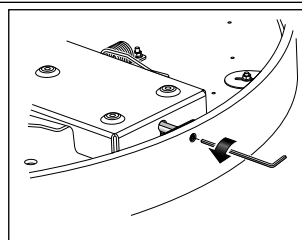

Figure 1: Mounting Bracket Set Screw

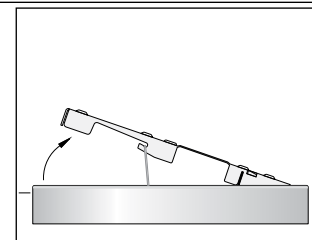

Figure 2: Canopy Removal

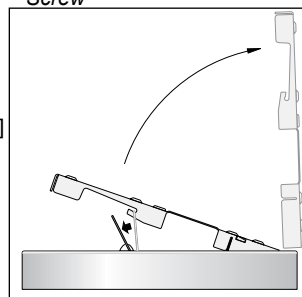

Figure 3: Torsion Spring

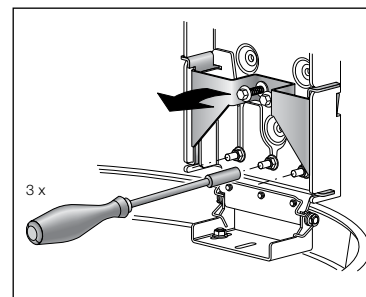

Figure 4: Canopy Removal

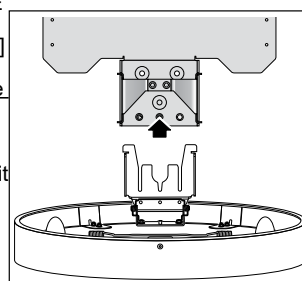

Figure 5: Canopy Removal

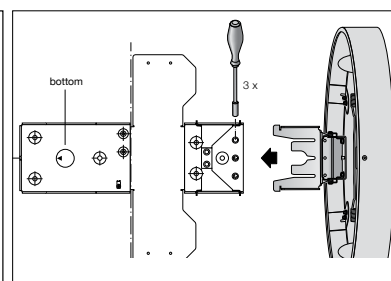

Figure 6: Canopy Closure

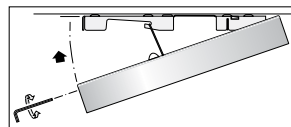

Figure 7: Canopy Closure

**Accessories**

Please refer to the appropriate accessory installation sheet for further instruction when applicable.

**Maintenance:**

Clean regularly with solvent-free cleaner removing dirt and debris. Do not use high pressure cleaners.

**Replacement Parts**

See label inside of fixture for LED replacement part number.

Consult factory for all other replacement components.

**Product Safety Warnings:**

**THIS PRODUCT MUST BE INSTALLED IN ACCORDANCE WITH THE APPLICABLE INSTALLATION CODE BY A PERSON FAMILIAR WITH THE CONSTRUCTION AND OPERATION OF THE PRODUCT AND THE HAZARDS INVOLVED. SUITABLE FOR DAMP LOCATIONS. MIN 90°C SUPPLY CONDUCTORS.**

**CE PRODUIT DOIT ÊTRE INSTALLÉ SELON LE CODE D'INSTALLATION PERTINENT, PAR UNE PERSONNE QUI CONNAÎT BIEN LE PRODUIT ET SON FONCTIONNEMENT AINSI QUE LES RISQUES INHÉRENTS. CONVIENT AUX EMPLACEMENTS HUMIDE.**

**LES FILS D'ALIMENTATION 90°C MIN.**