

Tools Required:

- 3mm Hex Head Screwdriver
- Medium Phillips Head Screwdriver
- 5/16" Socket Wrench

Overview:

LED Watts: 17.8W
 System Watts: 22.0W
 Controllability: Triac, ELV, 0-10V dimmable
 Weight: 3.5 lbs.

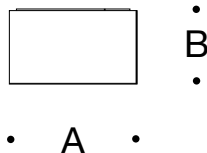

Dimensions

A: 5-1/8"

B: 4"

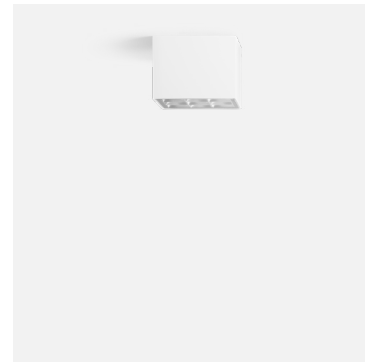

Notice to Installer:

1. See page 2 for specific product safety warnings.
2. Mounts to the ceiling directly to recessed standard 4" octagonal junction box using mounting kit (provided).
3. LEDs are high-quality electronic components! Please avoid touching the light output opening of the LED directly during installation.

Installation:

1. Remove luminaire base by loosening (2) 3mm set screws on luminaire housing.
2. Attach mounting kit adapter plate to recessed standard 4" octagonal junction box using (2) 8-32 x 1/2" screws (provided). Feed luminaire wires through luminaire base and adapter plate. See Figure 1 reference.
3. Make supply wiring and luminaire wiring connections inside the junction box:
 MAIN VOLTAGE SUPPLY WIRE TO BLACK LUMINAIRE WIRE
 NEUTRAL (COMMON) SUPPLY WIRE TO WHITE LUMINAIRE WIRE
 GREEN GROUND WIRE TO GREEN LUMINAIRE WIRE
 Dimming (if applicable):
 DIMMING CONTROL WIRE (+) TO POSITIVE DRIVER PURPLE DIM CONTROL WIRE
 DIMMING CONTROL WIRE (-) TO NEGATIVE DRIVER GRAY DIM CONTROL WIRE
4. Attach luminaire base to adapter plate over the mounting studs using the 5/16" hex nuts provided in mounting kit.
5. Attach luminaire housing to base by tightening (2) 3mm on luminaire housing.

Figure 1:

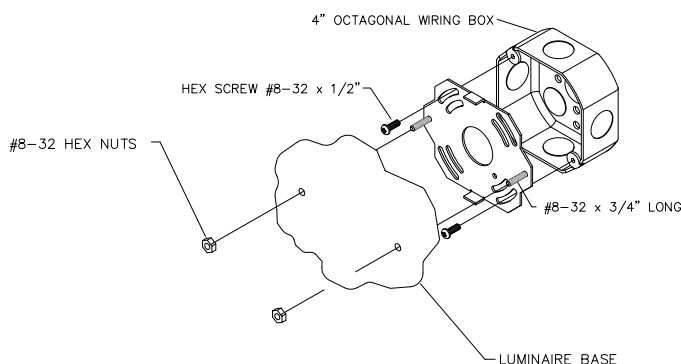

Accessories

Please refer to the appropriate accessory installation sheet for further instruction when applicable.

Maintenance:

Clean regularly with solvent-free cleaner removing dust and debris.

Replacement Parts

See label inside of fixture for LED replacement part number.

Consult factory for all other replacement components.

Product Safety Warnings:

THIS PRODUCT MUST BE INSTALLED IN ACCORDANCE WITH THE APPLICABLE INSTALLATION CODE BY A PERSON FAMILIAR WITH THE CONSTRUCTION AND OPERATION OF THE PRODUCT AND THE HAZARDS INVOLVED. SUITABLE FOR DAMP LOCATIONS. MIN 90°C SUPPLY CONDUCTORS.

CE PRODUIT DOIT ÊTRE INSTALLÉ SELON LE CODE D'INSTALLATION PERTINENT, PAR UNE PERSONNE QUI CONNAÎT BIEN LE PRODUIT ET SON FONCTIONNEMENT AINSI QUE LES RISQUES INHÉRENTS. CONVIENT AUX EMPLACEMENTS HUMIDE.

LES FILS D'ALIMENTATION 90°C MIN.