

Tools Required:

- Philips medium screwdriver
- 7/16" wrench
- Adjustable Wrench



• B •

Dimensions

A: 7 1/2"

B: 6 3/8"

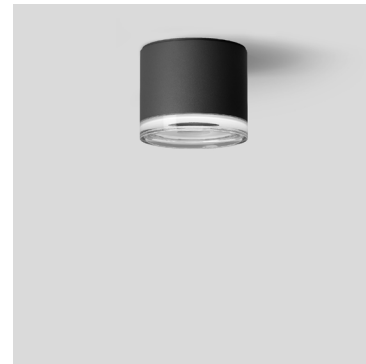

Overview:

System Watts: 22 W

LED Watts: 15.7 W

Controllability: 0-10V, TRIAC, and ELV dimmable to 1%

Weight: 7.1 lbs.

Protection Class: IP65

Notice to Installer:

1. **BEGA luminaires may be damaged if connected to conduit systems containing water- Article 300-5G of National Electric Code requires that "Conduits or raceways through which moisture may contact energized live parts shall be sealed or plugged at either or both ends".**
2. Mounts directly to a standard octagonal 4" wiring box (by others) using mounting kit (supplied).
3. In conformance with U.L. Standards 1598, a silicone-based sealant **MUST** be used between the mounting plate edge and supporting wall.
4. LEDs are high-quality electronic components! Please avoid touching the light output opening of the LED directly during installation.

Installation:

1. Unscrew glass lens from luminaire housing to disassemble.
2. Make supply wiring and luminaire wiring connections inside the octagonal wiring box:
MAIN VOLTAGE SUPPLY WIRE TO BLACK LUMINAIRE WIRE
NEUTRAL (COMMON) SUPPLY WIRE TO WHITE LUMINAIRE WIRE
GREEN GROUND WIRE TO GREEN LUMINAIRE WIRE
3. **0-10V Dimming (if applicable):**
DIMMING CONTROL WIRE (+) TO POSITIVE DRIVER DIM CONTROL WIRE
DIMMING CONTROL WIRE (-) TO NEGATIVE DRIVER DIM CONTROL WIRE
3. Feed luminaire wires through fixture mounting base, IP nipple (provided), and center hole in mounting strap.
4. Attach mounting strap (provided) to wiring box using outlet box screws (supplied by others).
5. Attach 1/4" nipple to mounting strap and place luminaire over nipple.
6. Use provided washer and lock nut to secure the fixture to the IPS nipple. Screw until tight and secure.
7. Screw glass lens onto luminaire housing, making sure the gasket is sealed properly.

Figure 1:

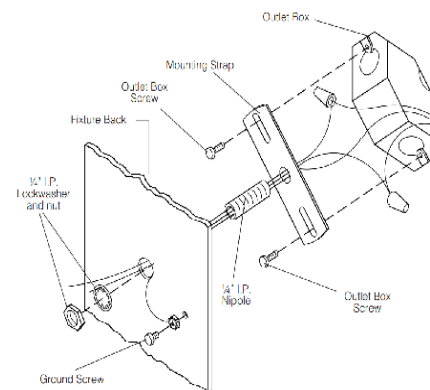

Accessories

Please refer to the appropriate accessory installation sheet for further instruction when applicable.

Maintenance:

Clean regularly with solvent-free cleaner removing dirt and debris. Do not use high pressure cleaners.

Replacement Parts

See label inside of fixture for LED replacement part number.

Consult factory for all other replacement components.

Product Safety Warnings:

THIS PRODUCT MUST BE INSTALLED IN ACCORDANCE WITH THE APPLICABLE INSTALLATION CODE BY A PERSON FAMILIAR WITH THE CONSTRUCTION AND OPERATION OF THE PRODUCT AND THE HAZARDS INVOLVED. SUITABLE FOR WET LOCATIONS.

MIN 90°C SUPPLY CONDUCTORS.

CE PRODUIT DOIT ÊTRE INSTALLÉ SELON LE CODE D'INSTALLATION PERTINENT, PAR UNE PERSONNE QUI CONNAÎT BIEN LE PRODUIT ET SON FONCTIONNEMENT AINSI QUE LES RISQUES INHÉRENTS. CONVIENT AUX EMPLACEMENTS MOUILLÉS.

LES FILS D'ALIMENTATION 90°C MIN.