

Tools Required:

- Medium - Philips Screwdriver
- 5/16" - Hex Screwdriver

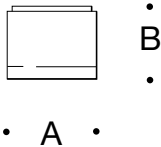

Dimensions

A: 5 7/8"

B: 5"



Controllability: 0-10V, TRIAC and ELV dimmable

LED Watts: 10.0W

Weight: 3.0 lbs.

Protection Class: IP65

Notice to Installer:

1. BEGA luminaires may be damaged if connected to conduit systems containing water- Article 300-5G of National Electric Code requires that "Conduits or raceways through which moisture may contact energized live parts shall be sealed or plugged at either or both ends".
2. Mounts directly to a standard octagonal 4" wiring box (by others) using adapter plate (supplied).
3. In conformance with U.L. Standards 1598, a silicone-based sealant **MUST** be used between the mounting plate edge and supporting wall.
4. LEDs are high-quality electronic components! Please avoid touching the light output opening of the LED directly during installation.

Installation:

1. Assemble the mounting kit as shown [Figure 1].
2. Attach mounting plate to wiring box using (2) Philips 8-32 x 1/2" screws (provided)
3. Feed luminaire wires through luminaire base and mounting plate.
Make supply wiring and luminaire wiring connections inside the wiring box:
CONNECT WHITE (COMMON) SUPPLY WIRE TO WHITE FIXTURE LEAD
CONNECT BLACK (HOT) SUPPLY WIRE TO BLACK FIXTURE LEAD
CONNECT GREEN (GROUND) SUPPLY WIRE TO GREEN FIXTURE LEAD
Dimming (0-10V, if applicable):
DIMMING CONTROL WIRE (+) TO POSITIVE DRIVER DIM CONTROL WIRE
DIMMING CONTROL WIRE (-) TO NEGATIVE DRIVER DIM CONTROL WIRE
4. Align and place luminaire over the mounting screws.
5. Inside the luminaire, security tighten the (2) 8-32 hex nuts (provided) onto mounting screws.
6. Carefully screw lens onto housing, making sure the gasket .
7. Place a small bead of silicone based sealant around the back side of the luminaire base that comes in contact with the finished wall.
(Exterior applications only)

Figure 1: Generic Diagram

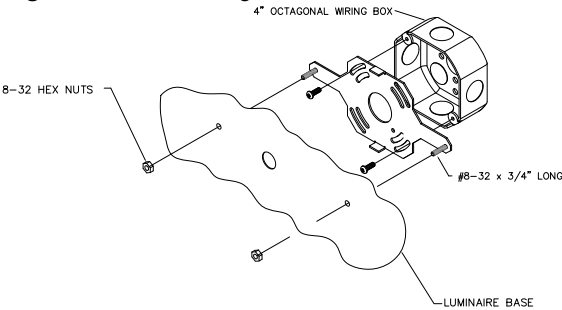

Accessories

Please refer to the appropriate accessory installation sheet for further instruction when applicable.

Accessories

Please refer to the appropriate accessory installation sheet for further instruction when applicable.

Maintenance:

Clean regularly with solvent-free cleaner removing dirt and debris. Do not use high pressure cleaners.

Replacement Parts

See label inside of fixture for LED replacement part number.

Consult factory for all other replacement components.

Product Safety Warnings:

THIS PRODUCT MUST BE INSTALLED IN ACCORDANCE WITH THE APPLICABLE INSTALLATION CODE BY A PERSON FAMILIAR WITH THE CONSTRUCTION AND OPERATION OF THE PRODUCT AND THE HAZARDS INVOLVED. SUITABLE FOR WET LOCATIONS.

MIN 90°C SUPPLY CONDUCTORS.

CE PRODUIT DOIT ÊTRE INSTALLÉ SELON LE CODE D'INSTALLATION PERTINENT, PAR UNE PERSONNE QUI CONNAÎT BIEN LE PRODUIT ET SON FONCTIONNEMENT AINSI QUE LES RISQUES INHÉRENTS. CONVIENT AUX EMPLACEMENTS MOUILLÉS.

LES FILS D'ALIMENTATION 90°C MIN.