

REV	CHANGED BY	DESCRIPTION	DATE

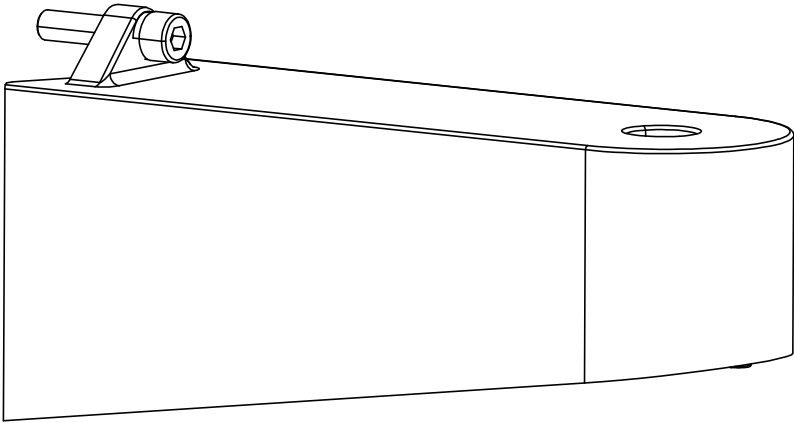
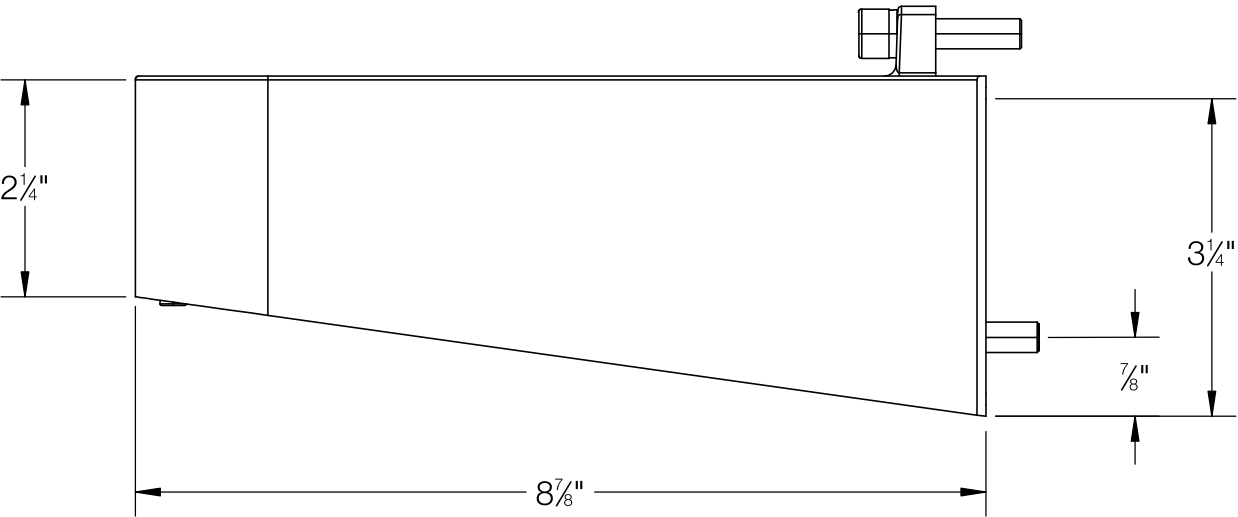
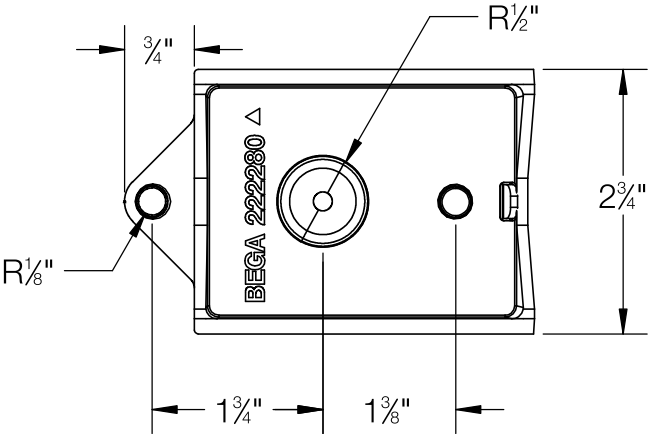
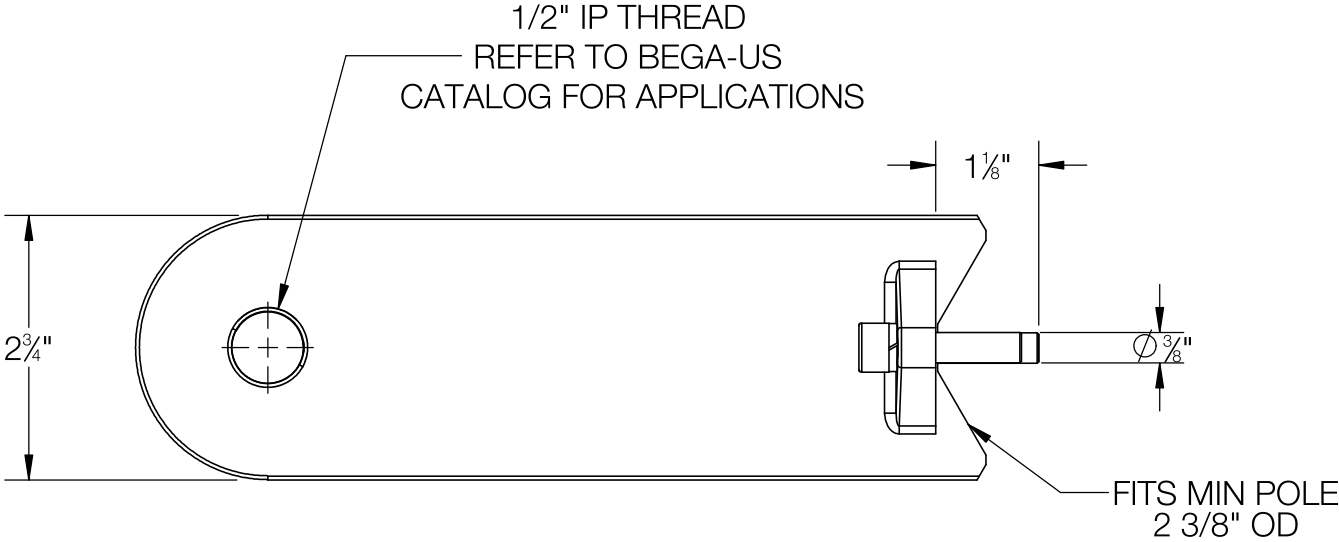

NOTES:

1. DESIGNED TO ACCOMODATE BEGA SMALL SCALE FLOODLIGHTS
2. ARM REQUIRED FACTORY INSTALLED THREADED INSERTS (SEE DETAILS)
3. EPA: 0.2
4. WEIGHT: 1.5 LBS

BEGA IS NOT RESPONSIBLE FOR COMPATIBILITY WITH POLES BY OTHERS

BEGA

1000 BEGA Way, Carpinteria, California 93013

P (805) 684-0533 - www.bega-us.com

APPROVED: _____ DATE: _____

TYPE: _____

DESCRIPTION:

POLE MOUNT ARM - 1/2"

IPS NIPPLE FLOODLIGHTS

PROPRIETARY AND CONFIDENTIAL

THE INFORMATION CONTAINED IN THIS DRAWING IS THE SOLE PROPERTY OF BEGA NORTH AMERICA, INC.

ANY REPRODUCTION IN PART OR AS A WHOLE WITHOUT THE WRITTEN PERMISSION OF BEGA NORTH AMERICA, INC. IS PROHIBITED.

SIZE

B

PART NO.

70379

REV

-

NOT TO SCALE

11/21/2023

SHEET 1 OF 1