

Tools Required:

- 3mm hex key
- Adjustable Wrench

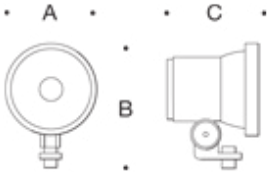

- Dimensions**
- A: 5-1/2 "
 - B: 8 "
 - C: 5-1/2 "



Protection Class: IP65

Weight: 3.31 lbs.

- Notice to Installer for 77 685:
1. See page 2 for specific product safety warnings.
 2. It is the installing contractor's responsibility to provide the necessary blocking around the junction box to ensure that the mounting plate or accessory (by others) is properly secured.
 3. Provided with a stainless steel nipple threaded 1/2" I.P.S. for direct attachment to cast boxes or a selection of mounting accessories (by others).
 4. Integral LED module and LED driver supplied by BEGA.
 5. Do NOT remove moisture absorption packet from luminaire housing.

Figure 1

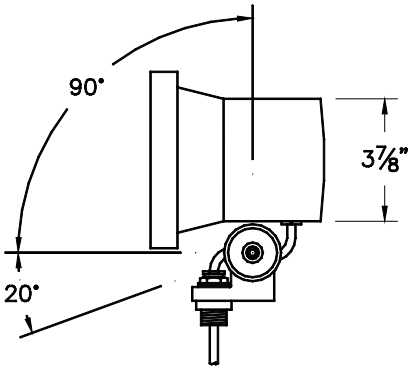

- 77 685 - installation:
1. Make supply wiring and luminaire wiring connections inside the wiring box (by others):
 - MAIN VOLTAGE SUPPLY WIRE TO BLACK LUMINAIRE WIRE
 - NEUTRAL (COMMON) SUPPLY WIRE TO WHITE LUMINAIRE WIRE
 - GREEN GROUND WIRE TO GREEN LUMINAIRE WIRE
 - Dimming (if applicable):
 - DIMMING CONTROL WIRE (+) TO POSITIVE DRIVER DIM CONTROL WIRE
 - DIMMING CONTROL WIRE (-) TO NEGATIVE DRIVER DIM CONTROL WIRE
 2. Screw and secure mounting bushing into the female thread provided on site.
 3. To adjust head angle, use 3mm hex key to loosen adjustment screw. Adjust luminaire head and tighten adjustment screw.

| Relamping/Maintenance | Accessories | Replacement Parts | |
|--|---|--------------------|--------------|
| | | Description | Part No |
| Remove trim and lens by loosening screws. Clean luminaire and lens using only solvent-free cleansers. Replace trim and lens. Tighten screws. | Please refer to the appropriate accessory installation sheet for further instruction when applicable. | Lens | 140851 |
| | | Lens gasket | 831279 |
| Lamp: 13.9W LED Module | 180° Glare Shield | | 76097 |
| | Elliptical Spread Lens | LED Module (3000K) | LED-0623/930 |
| | | LED Module (4000K) | LED-0623/940 |

Product Safety Warnings:

CAUTION - RISK OF FIRE. THIS PRODUCT MUST BE INSTALLED IN ACCORDANCE WITH THE APPLICABLE INSTALLATION CODE BY A PERSON FAMILIAR WITH THE CONSTRUCTION AND OPERATION OF THE PRODUCT AND THE HAZARDS INVOLVED. SUITABLE FOR WET LOCATIONS.

MIN 90°C SUPPLY CONDUCTORS.

ATTENTION - RISQUE D'INCENDIE, CE PRODUIT DOIT ÊTRE INSTALLÉ SELON LE CODE D'INSTALLATION PERTINENT, PAR UNE PERSONNE QUI CONNAÎT BIEN LE PRODUIT ET SON FONCTIONNEMENT AINSI QUE LES RISQUES INHÉRENTS. CONVIENT AUX EMPLACEMENTS MOUILLES.

LES FILS D'ALIMENTATION 90°C MIN.
