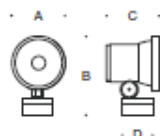

**Tools Required:**

3mm hex key  
 5mm hex key  
 Flat head screw driver medium  
 Phillips head screw driver medium

**Dimensions**

**A:** 6-1/4 "  
**B:** 8-7/8 "  
**C:** 6-1/2 "  
**D:** 3-7/8 "

**Protection Class:** IP65

**Weight:** 5.07 lbs.

**Notice to Installer for 77 701:**

1. See page 2 for specific product safety warnings.
2. Integral LED driver supplied by BEGA.
3. Luminaire mounts directly to standard recessed 4" octagonal wiring (by others), using mounting plate provided.
4. Do NOT remove moisture absorption packet from luminaire housing.

**77 701 - installation:**

1. Loosen the (1) 3mm hex screw on the luminaire canopy and remove luminaire base from luminaire.
2. Feed luminaire wiring through the luminaire base and mounting plate.
3. Make supply wiring and luminaire wiring connections inside the wiring box (by others):

MAIN VOLTAGE SUPPLY WIRE TO BLACK LUMINAIRE WIRE  
 NEUTRAL (COMMON) SUPPLY WIRE TO WHITE LUMINAIRE WIRE  
 GREEN GROUND WIRE TO GREEN LUMINAIRE WIRE

Dimming (if applicable):

DIMMING CONTROL WIRE (+) TO POSITIVE DRIVER DIM CONTROL WIRE  
 DIMMING CONTROL WIRE (-) TO NEGATIVE DRIVER DIM CONTROL WIRE

4. Attach provided mounting plate directly to a 4" standard octagonal wiring box using the (2) screws (provided). Place a small bead of silicone around the back side of the mounting plate that will come in contact with the finished surface (exterior applications only).
5. Align and position mounting plate on mounting surface to correspond with specified mounting orientation.
6. Slip luminaire base over the mounting plate. Tighten nuts on the studs (provided) to secure.
7. Replace luminaire canopy (with luminaire attached) and tighten (1) set screw.
8. To adjust head angle, use 5mm hex key to loosen adjustment screw. Adjust luminaire head as needed and tighten adjustment screw.

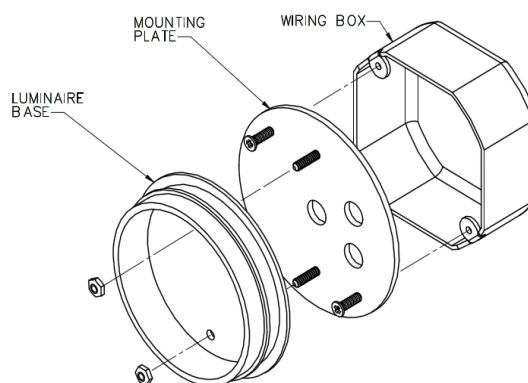
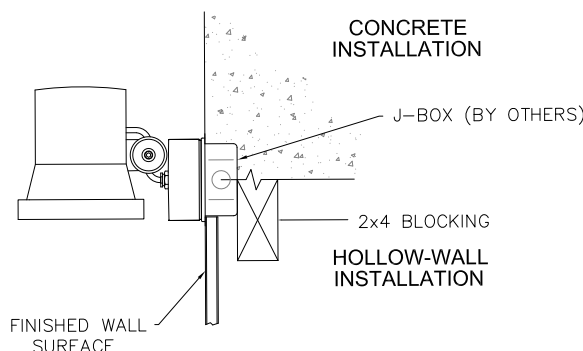
**Figure 1**

**Figure 2**

**Relamping/Maintenance**

Remove trim and lens by loosening screws. Clean luminaire and lens using only solvent-free cleansers. Replace trim and lens. Tighten screws.

**Accessories**

Please refer to the appropriate accessory installation sheet for further instruction when applicable.

Flat beam spread lens	70 060
180° glare shield	70 757
Internal louver	70 796

**Replacement Parts**

Description	Part No
Lens	140852
Lens gasket	831280
Driver	76089
LED Module (3000K)	LED-0638/930
LED Module (4000K)	LED-0638/940

**Lamp:** 19.2W LED Module

---

**Product Safety Warnings:**

**CAUTION - RISK OF FIRE. THIS PRODUCT MUST BE INSTALLED IN ACCORDANCE WITH THE APPLICABLE INSTALLATION CODE BY A PERSON FAMILIAR WITH THE CONSTRUCTION AND OPERATION OF THE PRODUCT AND THE HAZARDS INVOLVED. SUITABLE FOR WET LOCATIONS.**

**MIN 90°C SUPPLY CONDUCTORS.**

**ATTENTION - RISQUE D'INCENDIE. CE PRODUIT DOIT ÊTRE INSTALLÉ SELON LE CODE D'INSTALLATION PERTINENT, PAR UNE PERSONNE QUI CONNAÎT BIEN LE PRODUIT ET SON FONCTIONNEMENT AINSI QUE LES RISQUES INHÉRENTS. CONVIENT AUX EMPLACEMENTS MOUILLÉS.**

**LES FILS D'ALIMENTATION 90°C MIN.**

---