

REV	CHANGED BY	DESCRIPTION	DATE

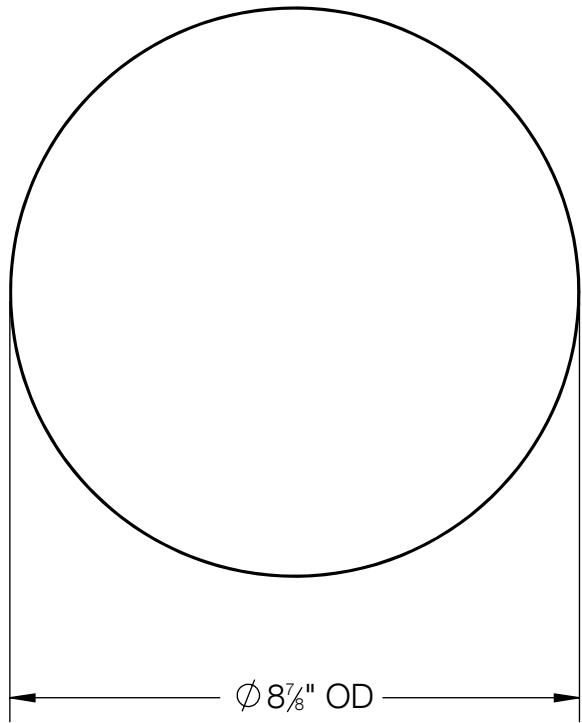

INSTALLATION SLEEVE PROVIDED

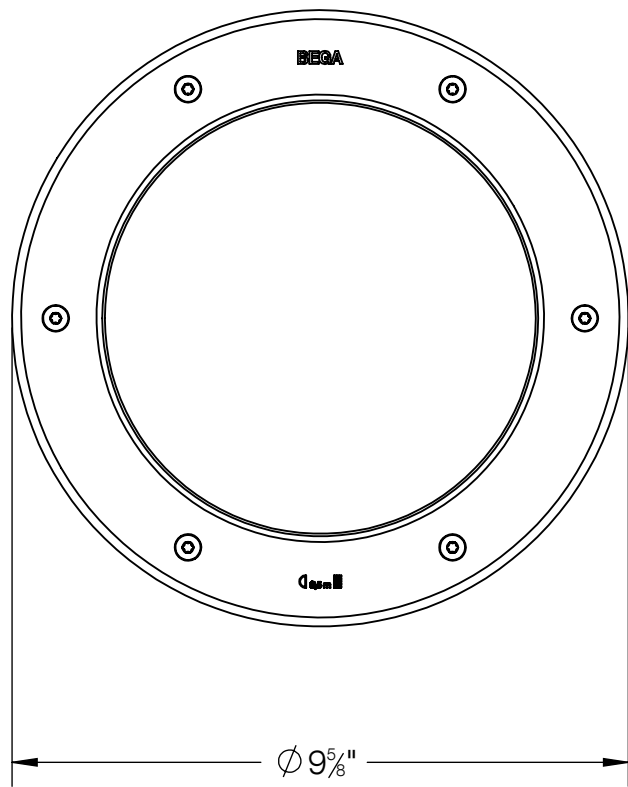
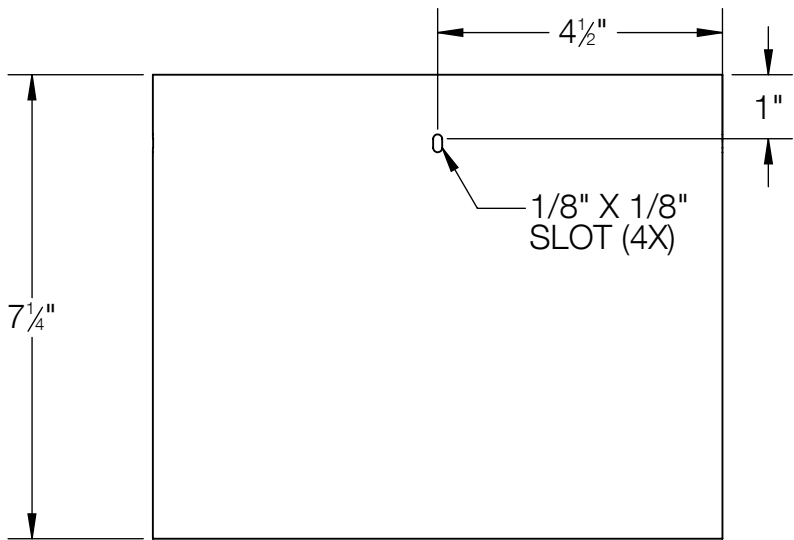
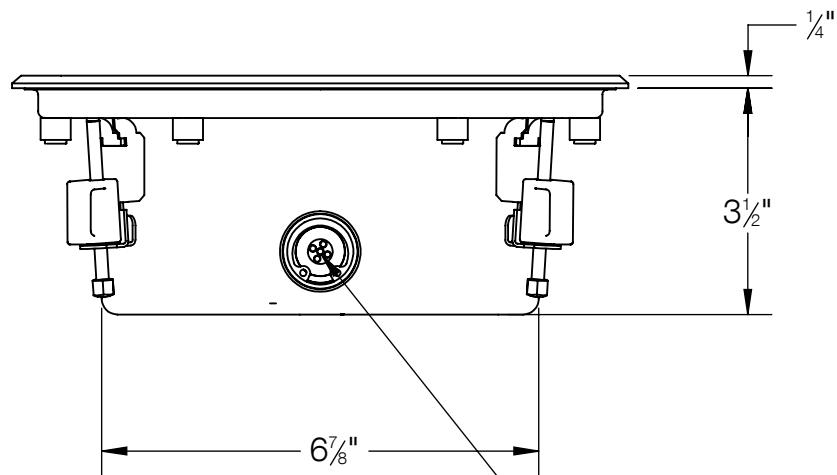
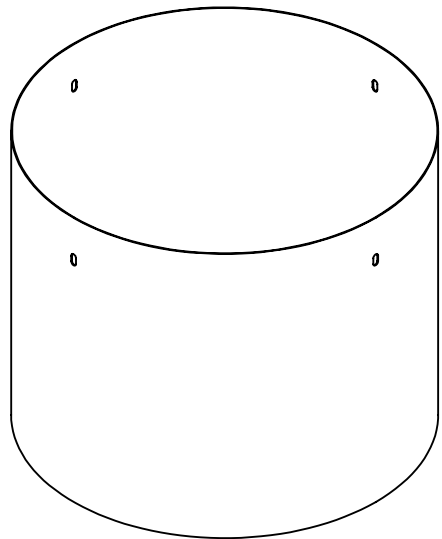
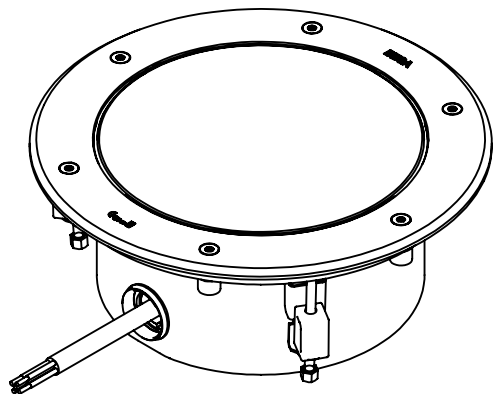

PROVIDED WITH 7.5' OF
WATER PROOF CABLE

NOTE:
1. INCLUDES KIT #40 - WATER PROOF CONNECTOR KIT

BEGA

1000 BEGA Way, Carpinteria, California 93013		P (805) 684-0533 - www.bega-us.com	
APPROVED: _____ DATE: _____		DESCRIPTION: INGRADE LUMINAIRE - LOCATION LUMINAIRE	
TYPE: _____			
PROPRIETARY AND CONFIDENTIAL THE INFORMATION CONTAINED IN THIS DRAWING IS THE SOLE PROPERTY OF BEGA NORTH AMERICA, INC. ANY REPRODUCTION IN PART OR AS A WHOLE WITHOUT THE WRITTEN PERMISSION OF BEGA NORTH AMERICA, INC. IS PROHIBITED.		SIZE B	PART NO. 77814
		REV -	
NOT TO SCALE		7/22/2024	SHEET 1 OF 2

REV	CHANGED BY	DESCRIPTION	DATE

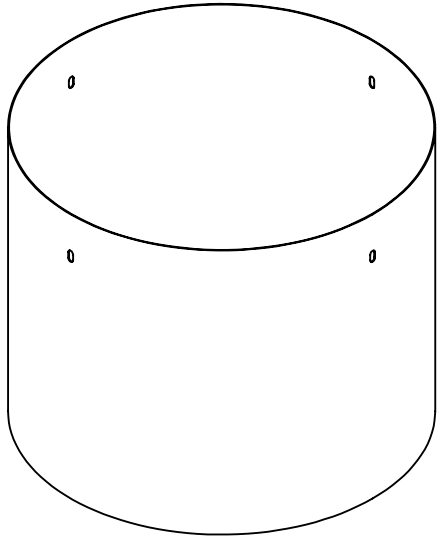
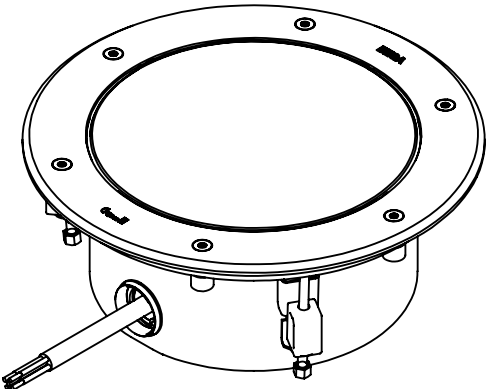
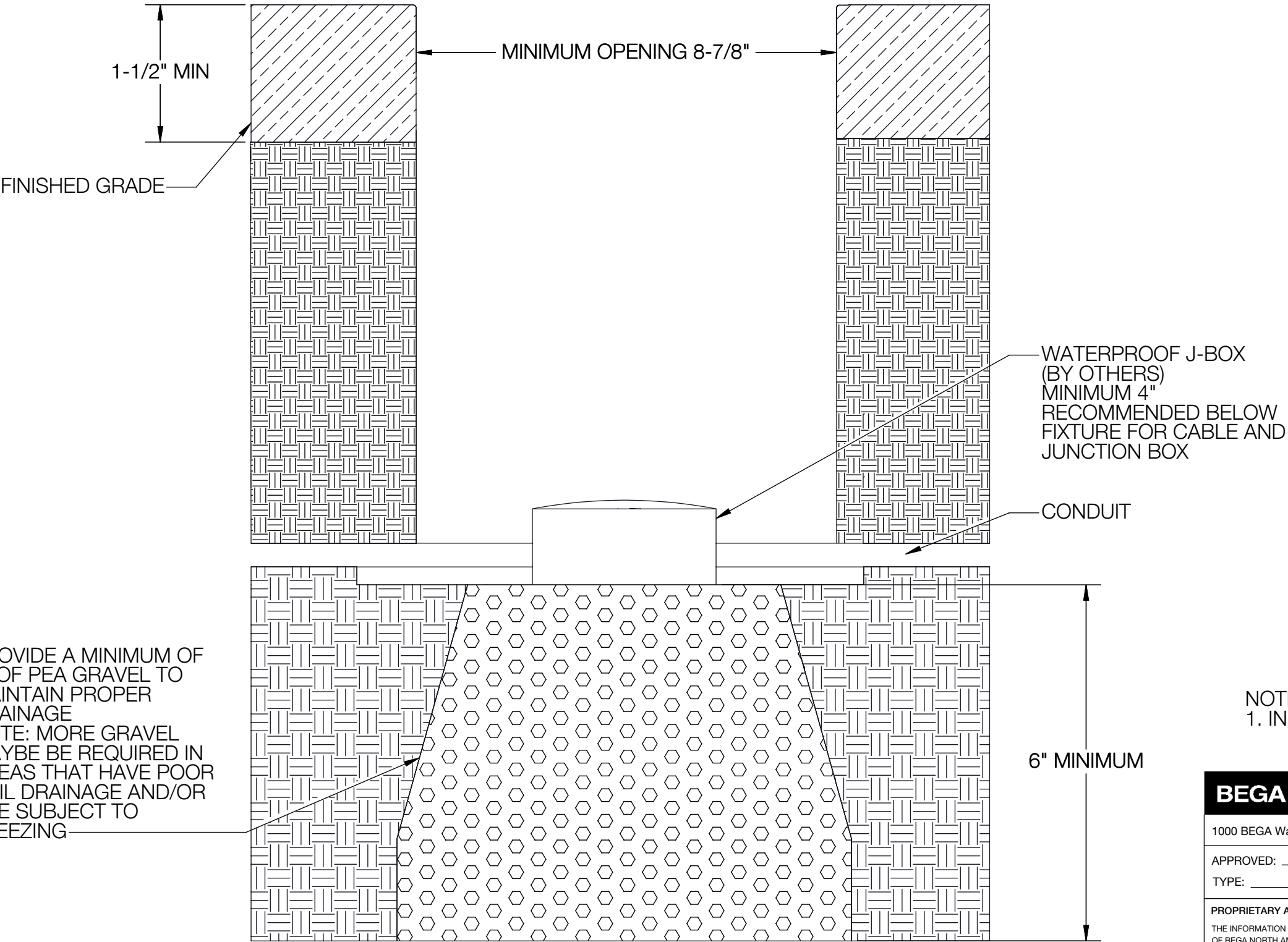

NOTE:
1. INCLUDES KIT #40 - WATER PROOF CONNECTOR KIT

BEGA				
1000 BEGA Way, Carpinteria, California 93013			P (805) 684-0533 - www.bega-us.com	
APPROVED: _____		DATE: _____		DESCRIPTION: INGRADE INSTALLATION
TYPE: _____				
PROPRIETARY AND CONFIDENTIAL		SIZE B	PART NO. 77814	REV -
THE INFORMATION CONTAINED IN THIS DRAWING IS THE SOLE PROPERTY OF BEGA NORTH AMERICA, INC. ANY REPRODUCTION IN PART OR AS A WHOLE WITHOUT THE WRITTEN PERMISSION OF BEGA NORTH AMERICA, INC. IS PROHIBITED.		NOT TO SCALE	7/22/2024	SHEET 2 OF 2