

REV	CHANGED BY	DESCRIPTION	DATE

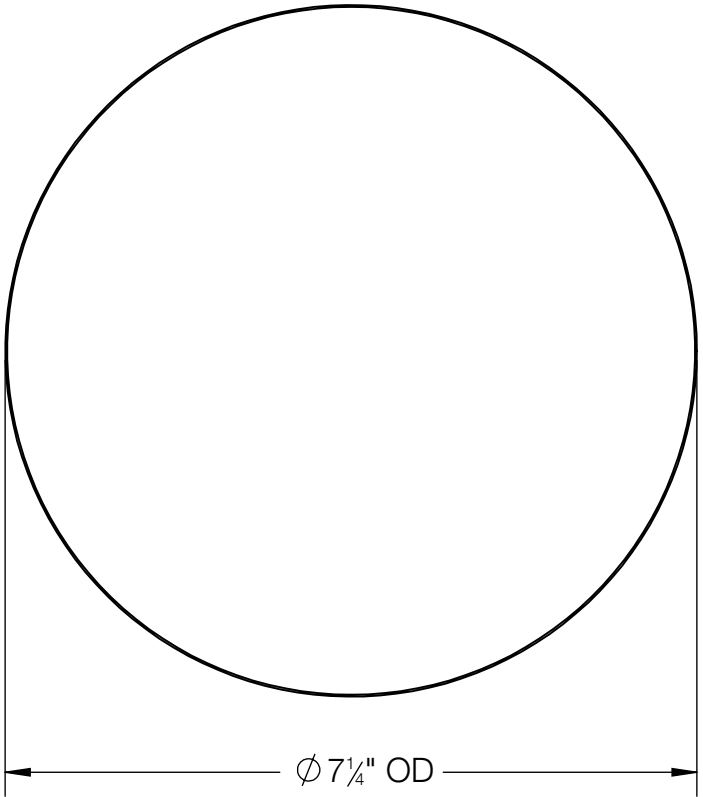

INSTALLATION SLEEVE PROVIDED

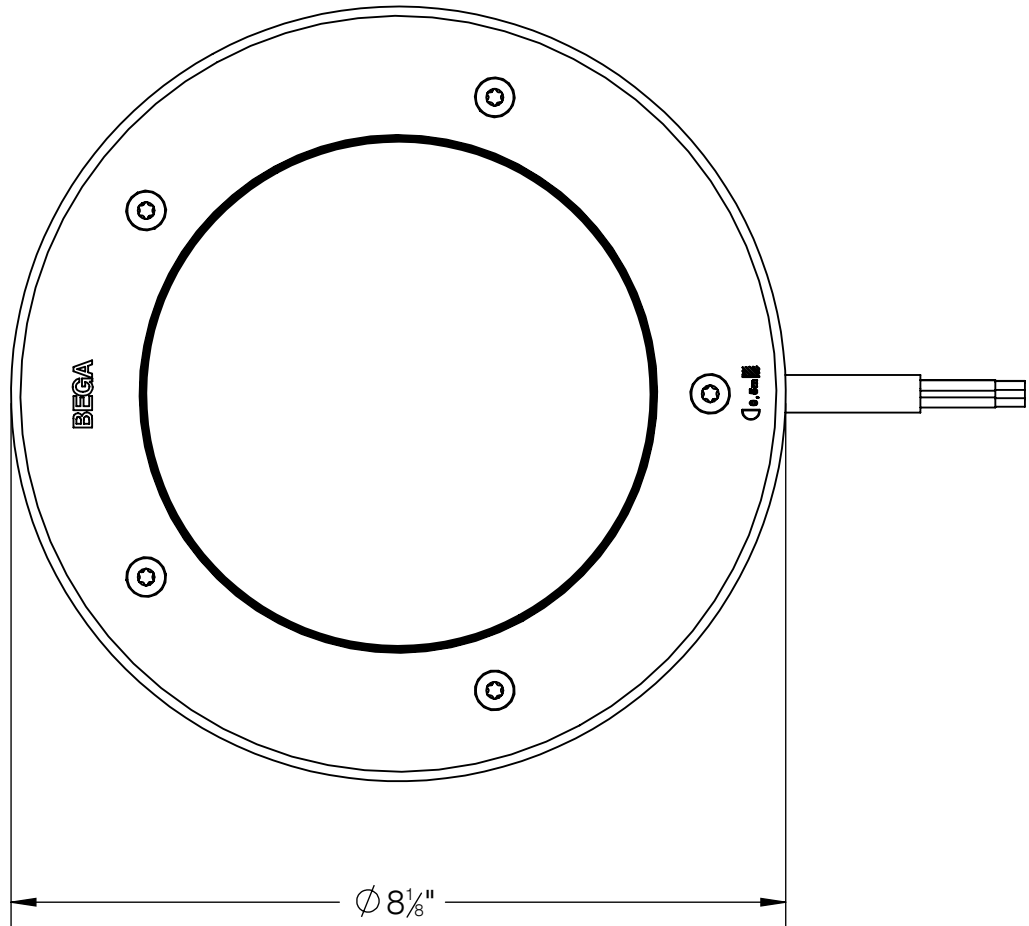
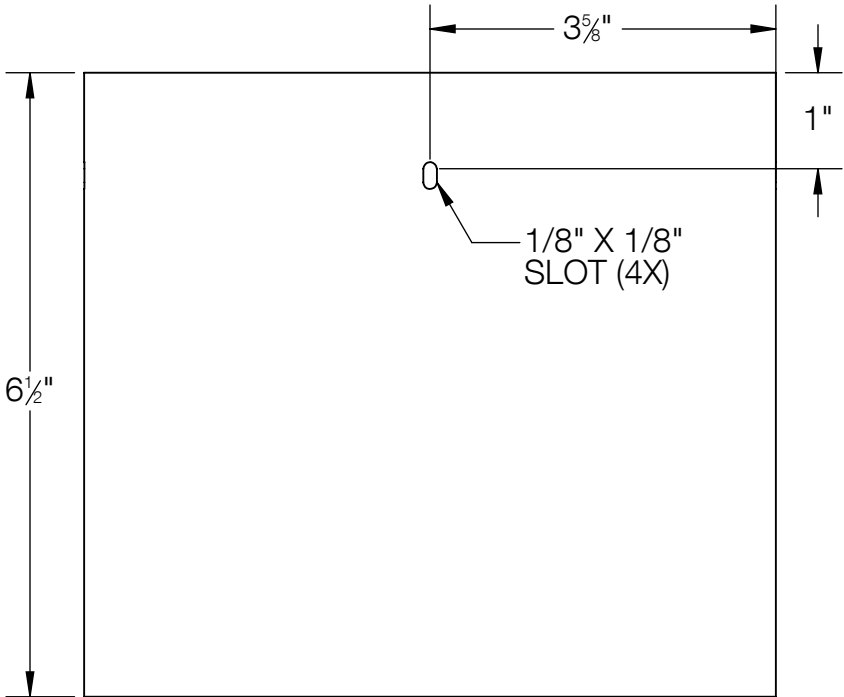
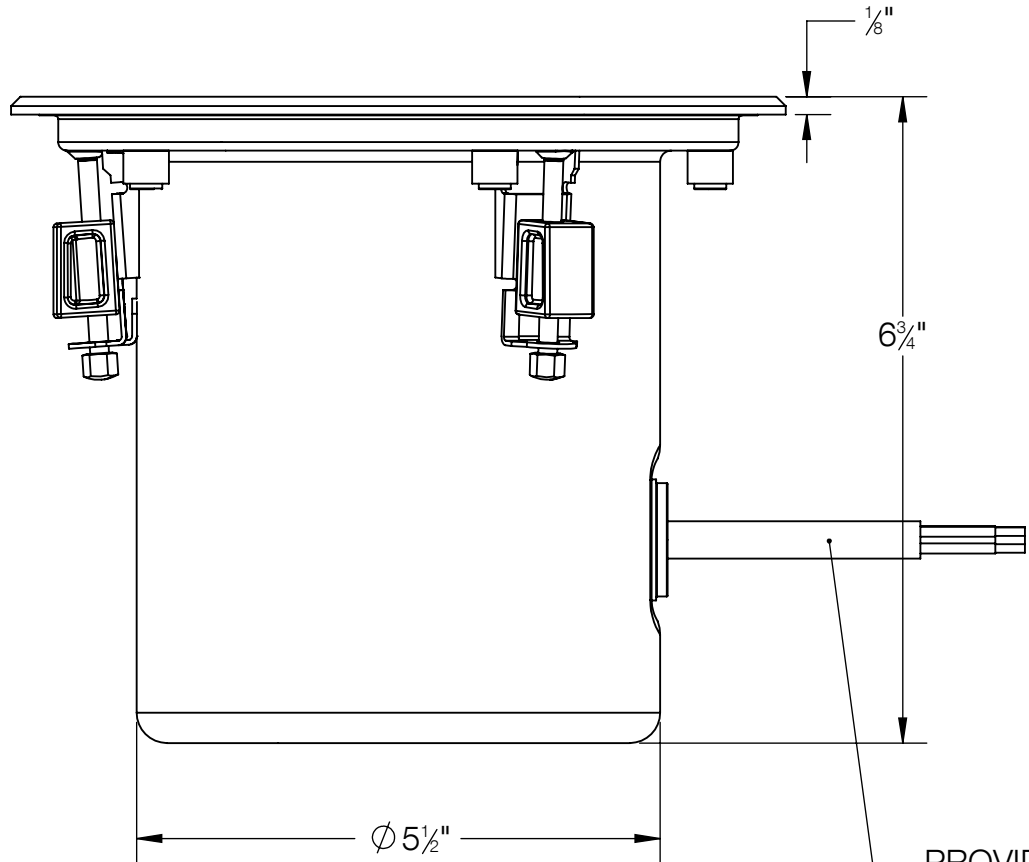
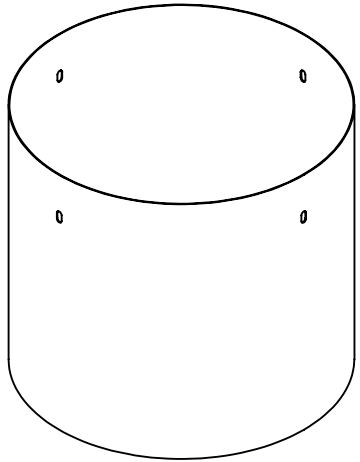
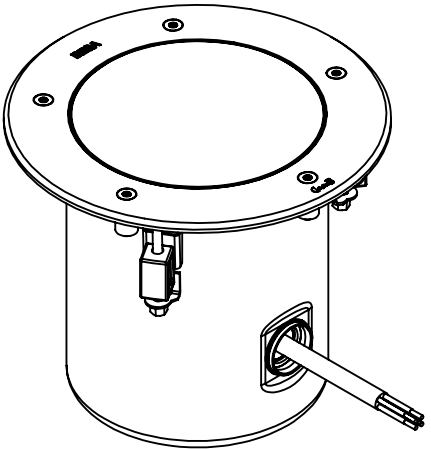

PROVIDED WITH 7.5' OF
WATER PROOF CABLE

NOTE:
1. INCLUDES KIT #40 - WATERPROOF CONNECTOR KIT

BEGA

1000 BEGA Way, Carpinteria, California 93013 P (805) 684-0533 - www.bega-us.com

APPROVED: _____ DATE: _____ DESCRIPTION:
TYPE: _____ INGRADE LUMINAIRE - SYMMETRIC

PROPRIETARY AND CONFIDENTIAL THE INFORMATION CONTAINED IN THIS DRAWING IS THE SOLE PROPERTY OF BEGA NORTH AMERICA, INC. ANY REPRODUCTION IN PART OR AS A WHOLE WITHOUT THE WRITTEN PERMISSION OF BEGA NORTH AMERICA, INC. IS PROHIBITED.	SIZE	PART NO.	REV
	B	77913	-
NOT TO SCALE		7/16/2024	SHEET 1 OF 2

REV	CHANGED BY	DESCRIPTION	DATE

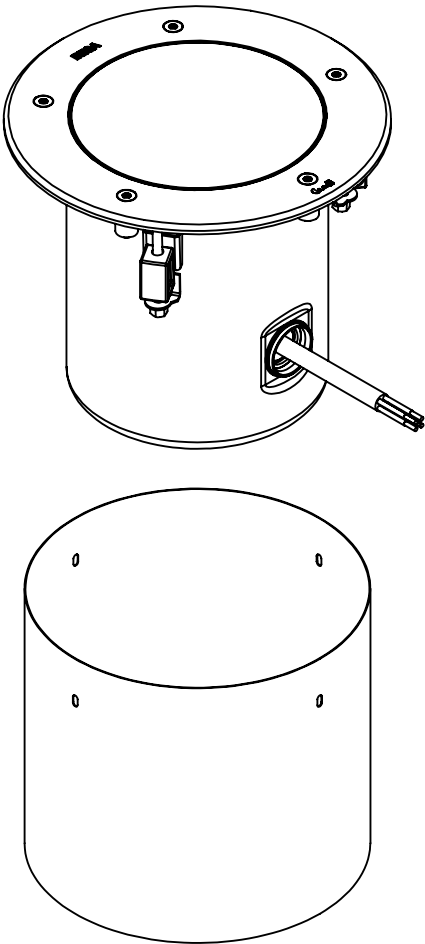
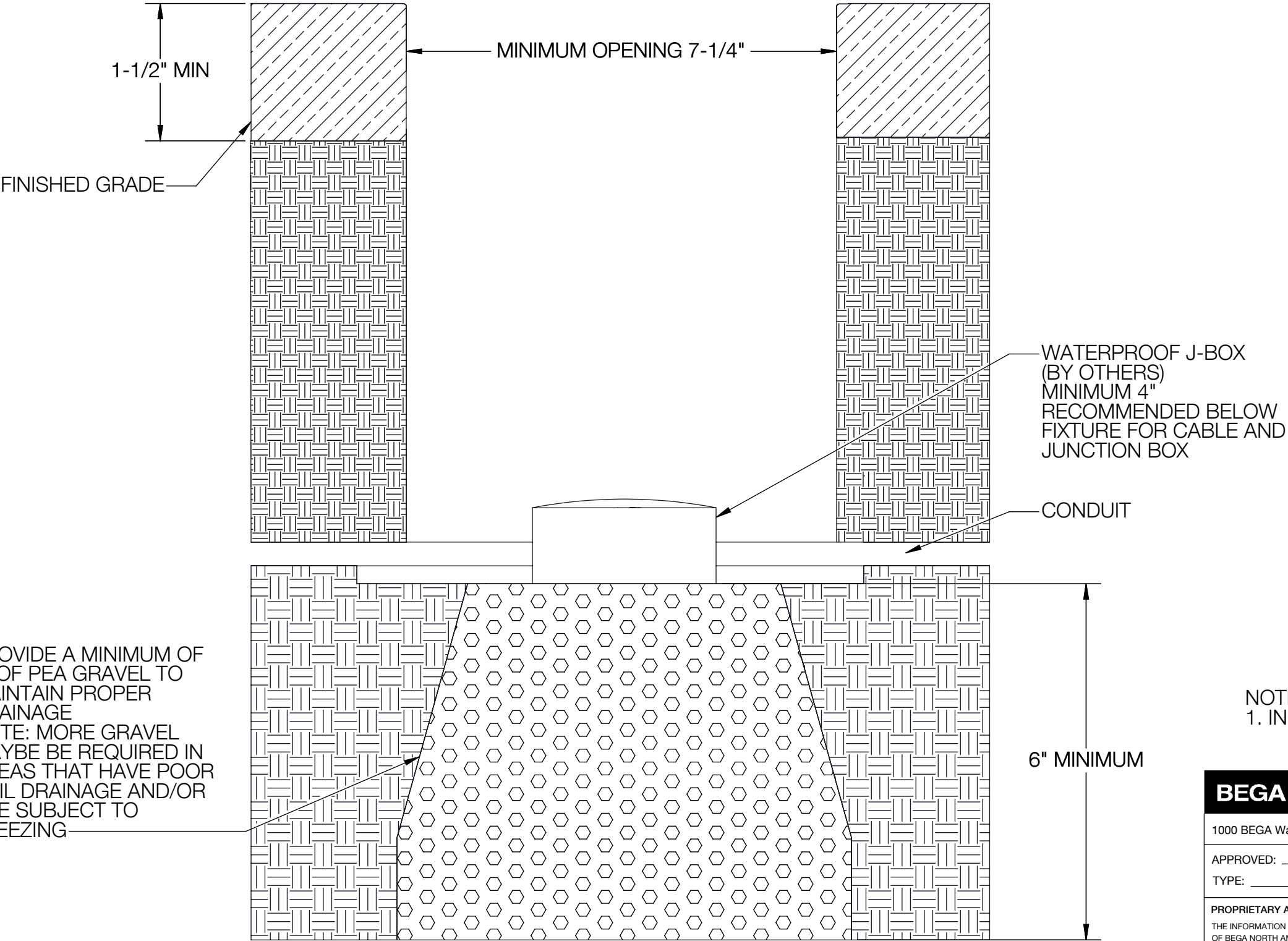

NOTE:
1. INCLUDES KIT #40 - WATERPROOF CONNECTOR KIT

BEGA			
1000 BEGA Way, Carpinteria, California 93013		P (805) 684-0533 - www.bega-us.com	
APPROVED: _____ DATE: _____		DESCRIPTION: INGRADE INSTALLATION	
TYPE: _____			
PROPRIETARY AND CONFIDENTIAL THE INFORMATION CONTAINED IN THIS DRAWING IS THE SOLE PROPERTY OF BEGA NORTH AMERICA, INC. ANY REPRODUCTION IN PART OR AS A WHOLE WITHOUT THE WRITTEN PERMISSION OF BEGA NORTH AMERICA, INC. IS PROHIBITED.		SIZE B	PART NO. 77913
		NOT TO SCALE	7/16/2024
		SHEET 2 OF 2	