

NOTES:

- 1. BEGA FLOODLIGHT MOUNTING HUB ACCESSORY #79 555
- 2. HUB IS DESIGNED TO ACCOMODATE FROM (1) TO (4) BEGA #79 551 FLOODLIGHT MOUNTING ARMS.
- 3. MOUNTING HUB SLIP-FITS 3” O.D. POLE OR TENON.
- 4. EPA: 0.4 WEIGHT: 9.3 LBS. (NOT INCLUDING MOUNTING ARMS)

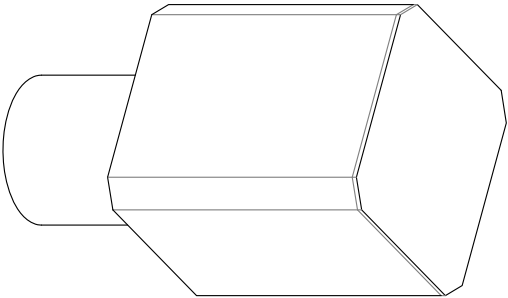
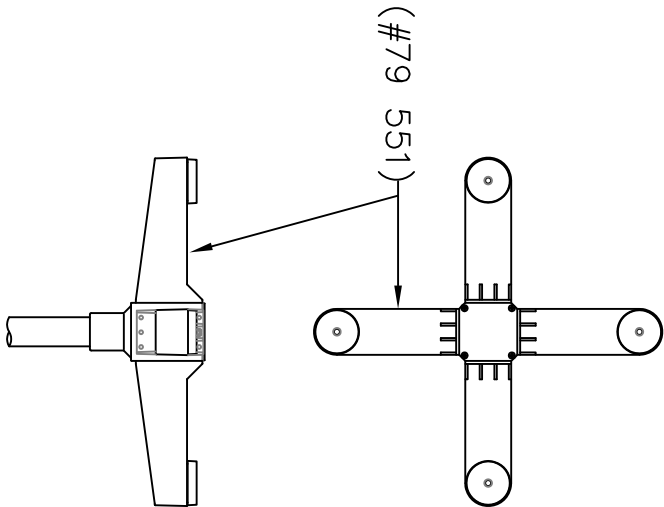
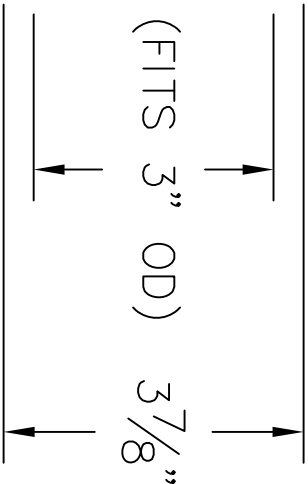
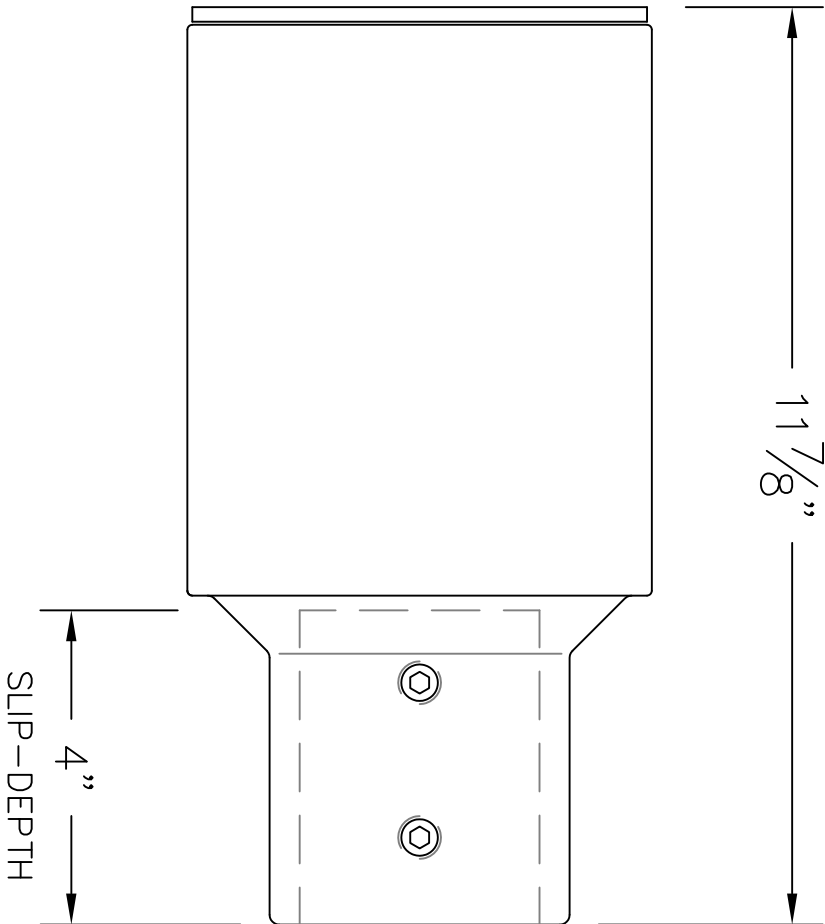
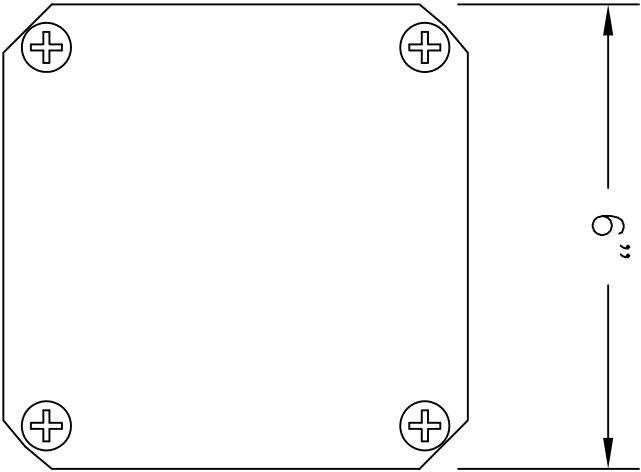

TYPE: _____

SUBMITTAL APPROVAL			CAT NO.: 79 555		BEGA
			PROJECT: -		
APPROVED BY: _____		LOCATION: -		1000 Bega Way Carpinteria, Ca. 93013 (805) 684-0533	
SIGNED: _____		DATE: _____			
REV.	DATE	DESCRIPTION	DRAWN: Bob Mc DATE: 3/27/17 FILE NAME: 79555		

This print contains confidential information which is the property of BEGA U.S. By acception this information, the borrower agrees that it will not be used for any other purpose other than that which is was loaned.