

REV	CHANGED BY	DESCRIPTION	DATE

FRONT VIEW

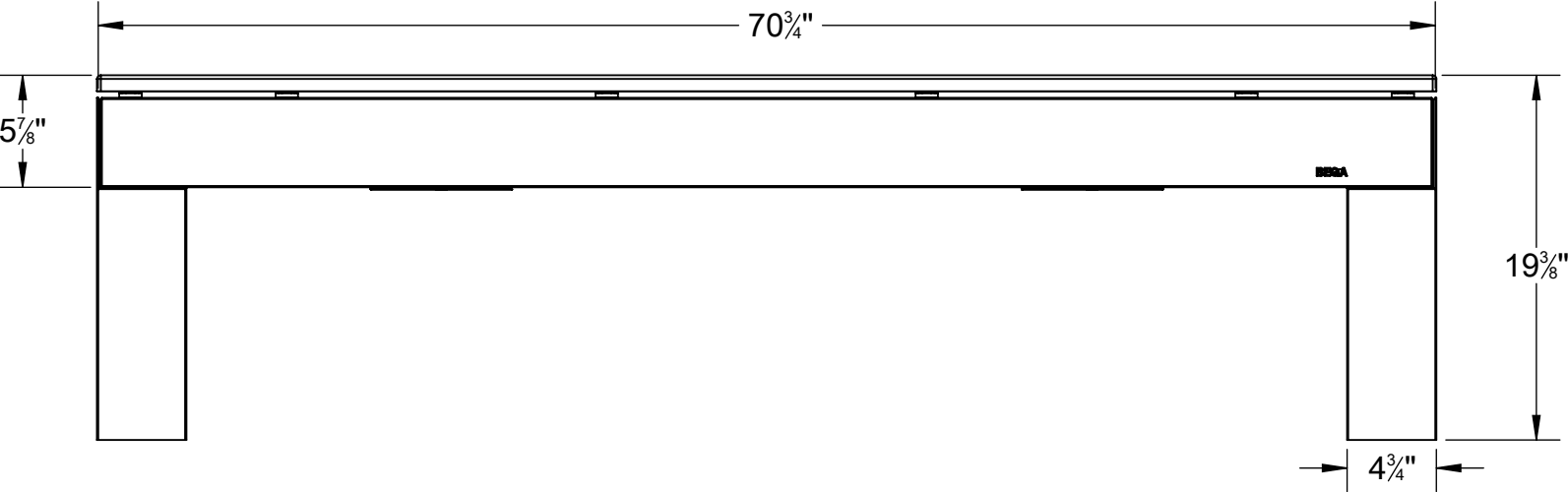

BOTTOM VIEW

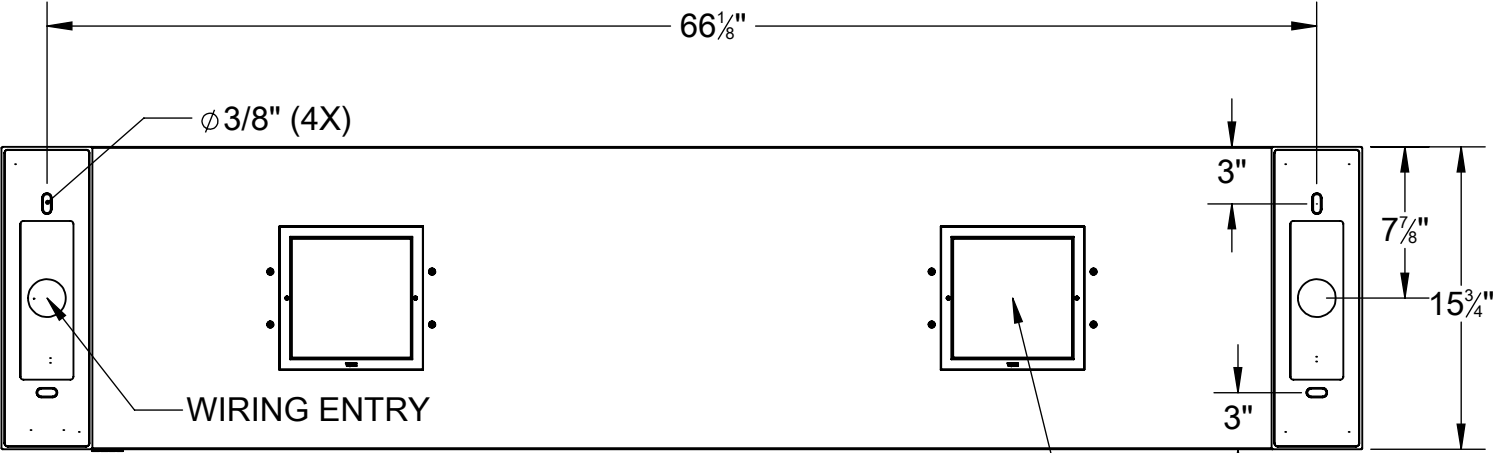

ISOMETRIC VIEW

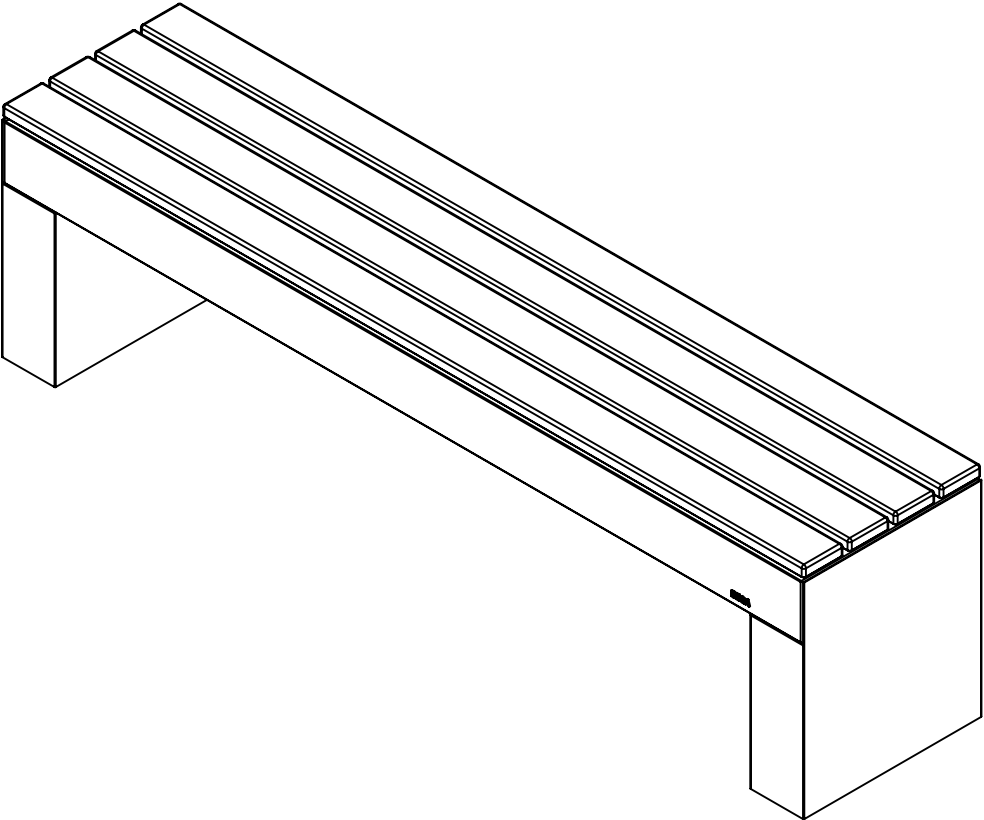

NOTE:
INCLUDES 79809 ANCHORAGE KIT.

BEGA				
1000 BEGA Way, Carpinteria, California 93013			P (805) 684-0533 - www.bega-us.com	
APPROVED: _____ DATE: _____		DESCRIPTION: ILLUMINATED BENCH - SYMMETRIC		
TYPE: _____				
PROPRIETARY AND CONFIDENTIAL THE INFORMATION CONTAINED IN THIS DRAWING IS THE SOLE PROPERTY OF BEGA NORTH AMERICA, INC. ANY REPRODUCTION IN PART OR AS A WHOLE WITHOUT THE WRITTEN PERMISSION OF BEGA NORTH AMERICA, INC. IS PROHIBITED.		SIZE	PART NO.	REV
		B	84236	-
		NOT TO SCALE	9/20/2023	SHEET 1 OF 2

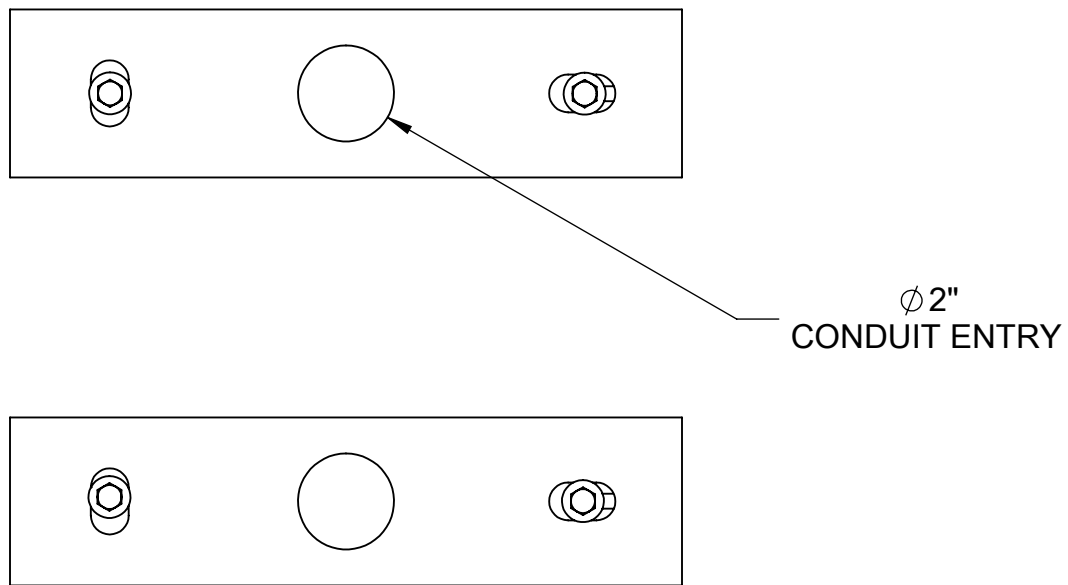
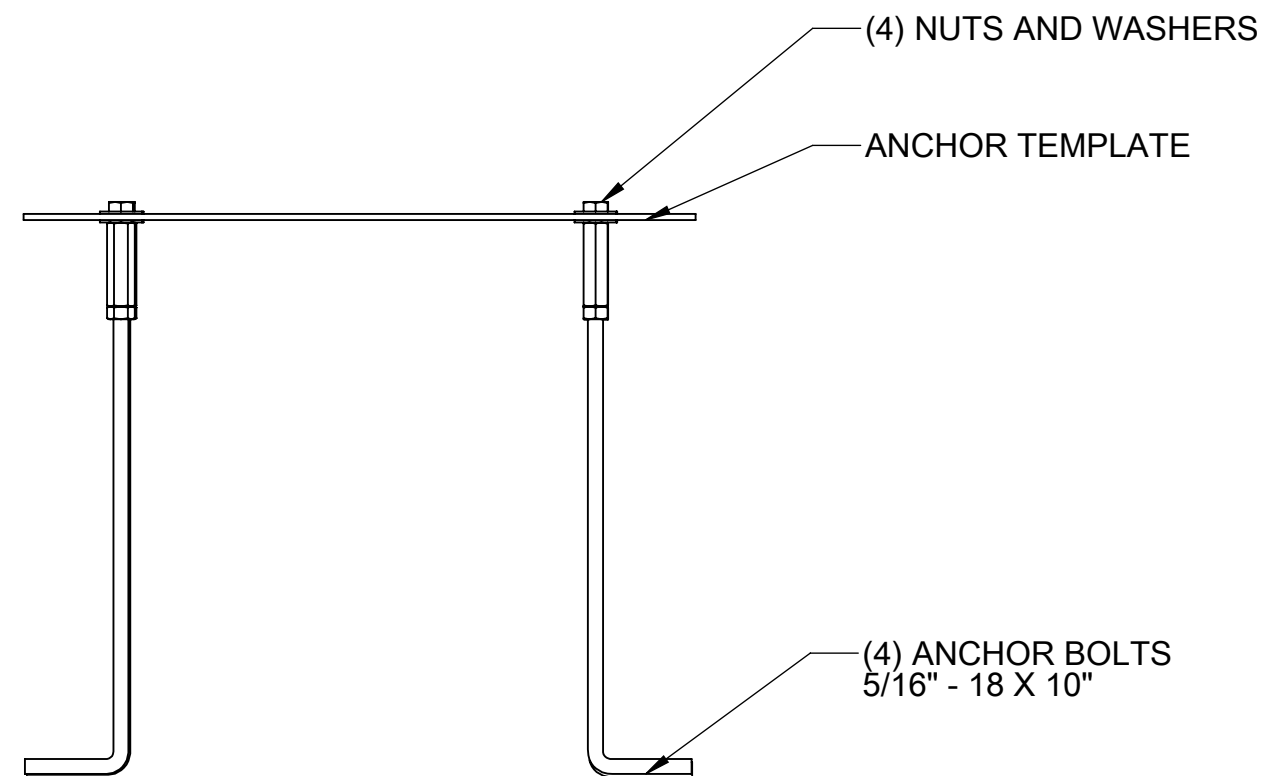

REV	CHANGED BY	DESCRIPTION	DATE

ISOMETRIC VIEW

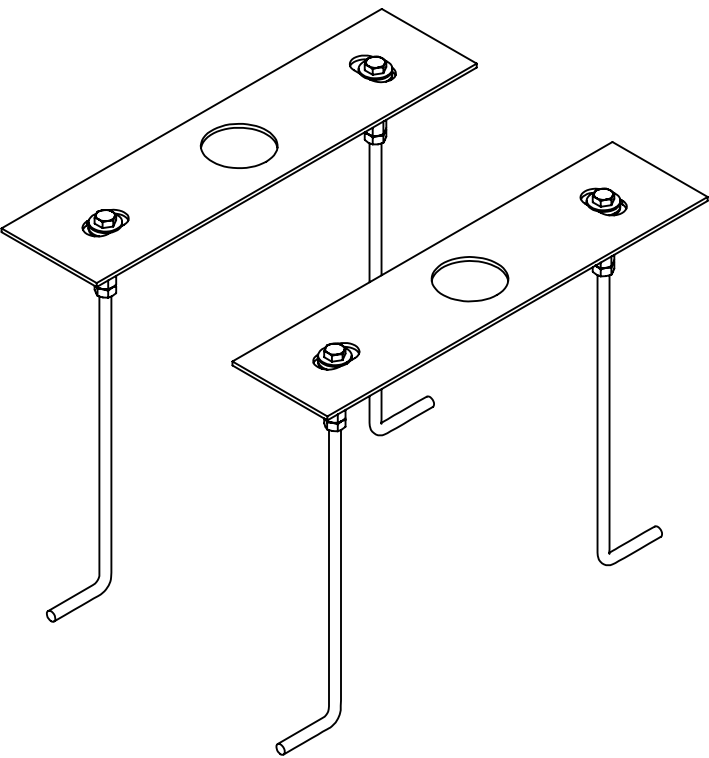

BEGA			
1000 BEGA Way, Carpinteria, California 93013		P (805) 684-0533 - www.bega-us.com	
APPROVED: _____ DATE: _____ TYPE: _____		DESCRIPTION: ANCHORAGE KIT	
PROPRIETARY AND CONFIDENTIAL THE INFORMATION CONTAINED IN THIS DRAWING IS THE SOLE PROPERTY OF BEGA NORTH AMERICA, INC. ANY REPRODUCTION IN PART OR AS A WHOLE WITHOUT THE WRITTEN PERMISSION OF BEGA NORTH AMERICA, INC. IS PROHIBITED.	SIZE B	PART NO. 79809	REV -
	NOT TO SCALE	9/20/2023	SHEET 2 OF 2