

REV	CHANGED BY	DESCRIPTION	DATE

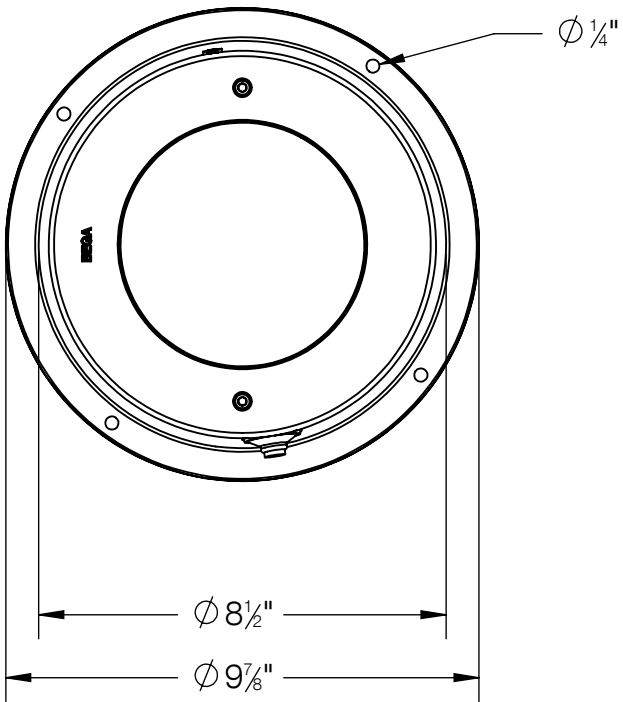

- NOTES:
- 1. MINIMUM OF 6" DRAINAGE REQUIRED
 - 2. FIXTURE PROVIDED WITH 7.5' LEAD WIRE
 - 3. HOUSING INCLUDED - BB84289

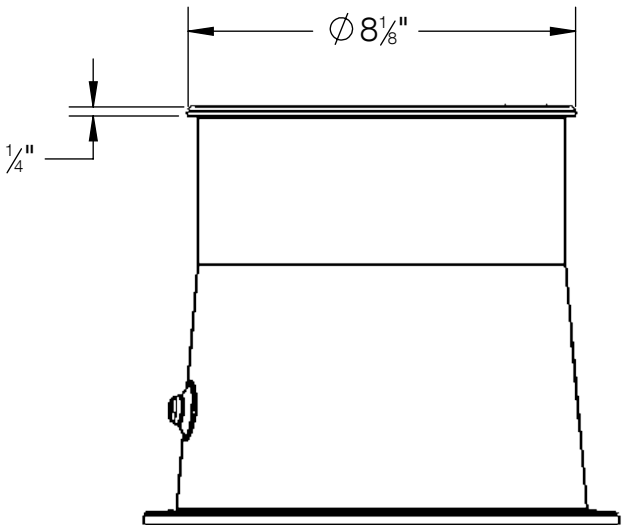
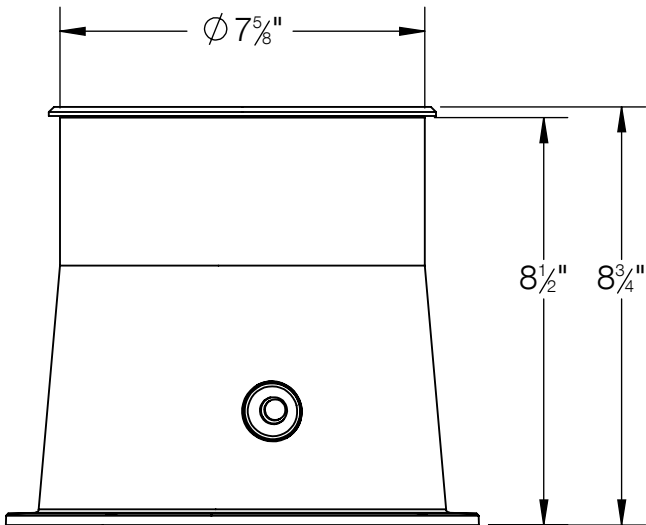
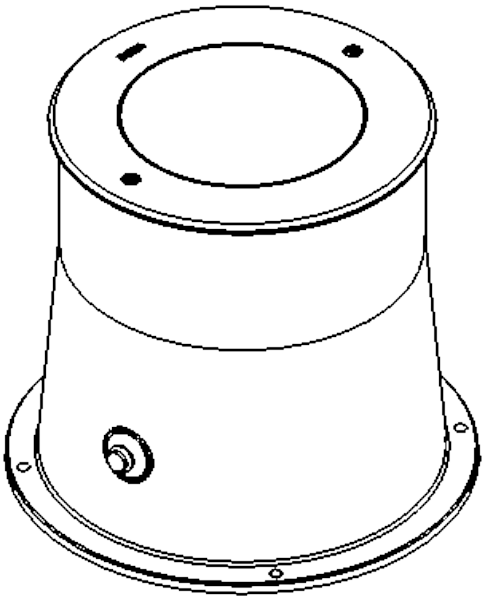

BEGA

1000 BEGA Way, Carpinteria, California 93013 P (805) 684-0533 - www.bega-us.com

APPROVED: _____ DATE: _____
TYPE: _____

DESCRIPTION:
IN-GRADE - SYMMETRIC

PROPRIETARY AND CONFIDENTIAL
THE INFORMATION CONTAINED IN THIS DRAWING IS THE SOLE PROPERTY
OF BEGA NORTH AMERICA, INC.
ANY REPRODUCTION IN PART OR AS A WHOLE WITHOUT THE WRITTEN
PERMISSION OF BEGA NORTH AMERICA, INC. IS PROHIBITED.

SIZE	PART NO.	REV
B	84292	-
NOT TO SCALE	6/17/2021	SHEET 1 OF 1