

REV	CHANGED BY	DESCRIPTION	DATE

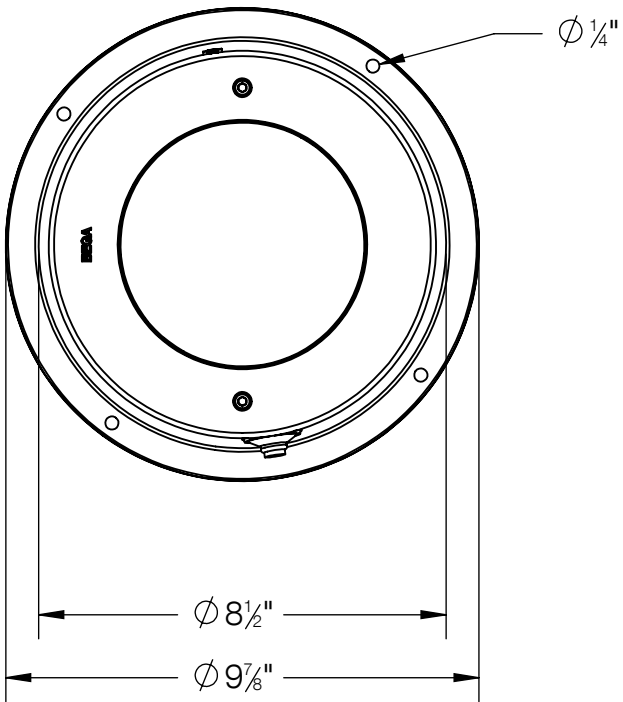

- NOTES:
1. MINIMUM OF 6" DRAINAGE REQUIRED
 2. FIXTURE PROVIDED WITH 7.5' LEAD WIRE
 3. HOUSING INCLUDED - BB84289

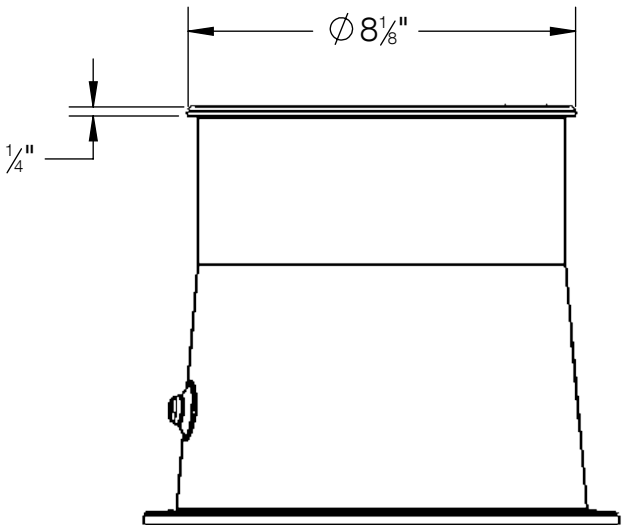
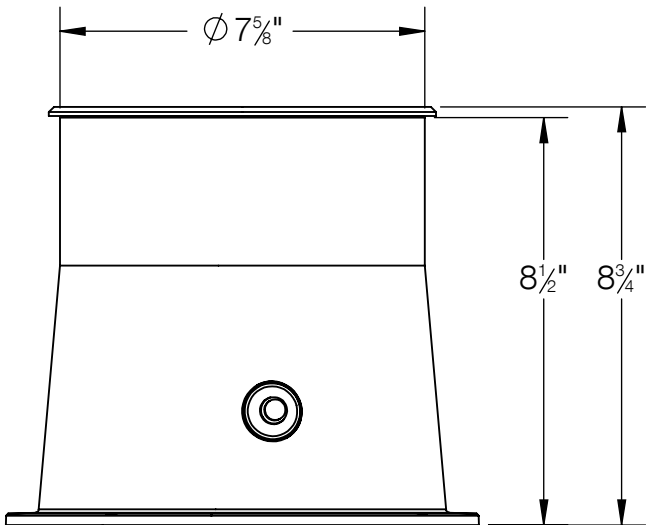
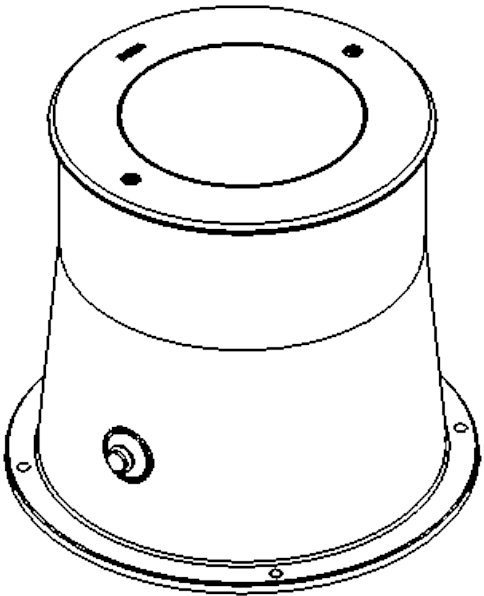

BEGA

1000 BEGA Way, Carpinteria, California 93013 P (805) 684-0533 - www.bega-us.com

APPROVED: _____ DATE: _____
TYPE: _____

DESCRIPTION:
IN-GRADE - WALL WASHER

PROPRIETARY AND CONFIDENTIAL
THE INFORMATION CONTAINED IN THIS DRAWING IS THE SOLE PROPERTY
OF BEGA NORTH AMERICA, INC.
ANY REPRODUCTION IN PART OR AS A WHOLE WITHOUT THE WRITTEN
PERMISSION OF BEGA NORTH AMERICA, INC. IS PROHIBITED.

SIZE	PART NO.	REV
B	84299	-

NOT TO SCALE 6/17/2021 SHEET 1 OF 1