

REV	CHANGED BY	DESCRIPTION	DATE

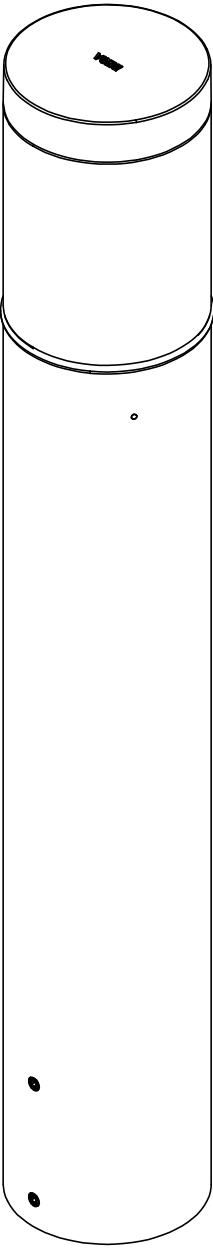

NOTE:  
-INCLUDES ANCHOR KIT 79824

BEGA				
1000 BEGA Way, Carpinteria, California 93013			P (805) 684-0533 - <a href="http://www.bega-us.com">www.bega-us.com</a>	
APPROVED: _____		DATE: _____		DESCRIPTION: BOLLARD - HARDSCAPE BASE
TYPE: _____				
PROPRIETARY AND CONFIDENTIAL <small>THE INFORMATION CONTAINED IN THIS DRAWING IS THE SOLE PROPERTY OF BEGA NORTH AMERICA, INC. ANY REPRODUCTION IN PART OR AS A WHOLE WITHOUT THE WRITTEN PERMISSION OF BEGA NORTH AMERICA, INC. IS PROHIBITED.</small>		SIZE B	PART NO. 84417	REV -
		NOT TO SCALE	8/7/2024	SHEET 1 OF 2

REV	CHANGED BY	DESCRIPTION	DATE

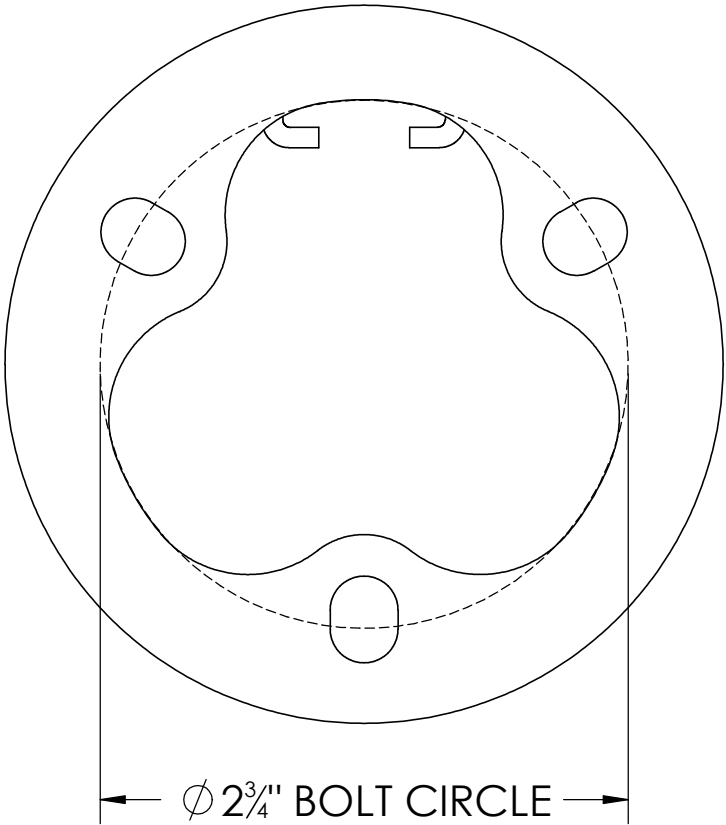
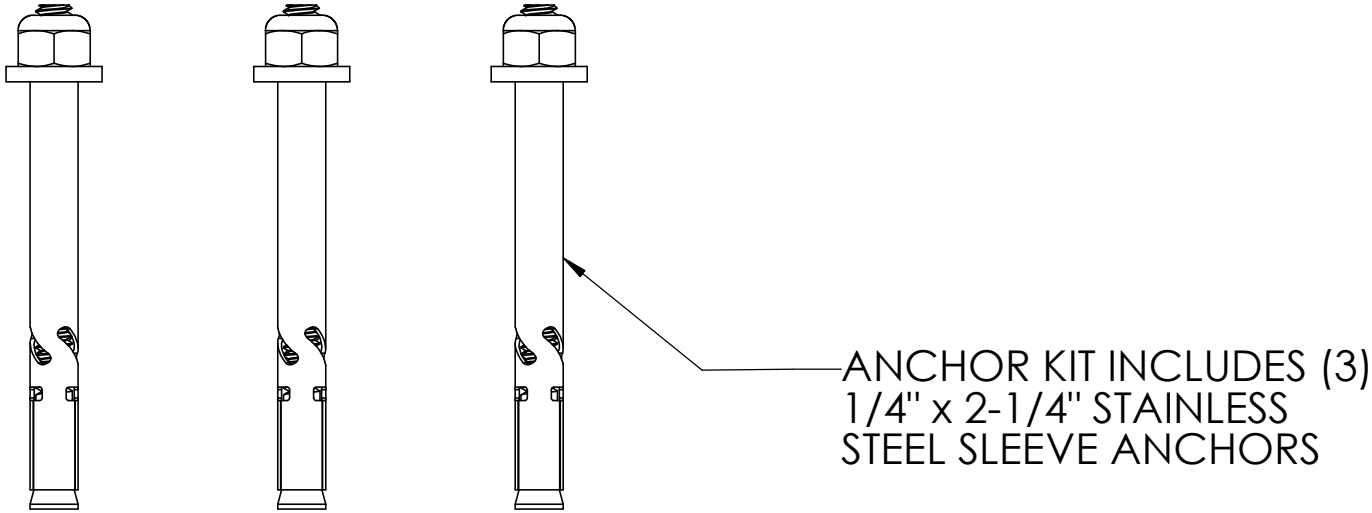

NOTE: ANCHOR KIT DOES NOT INCLUDE TEMPLATE, USE BOLLARD BASE AS TEMPLATE (SHOWN)

BEGA				
1000 BEGA Way, Carpinteria, California 93013			P (805) 684-0533 - www.bega-us.com	
APPROVED: _____		DATE: _____		DESCRIPTION: ANCHORAGE KIT
TYPE: _____				
PROPRIETARY AND CONFIDENTIAL THE INFORMATION CONTAINED IN THIS DRAWING IS THE SOLE PROPERTY OF BEGA NORTH AMERICA, INC. ANY REPRODUCTION IN PART OR AS A WHOLE WITHOUT THE WRITTEN PERMISSION OF BEGA NORTH AMERICA, INC. IS PROHIBITED.		SIZE B	PART NO. 79824	REV -
		NOT TO SCALE	8/7/2024	SHEET 2 OF 2