

| REV | CHANGED BY | DESCRIPTION | DATE |
|-----|------------|-------------|------|
| | | | |

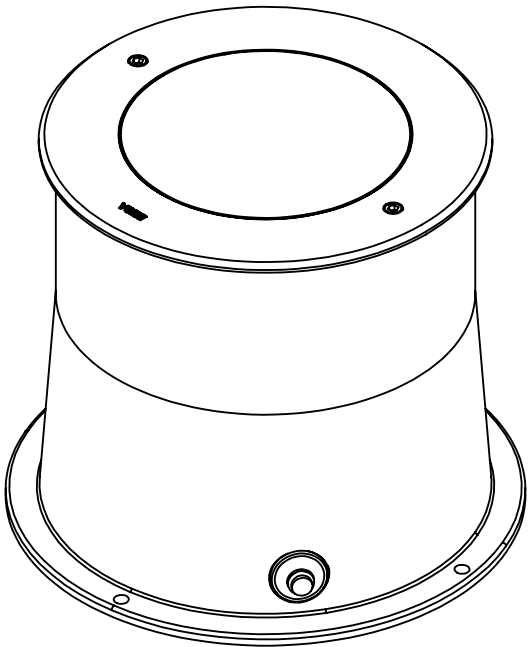
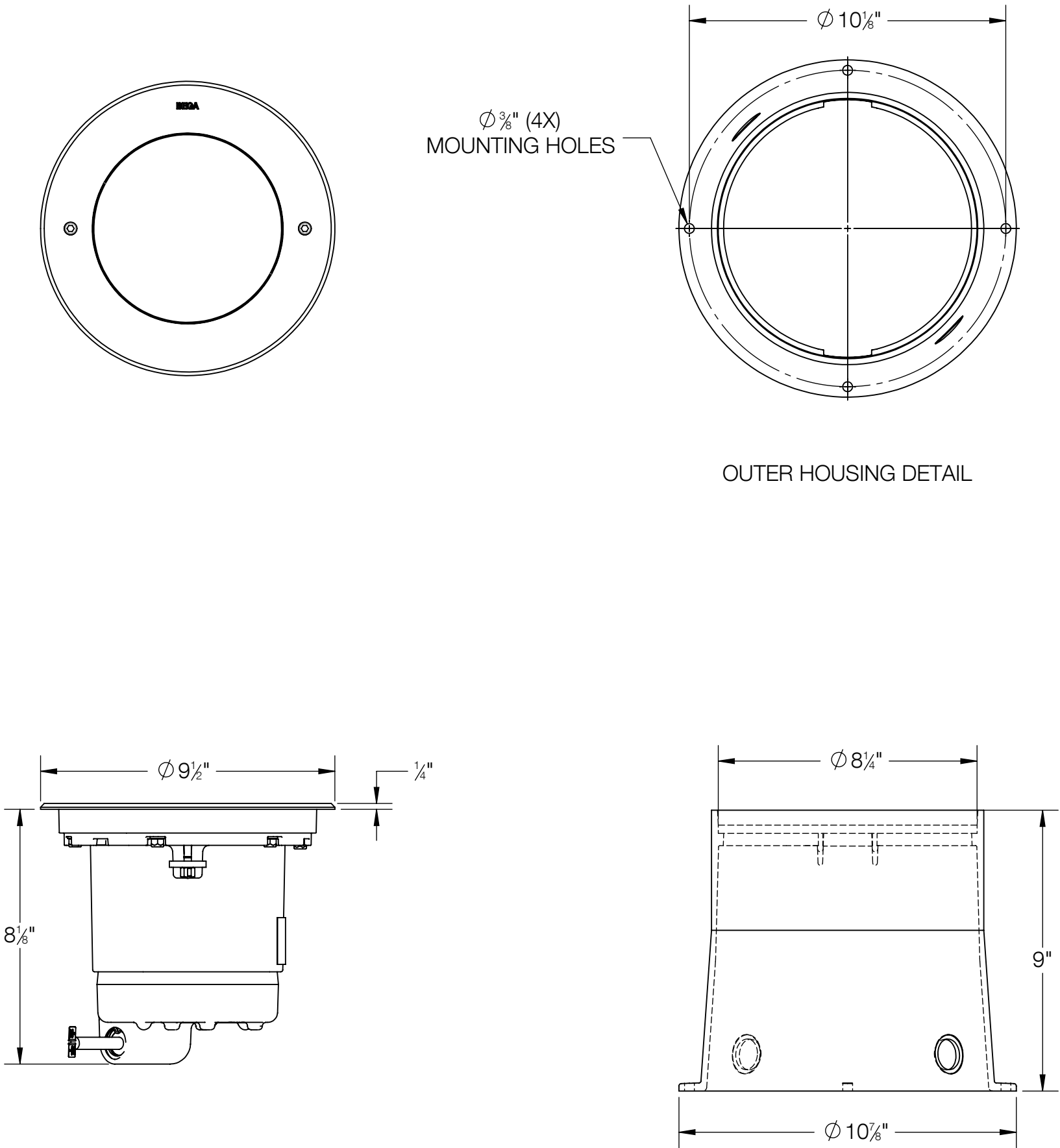

- NOTE:
- PROPER DRAINAGE REQUIRED BELOW THE OUTER HOUSING
 - DRIVE OVER APPLICATIONS REQUIRE FOUNDATION TO ACCOMDATE LUMINAIRE MAX LOAD OF (11,000lbs / 5,000KG)

| BEGA | | | | |
|--|--|---|------------------------------------|--------------|
| 1000 BEGA Way, Carpinteria, California 93013 | | | P (805) 684-0533 - www.bega-us.com | |
| APPROVED: _____ DATE: _____ | | DESCRIPTION: IN-GRADE LUMINAIRE - LOCATION LUMINAIRE | | |
| TYPE: _____ | | | | |
| PROPRIETARY AND CONFIDENTIAL THE INFORMATION CONTAINED IN THIS DRAWING IS THE SOLE PROPERTY OF BEGA NORTH AMERICA, INC. ANY REPRODUCTION IN PART OR AS A WHOLE WITHOUT THE WRITTEN PERMISSION OF BEGA NORTH AMERICA, INC. IS PROHIBITED. | | SIZE | PART NO. | REV |
| | | B | 84 454 | - |
| | | NOT TO SCALE | 05/24/2021 | SHEET 1 OF 1 |