

**Tools Required:**

5mm hex key  
Adjustable wrench

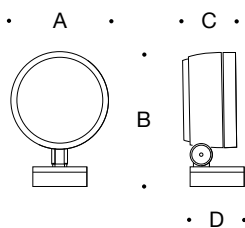

**Dimensions**

**A:** 9-7/8"  
**B:** 13-3/4"  
**C:** 5-1/2"  
**D:** 5-1/8"



**Protection Class:** IP65

**Weight:** 12.5 lbs.

**Notice to Installer for 84 544:**

1. See page 2 for specific product safety warnings.
2. In conformance with UL Standard 1598, a silicone based sealant must be used between luminaire and supporting surface.
3. Luminaire mounts directly to standard recessed 4" octagonal wiring (by others), using mounting plate provided

**84 544 - installation:**

1. Loosen the (1) 3mm hex screw on the fixture canopy to remove luminaire base.
2. Feed luminaire wiring through the luminaire base and mounting plate.
3. Make supply wiring and luminaire wiring connections inside the wiring box:  
MAIN VOLTAGE SUPPLY WIRE TO BLACK LUMINAIRE WIRE  
NEUTRAL (COMMON) SUPPLY WIRE TO WHITE LUMINAIRE WIRE  
GREEN GROUND WIRE TO GREEN LUMINAIRE WIRE  
Dimming (if applicable):  
DIMMING CONTROL WIRE (+) TO POSITIVE DRIVER DIM CONTROL WIRE  
DIMMING CONTROL WIRE (-) TO NEGATIVE DRIVER DIM CONTROL WIRE
4. Attach provided mounting plate directly to a 4" standard octagonal wiring box using the (2) screws (provided)(**Figure 2**).
5. Place a small bead of silicone around the back side of the mounting plate that will come in contact with the finished surface (exterior applications only).
6. Slip luminaire base over the mounting plate (**Figure 2**). Tighten nuts on the studs (provided) to secure.
7. Replace luminaire canopy (with luminaire attached) and align to desired orientation. Tighten (1) set screw to secure into place.
8. To adjust head angle, use 5mm hex key to loosen adjustment

**Figure 1**

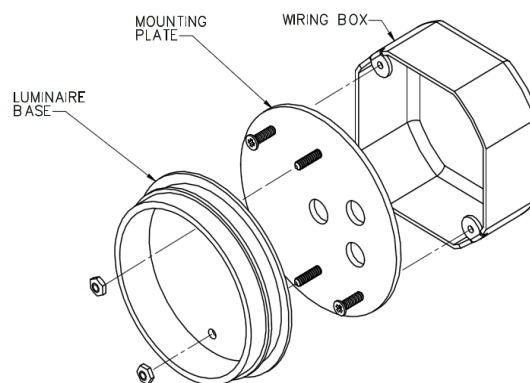

**Figure 2**

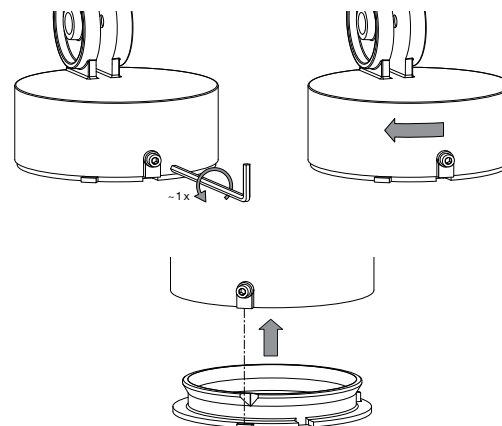

**Relamping/Maintenance**

Clean luminaire regularly with solvent-free cleansers from dirt and debris. Do not use high pressure cleaners.

**Lamp:** 72.9W LED

**Accessories**

Please refer to the appropriate accessory installation sheet for further instruction when applicable.

180 glare shield 71 072  
Flat beam lens 71 074

**Replacement Parts**

Description	Part No
LED Driver (120-277V)	(1X) 76134-1250
LED Module (2700K)	(1X) LED-0877/927
LED Module (3000K)	(1X) LED-0877/930
LED Module (3500K)	(1X) LED-0877/935
LED Module (4000K)	(1X) LED-0877/940

## Product Safety Warnings:

**THIS PRODUCT MUST BE INSTALLED IN ACCORDANCE WITH THE APPLICABLE INSTALLATION CODE BY A PERSON FAMILIAR WITH THE CONSTRUCTION AND OPERATION OF THE PRODUCT AND THE HAZARDS INVOLVED. SUITABLE FOR WET LOCATIONS.**

**MIN 90°C SUPPLY CONDUCTORS.**

**CE PRODUIT DOIT ÊTRE INSTALLÉ SELON LE CODE D'INSTALLATION PERTINENT, PAR UNE PERSONNE QUI CONNAÎT BIEN LE PRODUIT ET SON FONCTIONNEMENT AINSI QUE LES RISQUES INHÉRENTS. CONVIENT AUX EMPLACEMENTS MOUILLÉS.**

**LES FILS D'ALIMENTATION 90°C MIN.**

---