

MOUNTING DETAIL

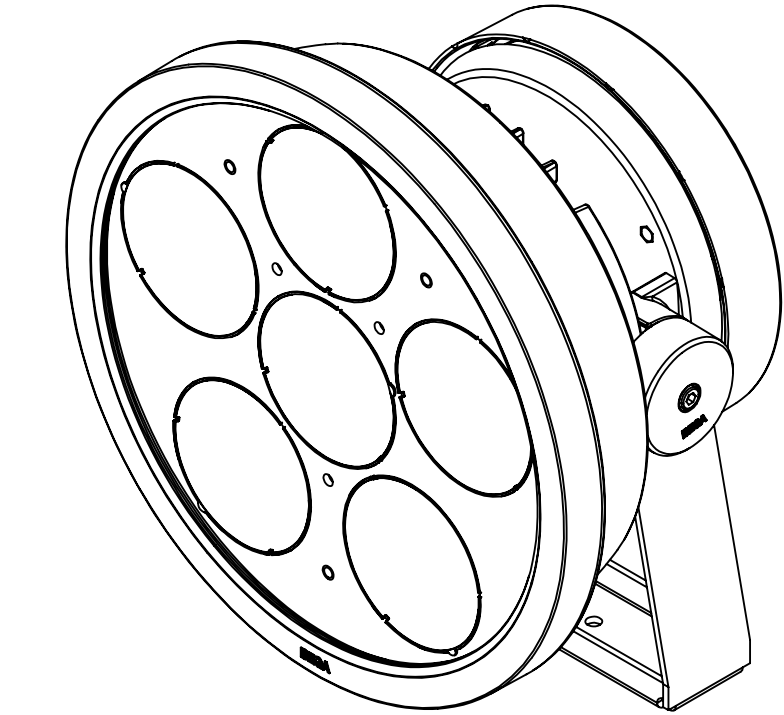

REV	CHANGED BY	DESCRIPTION	DATE

BEGA	
1000 BEGA Way, Carpinteria, California 93013	
P (805) 684-0533 - www.bega-us.com	
APPROVED: _____ DATE: _____	
DESCRIPTION: LARGE SCALE FLOODLIGHT - RGBW NARROW BEAM	
TYPE: _____	
PROPRIETARY AND CONFIDENTIAL	
THE INFORMATION CONTAINED IN THIS DRAWING IS THE SOLE PROPERTY OF BEGA NORTH AMERICA, INC.	
ANY REPRODUCTION IN PART OR AS A WHOLE WITHOUT THE WRITTEN PERMISSION OF BEGA NORTH AMERICA, INC. IS PROHIBITED.	
SIZE	PART NO.
B	84550
NOT TO SCALE	4/29/21
REV	-
SHEET 1 OF 2	

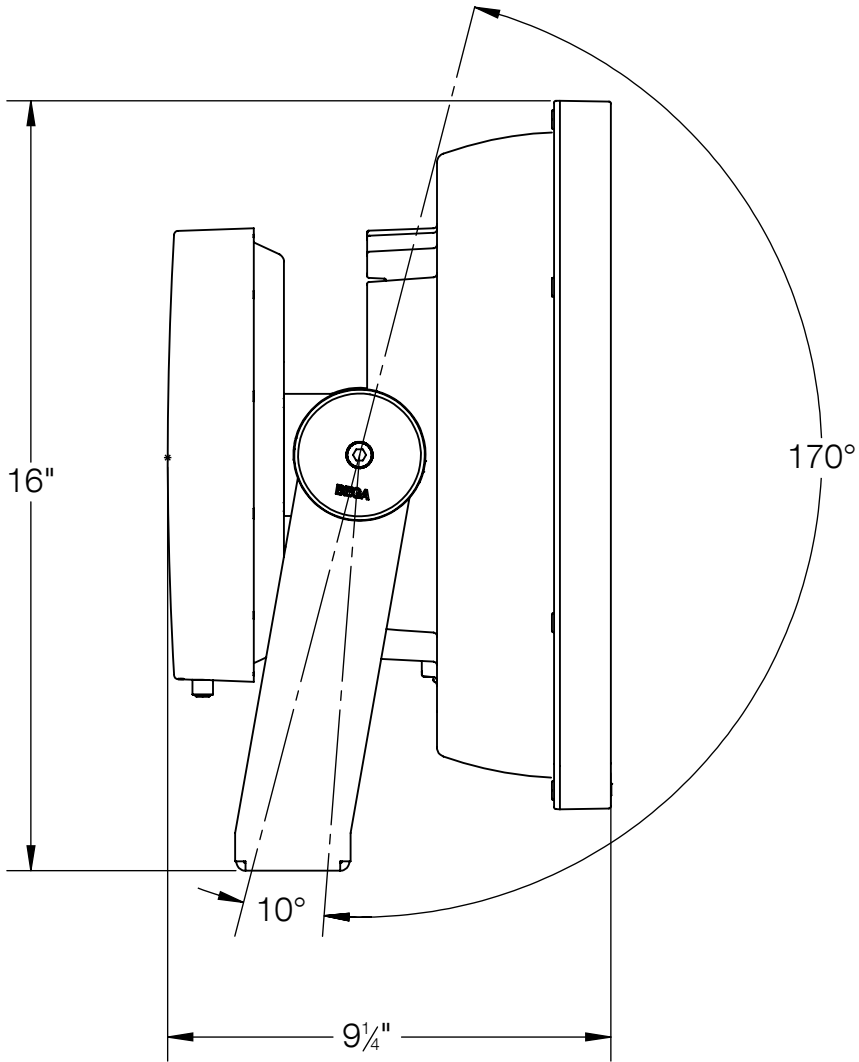
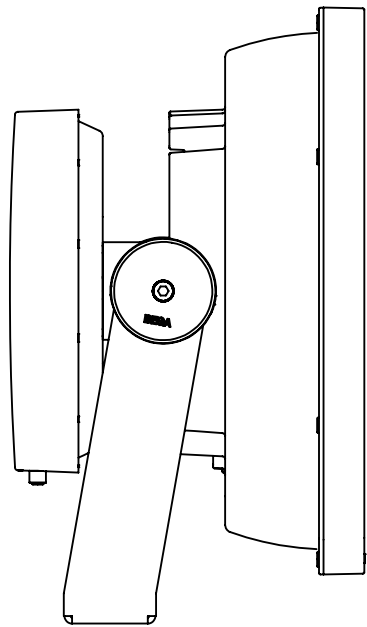
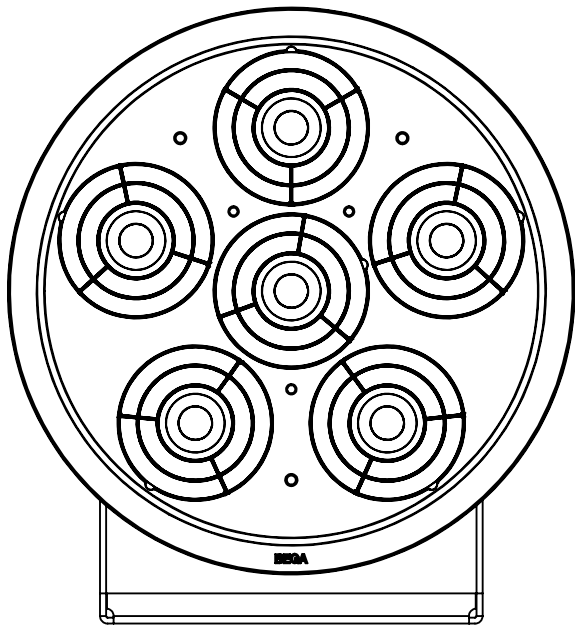

84550 SHOWN WITH 71109 - CONCENTRIC RING LOUVER

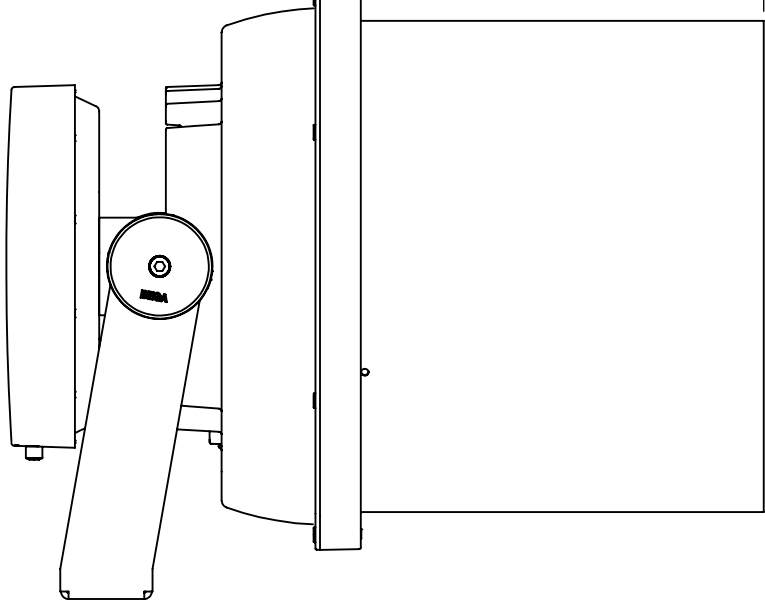
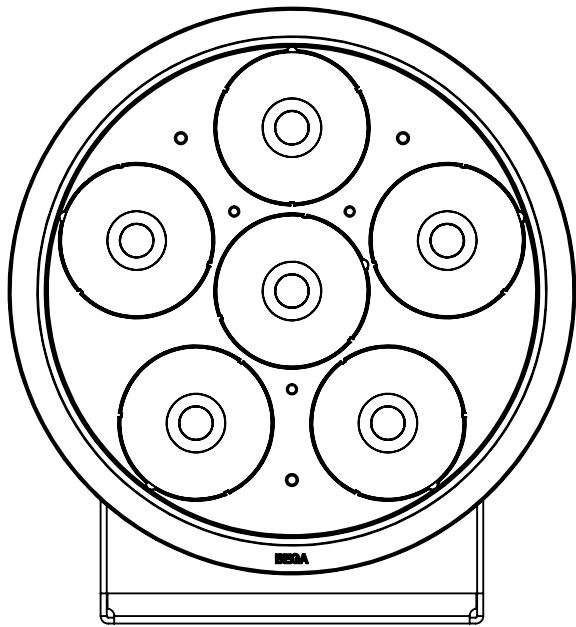

84550 SHOWN WITH 79510 - 360° GLARE SHIELD

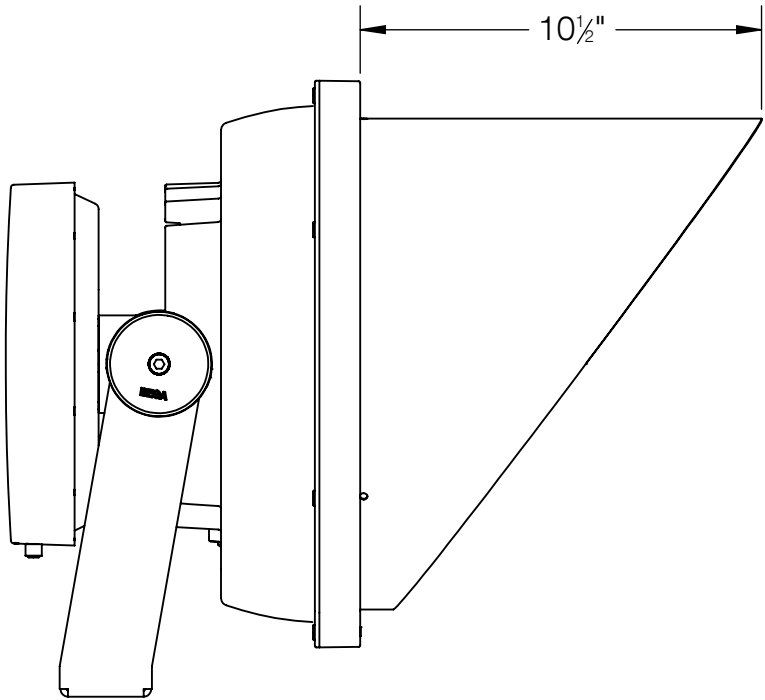
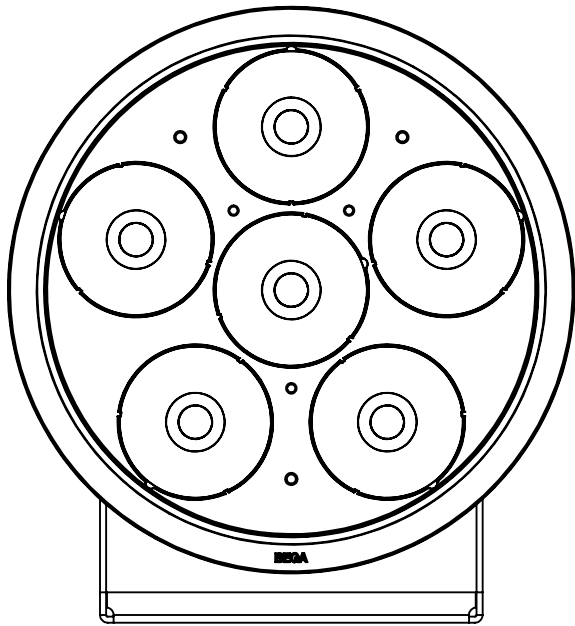

84550 SHOWN WITH 71110 - 180° GLARE SHIELD

REV	CHANGED BY	DESCRIPTION	DATE

BEGA			
1000 BEGA Way, Carpinteria, California 93013		P (805) 684-0533 - www.bega-us.com	
APPROVED: _____ DATE: _____		DESCRIPTION: LARGE SCALE FLOODLIGHT - RGBW NARROW BEAM	
TYPE: _____			
PROPRIETARY AND CONFIDENTIAL THE INFORMATION CONTAINED IN THIS DRAWING IS THE SOLE PROPERTY OF BEGA NORTH AMERICA, INC. ANY REPRODUCTION IN PART OR AS A WHOLE WITHOUT THE WRITTEN PERMISSION OF BEGA NORTH AMERICA, INC. IS PROHIBITED.		SIZE B	REV -
		PART NO. 84550	
NOT TO SCALE		4/29/21	SHEET 2 OF 2