

DIRECTION OF ILLUMINATION

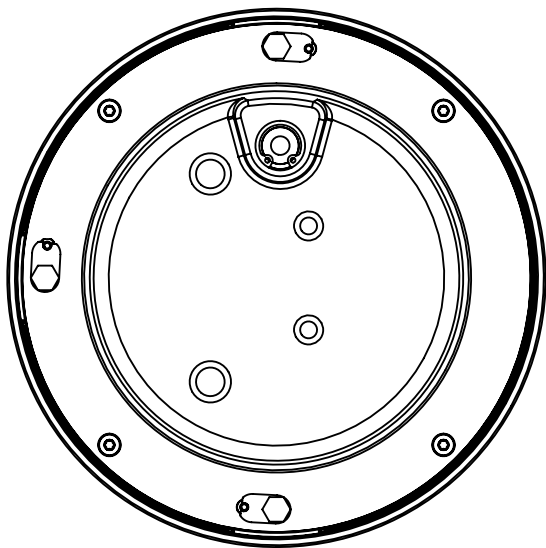

- NOTES:
1. INCLUDED: KIT #40 WATERPROOF CONNECTOR KIT
  2. INCLUDED: BB84618 INSTALLATION HOUSING

REV	CHANGED BY	DESCRIPTION	DATE

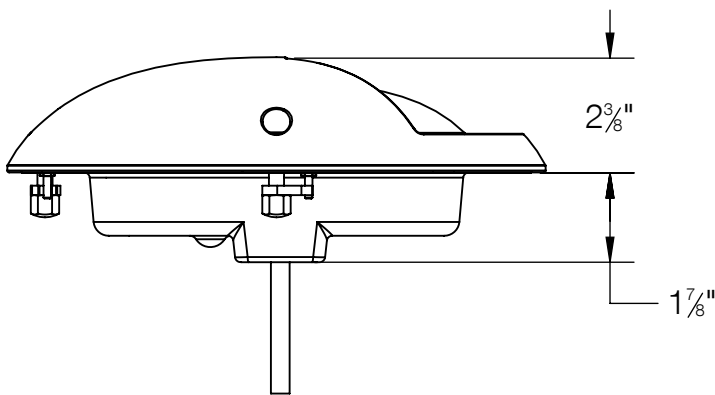
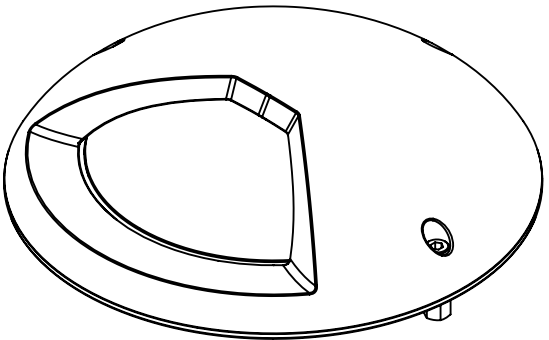

**BEGA**

1000 BEGA Way, Carpinteria, California 93013 P (805) 684-0533 - [www.bega-us.com](http://www.bega-us.com)

APPROVED: \_\_\_\_\_ DATE: \_\_\_\_\_ DESCRIPTION:  
TYPE: \_\_\_\_\_ IN-GRADE FLOODLIGHT - WALL WASHER

PROPRIETARY AND CONFIDENTIAL THE INFORMATION CONTAINED IN THIS DRAWING IS THE SOLE PROPERTY OF BEGA NORTH AMERICA, INC. ANY REPRODUCTION IN PART OR AS A WHOLE WITHOUT THE WRITTEN PERMISSION OF BEGA NORTH AMERICA, INC. IS PROHIBITED.	SIZE	PART NO.	REV
	B	84618	-
NOT TO SCALE		10/30/2020	SHEET 1 OF 2

REV	CHANGED BY	DESCRIPTION	DATE

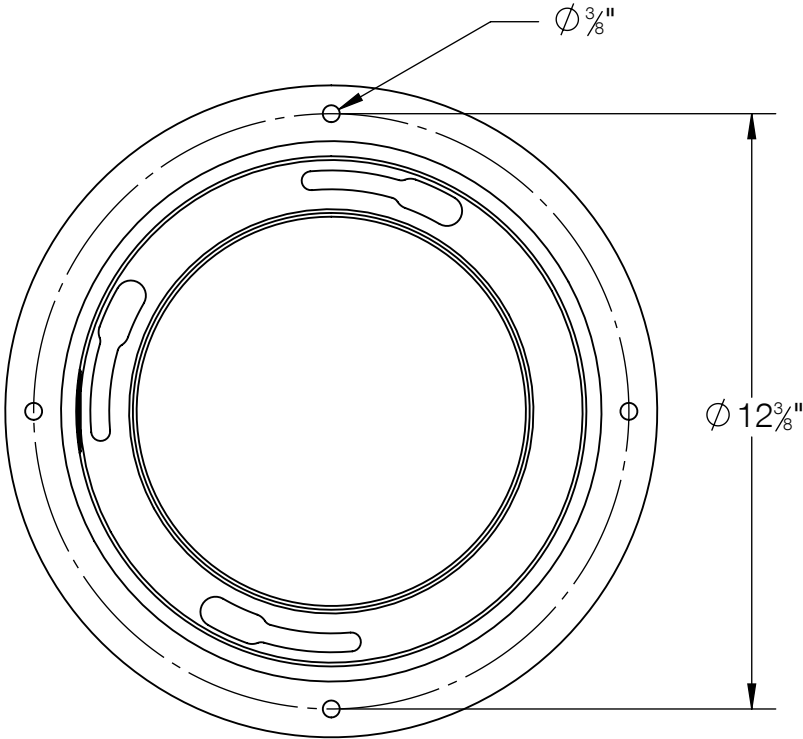
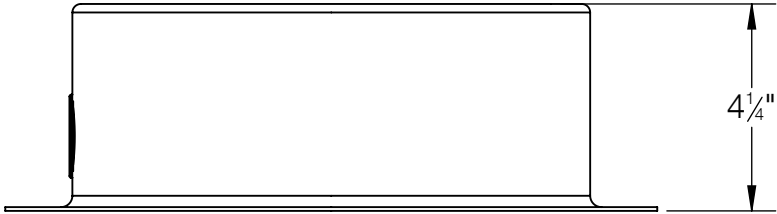
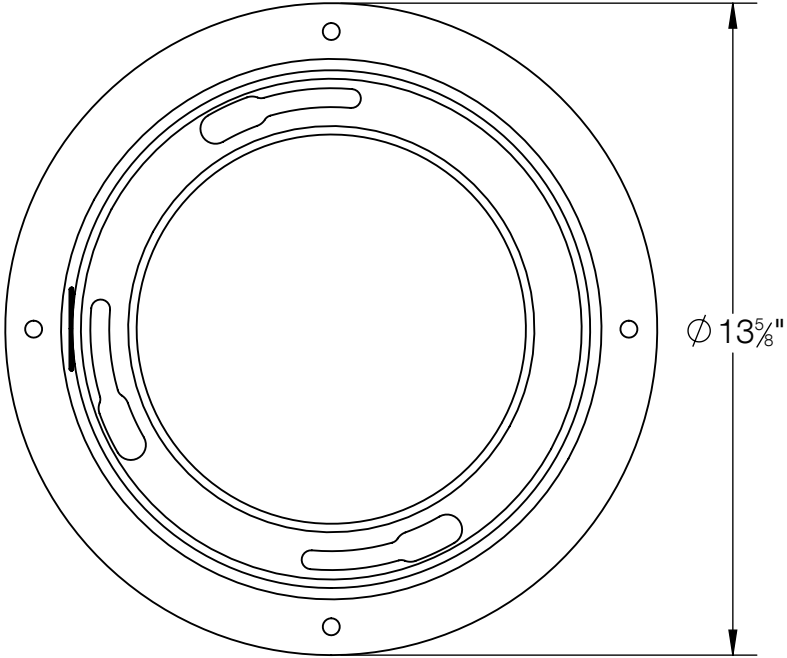

DIRECTION OF ILLUMINATION

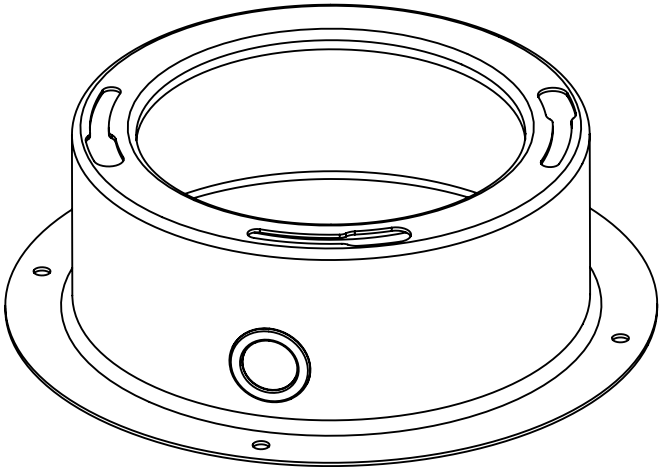
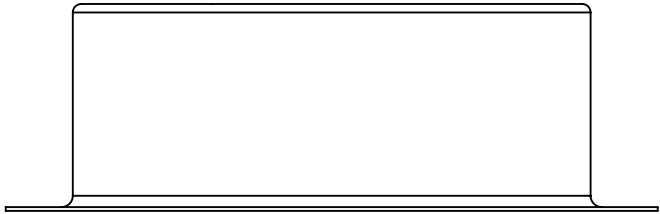
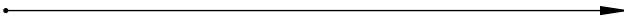

- NOTES:
1. INCLUDED: KIT #40 WATERPROOF CONNECTOR KIT
  2. INCLUDED: BB84618 INSTALLATION HOUSING

**BEGA**

1000 BEGA Way, Carpinteria, California 93013 P (805) 684-0533 - [www.bega-us.com](http://www.bega-us.com)

APPROVED: \_\_\_\_\_ DATE: \_\_\_\_\_  
TYPE: \_\_\_\_\_

DESCRIPTION:  
INSTALLATION HOUSING

PROPRIETARY AND CONFIDENTIAL  
THE INFORMATION CONTAINED IN THIS DRAWING IS THE SOLE PROPERTY  
OF BEGA NORTH AMERICA, INC.  
ANY REPRODUCTION IN PART OR AS A WHOLE WITHOUT THE WRITTEN  
PERMISSION OF BEGA NORTH AMERICA, INC. IS PROHIBITED.

SIZE	PART NO.	REV
B	BB84618	-
NOT TO SCALE	10/30/2020	SHEET 2 OF 2