

**Tools Required:**

- 3mm hex head screwdriver
- 5mm hex head screwdriver
- 6mm hex head screwdriver
- Special tool (provided by BEGA)
- Phillips head screwdriver

**Overview:**

LED Watts: 20.4W  
 System Watts: 24.0W  
 Controllability: 0-10V, TRAIC, and ELV dimmable  
 Weight: 116.8 lbs.  
 Protection Class: IP65

**Notice to Installer:**

1. See page 3 for specific product safety warnings.
2. See page 2 for instructions for adjustable floodlight.
3. Fixture may be damaged if connected to conduit systems that contain water - Article 300-5G of the National Electric Code requires that "Conduits or raceways through which moisture may contact energized live parts shall be sealed or plugged at either or both ends."
4. System elements ship in multiple parts, the head and pole will be in separate boxes.
5. Adequate foundation must be provided for intended loading. Size of footing depends on the topography, soil composition, and wind load and must be determined by a structural engineer on site. Adequate drainage must be provided in sub base. System element pole suitable for direct burial only.
6. **WARNING: DO NOT INSTALL SYSTEM ELEMENT POLE WITHOUT SYSTEM ELEMENT HEAD. UNLOADED POLES CAN EXPERIENCE EXCESSIVE VIBRATION, CAUSING THE STRUCTURAL INTEGRITY TO BE COMPROMISED. INSTALLING THE POLE WITHOUT THE HEAD WILL VOID WARRANTY.**
7. SUITABLE FOR INSTALLATION IN WIND ZONES WITH A MAXIMUM WIND SPEED UP TO 100 MPH PER EN 60598.

**84722 pole installation:**

1. System elements ship in multiple parts. Have system element head ready to install, or assemble head and pole together before erecting pole. Do not install pole without element head. See steps 2-4 and element head installation for additional details.
2. Drop wire bundle and flexible conduit into system element pole for wiring connections to be made at base.
3. Insert building element head into building element pole.
4. Secure building element head to pole by tightening (3) 5mm hex head set screw located on the pole. System element heads are fully rotatable on element pole. Asymmetric light output heads will ship with removable aiming label.
5. Remove the anchor plate from the inside of base of the element pole. Attach plate to bottom of pole by tightening (2) 5mm hex head screws. Anchor plate is designed to help provide stability and prevent rotation during installation only. See Figure 2.
6. Align and level pole. Attach pole with anchor plate to sub base using hardware by others.
7. Bring in conduit through conduit entry in anchor base up to access door for connections to be made later.
8. Bury pole and finish surface. Minimum burial depth is 39-1/2".
9. Wiring connections are accessible behind the access door on the system element pole. Access door can only be opened using special tool (provided).  
 Make supply wiring and cable connections behind access door:  
 MAIN VOLTAGE SUPPLY WIRE TO BLACK LUMINAIRE WIRE  
 NEUTRAL (COMMON) SUPPLY WIRE TO WHITE LUMINAIRE WIRE  
 GREEN (GROUND) WIRE TO GREEN LUMINAIRE WIRE  
 0-10V DIMMING (OR DALI DIMMING) IF APPLICABLE  
 DIMMING CONTROL (+) TO POSITIVE LUMINAIRE CONTROL WIRE  
 DIMMING CONTROL (-) TO NEGATIVE LUMINAIRE CONTROL WIRE
9. Additional grounding is required - connect ground supply wire to both green luminaire wire and green grounding lug located on the din rail behind the access door in element pole.
10. Close access door.

**Accessories**

Please refer to the appropriate accessory installation sheet for further instruction when applicable.

**Maintenance:**

Clean regularly with solvent-free cleaner removing dirt and debris. Do not use high pressure cleaners.

**Replacement Parts**

See label inside of fixture for LED replacement part number.

Consult factory for all other replacement components.

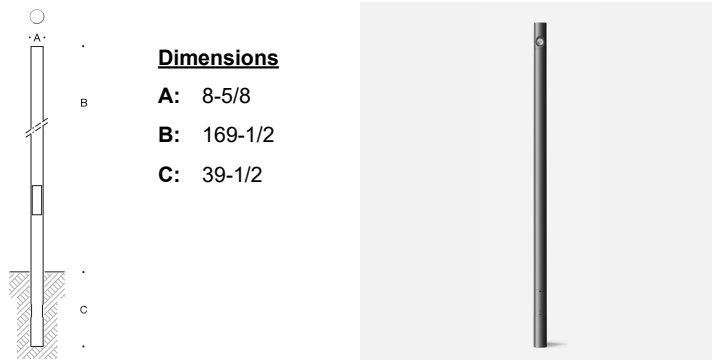

**Figure 1:**

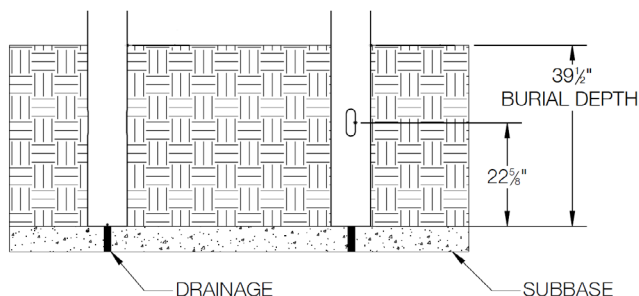

**Figure 2:**

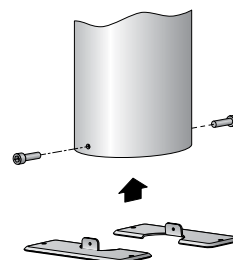

**Tools Required:**

- 3mm hex head screwdriver
- 5mm hex head screwdriver
- 6mm hex head screwdriver
- Special tool (provided by BEGA)
- Phillips head screwdriver

**Overview:**

LED Watts: 20.4W  
 System Watts: 24.0W  
 Controllability: 0-10V, TRAIC, and ELV dimmable  
 Weight: 116.8 lbs.  
 Protection Class: IP65

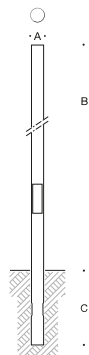

**Dimensions**

A: 8-5/8  
 B: 169-1/2  
 C: 13-3/8



**Notice to Installer:**

1. See page 3 for specific product safety warnings.
2. See page 2 for instructions for adjustable floodlight.
3. Fixture may be damaged if connected to conduit systems that contain water - Article 300-5G of the National Electric Code requires that "Conduits or raceways through which moisture may contact energized live parts shall be sealed or plugged at either or both ends."
4. System elements ship in multiple parts, the head and pole will be in separate boxes.
5. Adequate foundation must be provided for intended loading. Size of footing depends on the topography, soil composition, and wind load and must be determined by a structural engineer on site. Adequate drainage must be provided in concrete foundation or grout.
6. **WARNING: DO NOT INSTALL SYSTEM ELEMENT POLE WITHOUT SYSTEM ELEMENT HEAD. UNLOADED POLES CAN EXPERIENCE EXCESSIVE VIBRATION, CAUSING THE STRUCTURAL INTEGRITY TO BE COMPROMISED. INSTALLING THE POLE WITHOUT THE HEAD WILL VOID WARRANTY.**
7. SUITABLE FOR INSTALLATION IN WIND ZONES WITH A MAXIMUM WIND SPEED UP TO 100 MPH PER EN 60598.

**84722 floodlight installation:**

1. System elements ship in multiple parts. Have system element head ready to install, or assemble head and pole together before erecting pole. Do not install pole without element head. If floodlight segment and aluminum pole shipped separately, follow steps 2-5.
2. Separate the floodlight segment from the clamping ring as shown in Figure 1, loosening the (2) 6mm hex head screws located inside the tube.
3. Insert the clamping ring, as shown in Figure 2, into the upper opening of the building element pole and align accordingly. Arrows on the clamping ring indicate the floodlight direction.
4. Place the floodlight over the clamping ring as shown in Figure 1, and secure into place by tightening the (2) 6mm hex head screws.
5. The driver for the floodlight is located in a gasketed box on the din rail located behind the access door. There is a 15', 18/2 cable that connects the driver and the floodlight assembly, this wiring connection is made inside the box. If access to these connections is required, open gasketed box using a Phillips head screwdriver. Supply wiring connections will be made in the pole, behind the access door.
6. Floodlight wiring connections are accessible behind the access door on the system element pole. Access door can only be opened using special tool (provided).  
 Make supply wiring and cable connections behind access door:  
 MAIN VOLTAGE SUPPLY WIRE TO BLACK LUMINAIRE WIRE  
 NEUTRAL (COMMON) SUPPLY WIRE TO WHITE LUMINAIRE WIRE  
 GREEN (GROUND) WIRE TO GREEN LUMINAIRE WIRE  
 0-10V DIMMING (OR DALI DIMMING) IF APPLICABLE  
 DIMMING CONTROL (+) TO POSITIVE LUMINAIRE CONTROL WIRE  
 DIMMING CONTROL (-) TO NEGATIVE LUMINAIRE CONTROL WIRE
7. Additional grounding is required - connect ground supply wire to both green luminaire wire and green grounding lug located on the din rail behind the access door in element pole.
8. Close access door.
9. To aim floodlight, loosen (2) 3mm hex head screws above and below the floodlight to loosen the gimbal assembly. Floodlight can be aimed up to 30°. Tighten screws to lock into place.

**Figure 1:**

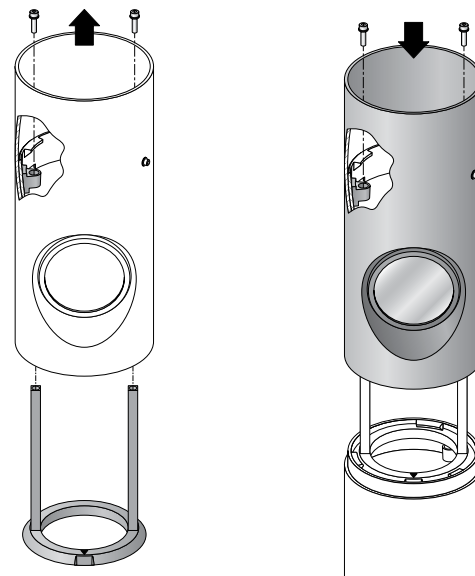

**Figure 2:**

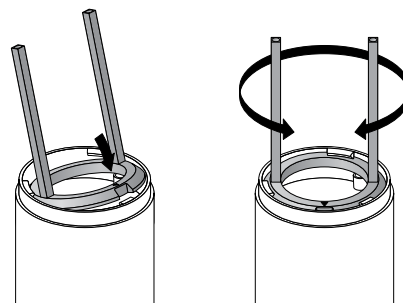

**Accessories**

Please refer to the appropriate accessory installation sheet for further instruction when applicable.

**Maintenance:**

Clean regularly with solvent-free cleaner removing dirt and debris. Do not use high pressure cleaners.

**Replacement Parts**

See label inside of fixture for LED replacement part number.

Consult factory for all other replacement components.

**Product Safety Warnings:**

**THIS PRODUCT MUST BE INSTALLED IN ACCORDANCE WITH THE APPLICABLE INSTALLATION CODE BY A PERSON FAMILIAR WITH THE CONSTRUCTION AND OPERATION OF THE PRODUCT AND THE HAZARDS INVOLVED. SUITABLE FOR MOUNTING WITHIN 1.2 m (4 ft) OF THE GROUND. SUITABLE FOR WET LOCATIONS. MIN 60°C SUPPLY CONDUCTORS.**

**CE PRODUIT DOIT ÊTRE INSTALLÉ SELON LE CODE D'INSTALLATION PERTINENT, PAR UNE PERSONNE QUI CONNAÎT BIEN LE PRODUIT ET SON FONCTIONNEMENT AINSI QUE LES RISQUES INHÉRENTS. PEUT ÊTRE INSTALLÉ À MOINS DE 1,2 m (4 pi) DU SOL. CONVIENT AUX EMPLACEMENTS MOUILLÉS. LES FILS D'ALIMENTATION 60°C MIN.**