

REV	CHANGED BY	DESCRIPTION	DATE

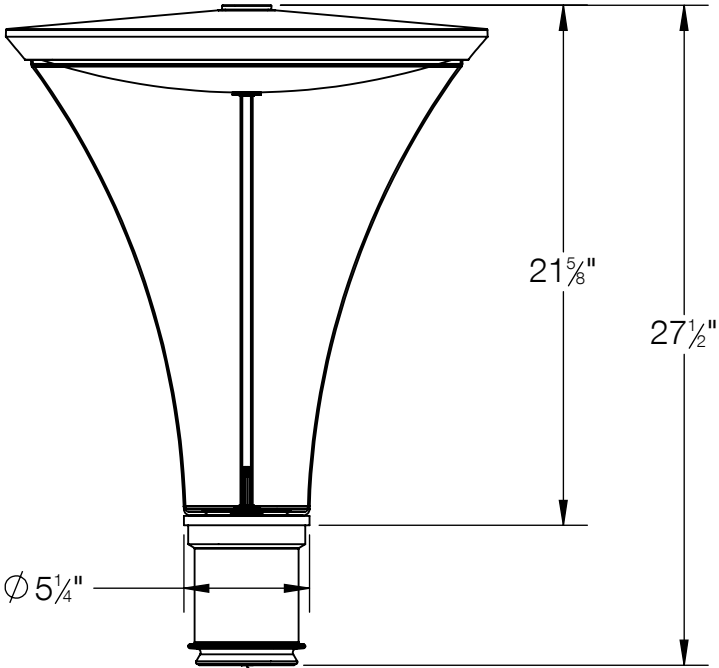

HEAD PROVIDED
WITH 15' FLEXIBLE
CONDUIT AND 25'
WIRE BUNDLE

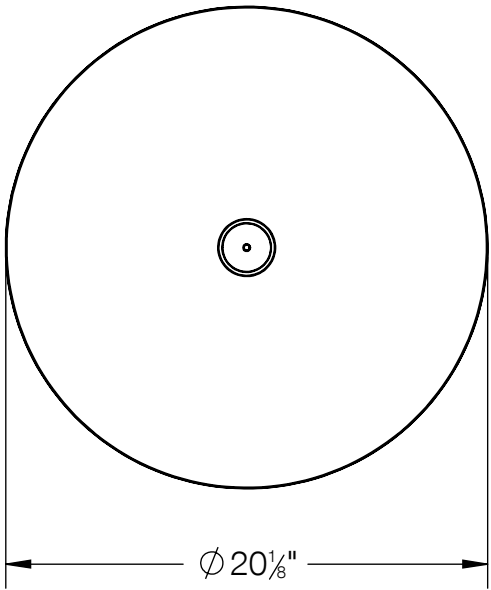
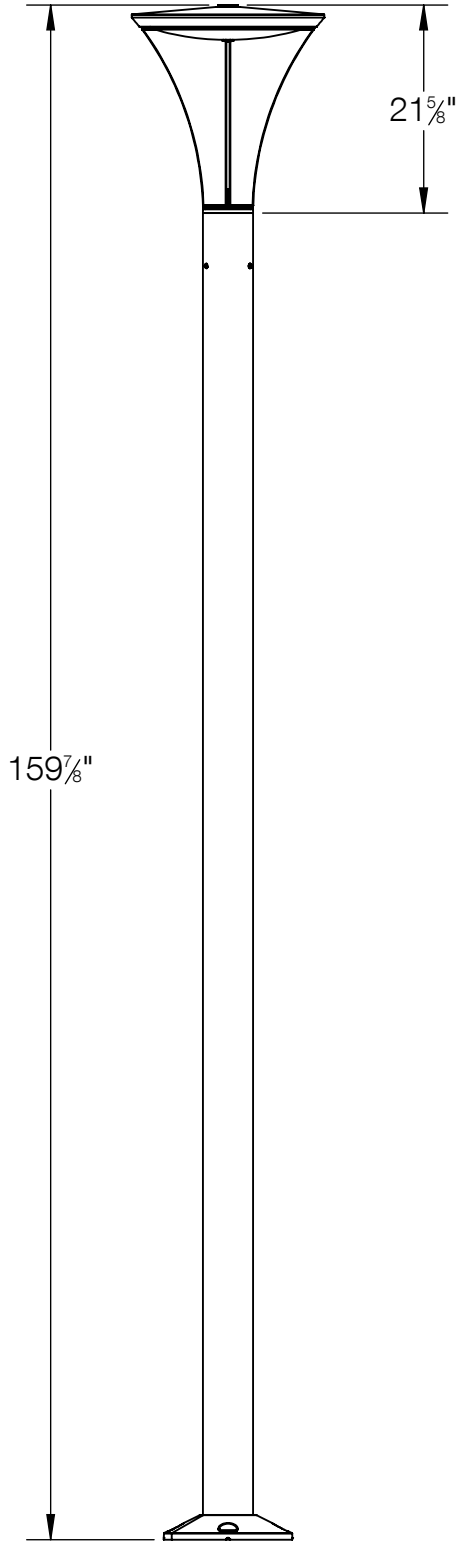

84735 SYSTEM BUILDING ELEMENT HEAD
SHOWN ON SYSTEM BUILDING ELEMENT
POLE 84709 (NOT TO SCALE, POLE SOLD
SEPERATELY)

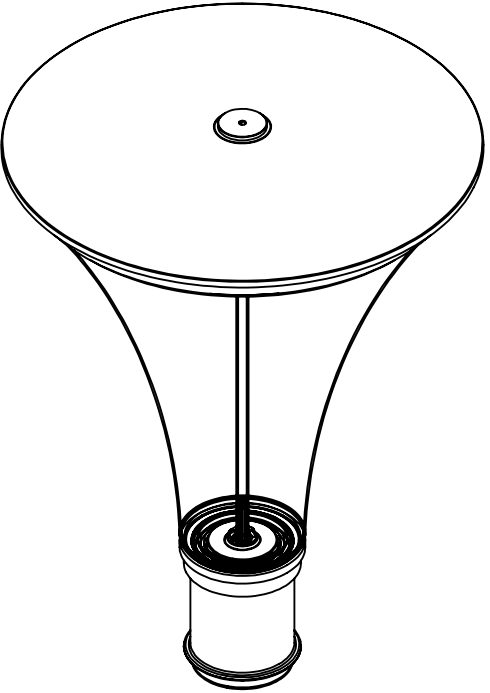

NOTES:
1. SYSTEM BUILDING ELEMENT HEAD FOR USE WITH
SYSTEM BUILDING ELEMENT POLE ONLY. SEE
WEBSITE FOR COMPATIBLE POLE OPTIONS.

BEGA				
1000 BEGA Way, Carpinteria, California 93013			P (805) 684-0533 - www.bega-us.com	
APPROVED: _____ DATE: _____		DESCRIPTION: SYSTEM BUILDING ELEMENT HEAD - SYMMETRIC		
TYPE: _____				
PROPRIETARY AND CONFIDENTIAL THE INFORMATION CONTAINED IN THIS DRAWING IS THE SOLE PROPERTY OF BEGA NORTH AMERICA, INC. ANY REPRODUCTION IN PART OR AS A WHOLE WITHOUT THE WRITTEN PERMISSION OF BEGA NORTH AMERICA, INC. IS PROHIBITED.		SIZE	PART NO.	REV
		B	84735	-
		NOT TO SCALE	3/13/2025	SHEET 1 OF 1