

REV	CHANGED BY	DESCRIPTION	DATE

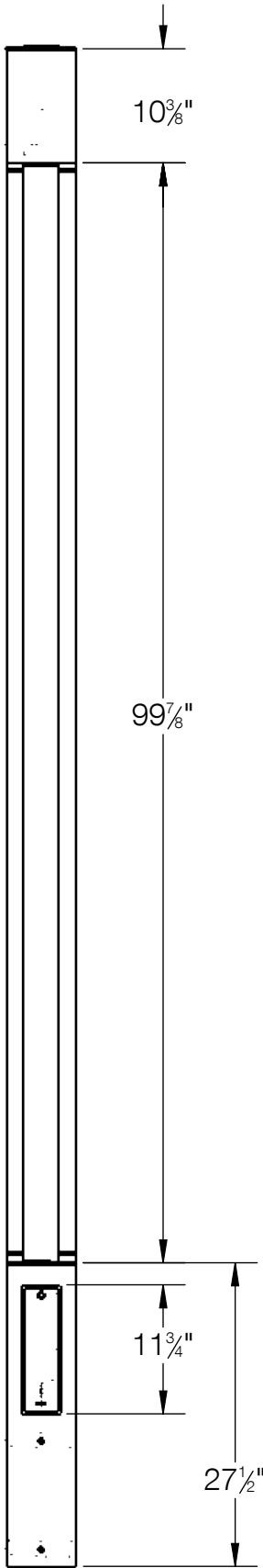

- NOTE:
- 1. SEE PAGE 2 FOR ANCHOR BASE DETAILS
 - 2. SEE PAGE 3 FOR DIRECT BURIAL DETAILS

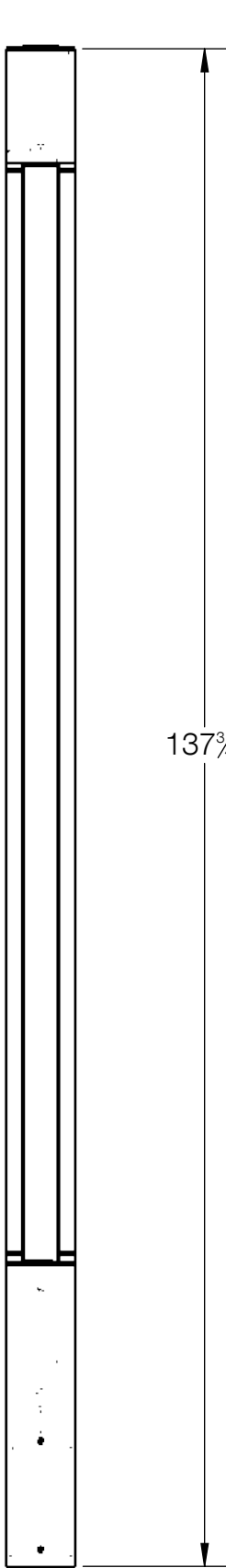
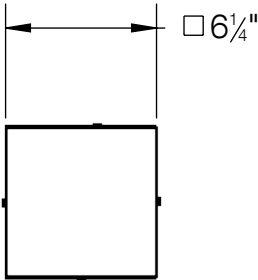

TOP VIEW

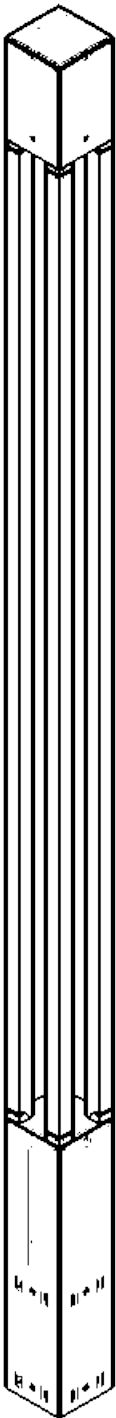

BEGA				
1000 BEGA Way, Carpinteria, California 93013			P (805) 684-0533 - www.bega-us.com	
APPROVED: _____		DATE: _____		DESCRIPTION: BUILDING ELEMENT - SYMMETRIC
TYPE: _____				
PROPRIETARY AND CONFIDENTIAL THE INFORMATION CONTAINED IN THIS DRAWING IS THE SOLE PROPERTY OF BEGA NORTH AMERICA, INC. ANY REPRODUCTION IN PART OR AS A WHOLE WITHOUT THE WRITTEN PERMISSION OF BEGA NORTH AMERICA, INC. IS PROHIBITED.		SIZE B	PART NO. 84754	REV -
		NOT TO SCALE	10/03/2022	SHEET 1 OF 3

REV	CHANGED BY	DESCRIPTION	DATE

NOTE:

- 1. ANCHORAGE PROVIDED WITH (4) ANCHOR BOLTS
- 2. LUMINAIRE INSERTION DEPTH OF 13"
- 3. FINISHED FLOOR MUST HAVE A MINIMUM HEIGHT OF 3-7/8"

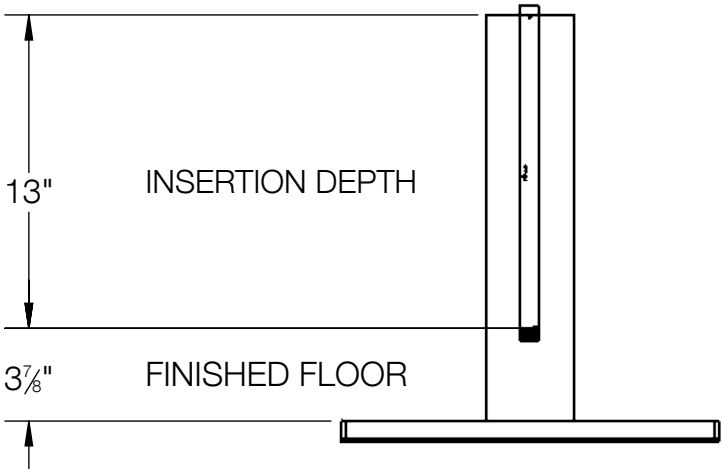
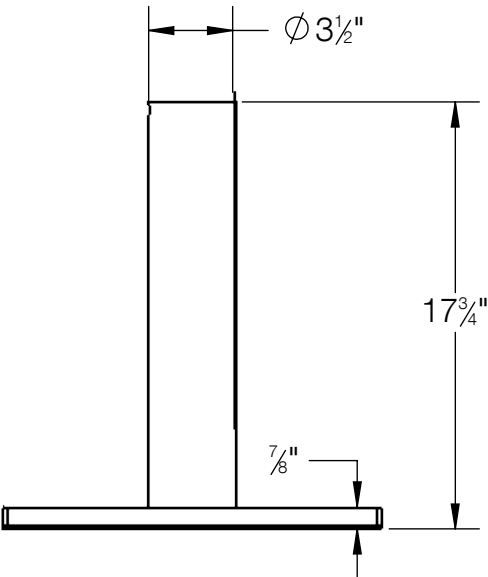
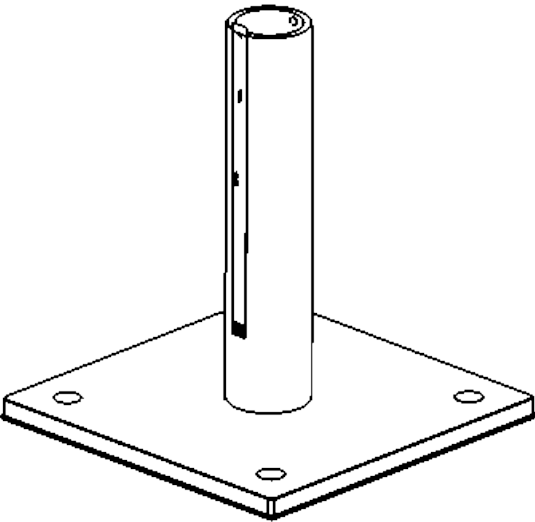
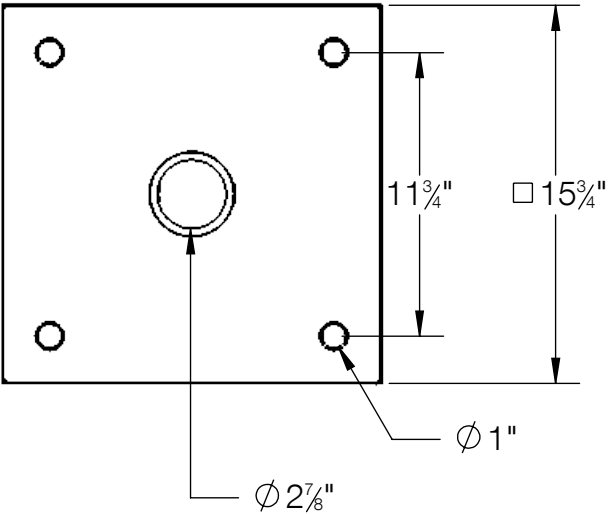

BEGA

1000 BEGA Way, Carpinteria, California 93013 P (805) 684-0533 - www.bega-us.com

APPROVED: _____ DATE: _____
TYPE: _____

DESCRIPTION:
ANCHOR BASE ANCHORAGE

PROPRIETARY AND CONFIDENTIAL
THE INFORMATION CONTAINED IN THIS DRAWING IS THE SOLE PROPERTY
OF BEGA NORTH AMERICA, INC.
ANY REPRODUCTION IN PART OR AS A WHOLE WITHOUT THE WRITTEN
PERMISSION OF BEGA NORTH AMERICA, INC. IS PROHIBITED.

SIZE B	PART NO. 79827	REV -
NOT TO SCALE	10/03/2022	SHEET 2 OF 3

REV	CHANGED BY	DESCRIPTION	DATE

- NOTE:
- 1. LUMINAIRE INSERTION DEPTH OF 13"
 - 2. 16-7/8" OF ANCHORAGE MUST PROTRUDE ABOVE GRADE
 - 3. FINISHED FLOOR MUST HAVE A MINIMUM HEIGHT OF 3-7/8"

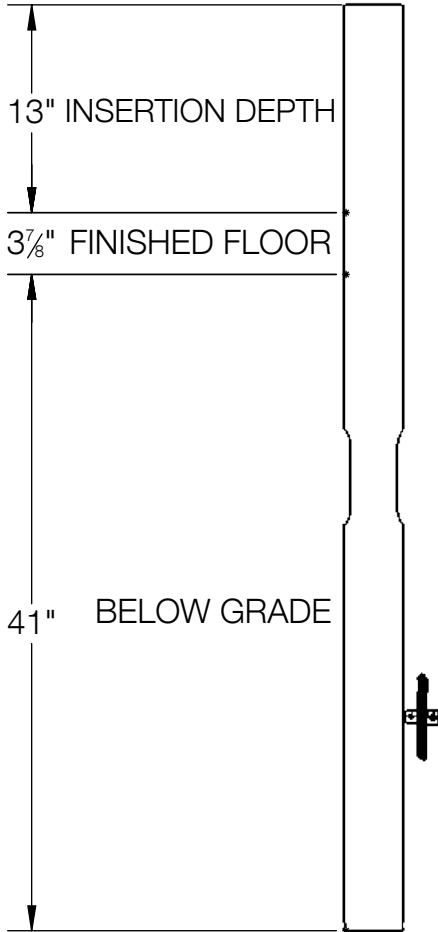
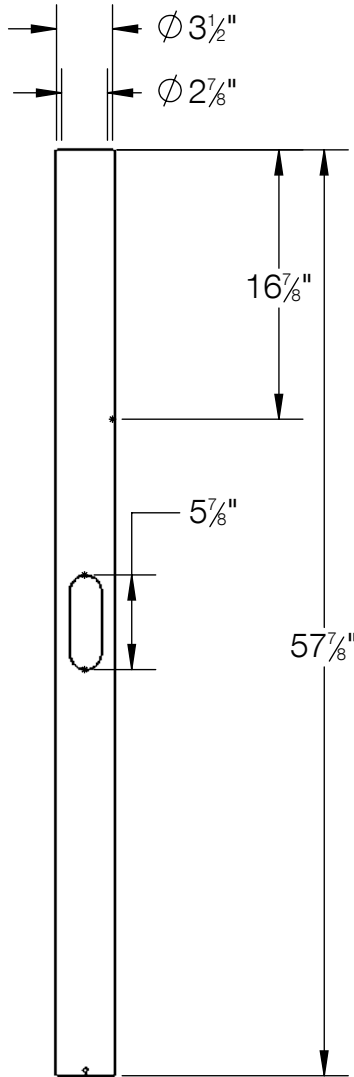

BEGA

1000 BEGA Way, Carpinteria, California 93013 P (805) 684-0533 - www.bega-us.com

APPROVED: _____ DATE: _____
TYPE: _____

DESCRIPTION:
DIRECT BURIAL ANCHORAGE

PROPRIETARY AND CONFIDENTIAL
THE INFORMATION CONTAINED IN THIS DRAWING IS THE SOLE PROPERTY
OF BEGA NORTH AMERICA, INC.
ANY REPRODUCTION IN PART OR AS A WHOLE WITHOUT THE WRITTEN
PERMISSION OF BEGA NORTH AMERICA, INC. IS PROHIBITED.

SIZE B	PART NO. 71207	REV -
NOT TO SCALE	10/03/2022	SHEET 3 OF 3