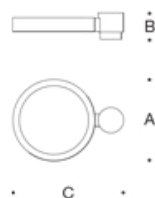

**Tools Required:**

4mm hex key  
Adjustable wrench

CSA certified to U.S. and Canadian standards.  
Suitable for wet locations.

**Dimensions**

**A:** 18-1/2"  
**B:** 2-3/8"  
**C:** 44-1/3"



**Protection Class:** IP65

**Weight:** 40.0 lbs.

**Notice to Installer for 99 408:**

1. See page 2 for specific product safety warnings.
2. For pole top applications only.
3. Slip fits 3" O.D. poles only.
4. Pole inner dimension 2-5/16" MINIMUM.
5. LED module and integral driver provided by BEGA.
6. Pole top luminaire supplied with 35 feet of cable to route through pole.
7. Do NOT remove moisture absorption packet from luminaire housing.

**99 408- installation:**

1. Loosen hex screw on pole cap and remove pole cap.
2. Lead luminaire wires into top of pole and through to the base.
3. Secure luminaire head to pole by tightening 13mm hex nut to engage pole fitter expansion mechanism (See Figure). Torque - 8.85 ft-lb MAXIMUM.  
Note: IF TORQUE ALLOWANCE IS EXCEEDED POLE FITTER CAN BE DAMAGED AND LUMINAIRE WARRANTY WILL BE VOID.
4. Secure outer 4mm set screw on luminaire housing.
5. To adjust beam direction (up to 15 degrees), undo hex nut and adjust joint (see figure). Be sure teeth are secured into position. BE CAREFUL AS THE FIXTURE WILL DROP QUICKLY UPON LOOSENING.
6. Replace slip fitter cap and tighten cap hex screw.
7. Make supply wiring and luminaire wiring connections inside pole base:  
MAIN VOLTAGE SUPPLY WIRE TO BLACK LUMINAIRE WIRE  
NEUTRAL (COMMON) SUPPLY WIRE TO WHITE LUMINAIRE WIRE  
GREEN GROUND WIRE TO GREEN LUMINAIRE WIRE  
Dimming (if applicable):  
DIMMING CONTROL WIRE (+) TO POSITIVE LUMINAIRE DIM CONTROL WIRE  
DIMMING CONTROL WIRE (-) TO NEGATIVE LUMINAIRE DIM CONTROL WIRE

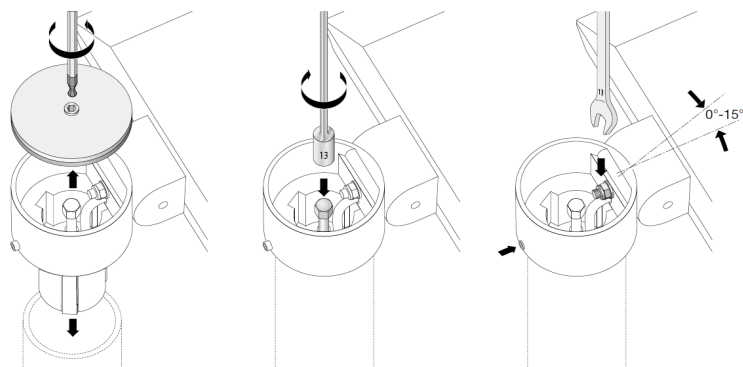
**Relamping/Maintenance**

No relamping necessary.

**Accessories**

Please refer to the appropriate accessory installation sheet for further instruction when applicable.

**Replacement Parts**

Description	Part No
Gasket (2x)	831473
Driver (120-277V)(2x)	75985-03
LED (3000K)(2x)	LED-0469/830
	LED-0472/830
LED (4000K)(2x)	LED-0469/840
	LED-0472/840

**Lamp:** (2) 23.6 W LED

In the interest of product improvement, BEGA reserves the right to make technical changes without notice.