

NOTE: LUMINAIRE # 99 529 – SEE SPECIFICATIONS

LUMINAIRE SLIP-FITS
OVER 3" O.D. POLES WITH MINIMUM
INNER DIMENSION OF 2-5/16" ONLY

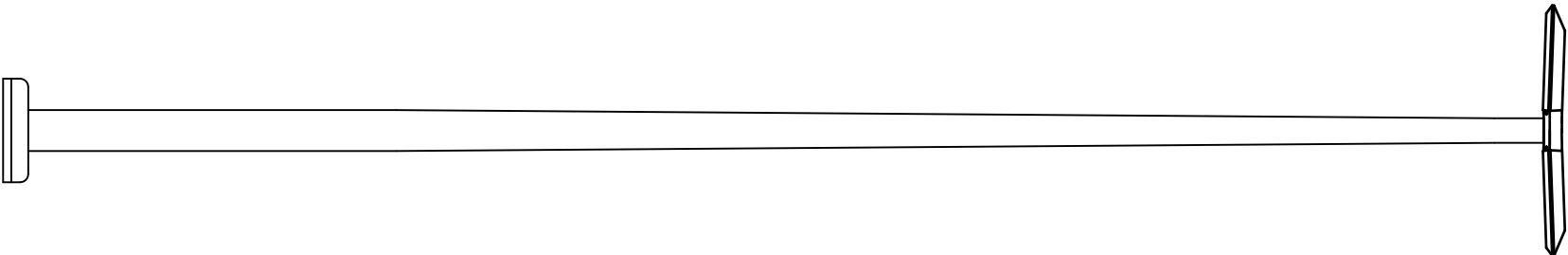
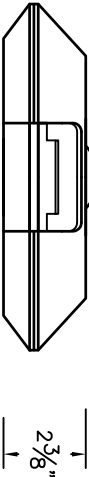
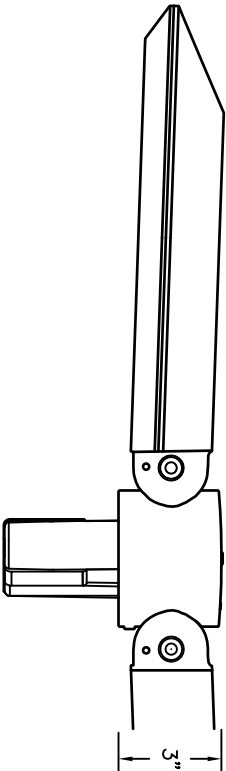
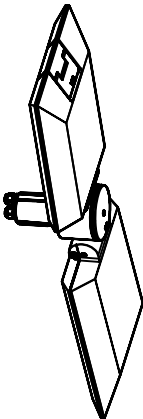
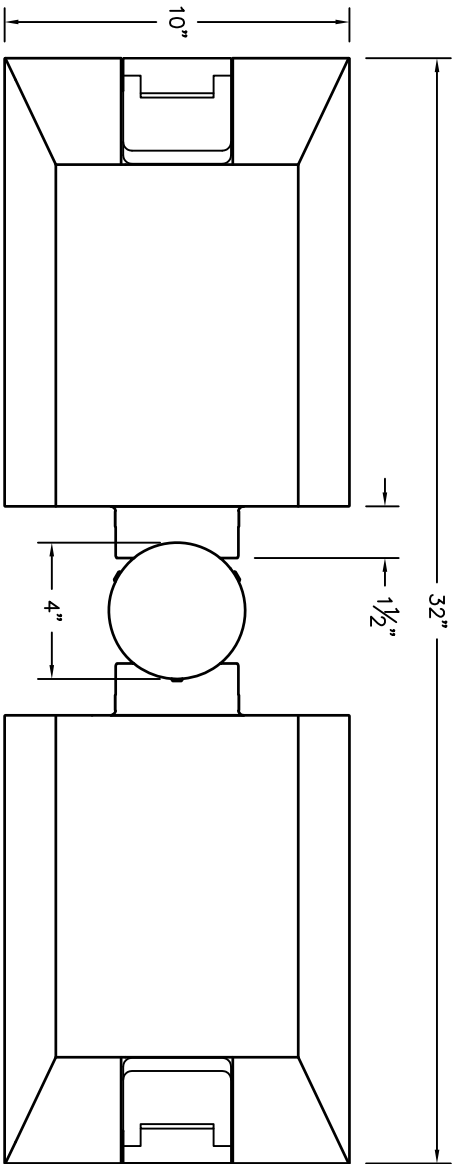

SHOWN ON 1508HR
(SCALE 1:4)

TYPE: _____

SUBMITTAL APPROVAL			CAT NO.: <u>99 529</u>		BEGA
			PROJECT: <u>-</u>		
APPROVED BY: _____		LOCATION: <u>-</u>		1000 Bega Way Carpinteria, Ca. 93013 (805) 684-0533	
SIGNED: _____		DATE: _____			
REV.	DATE	DESCRIPTION	DRAWN: <u>RA</u> DATE: <u>11/29/2017</u> FILE NAME: <u>99529.dxf</u>		
This print contains confidential information which is the property of BEGA U.S. By acception this information, the borrower agrees that it will not be used for any other purpose other than that which is was loaned.					