

REV	CHANGED BY	DESCRIPTION	DATE

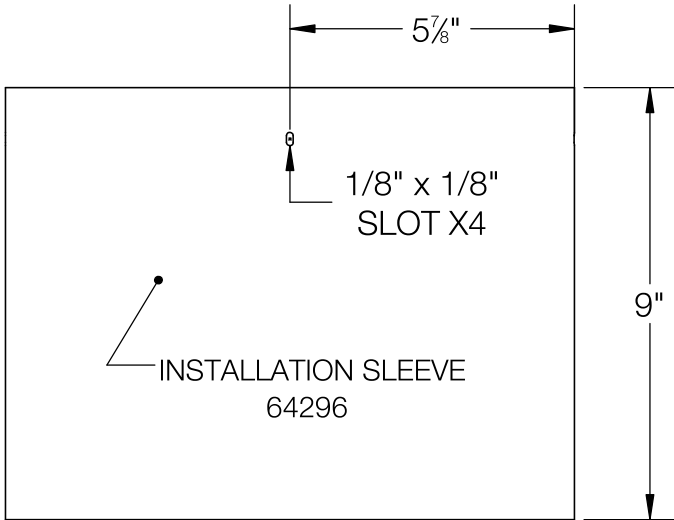
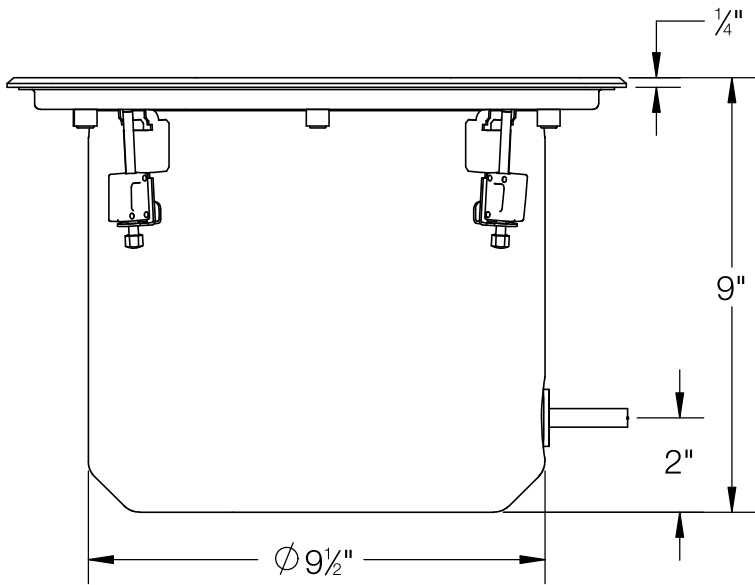
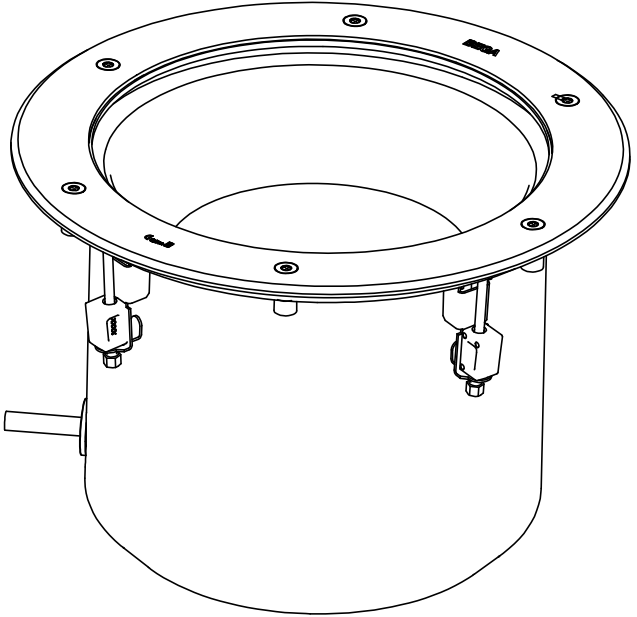
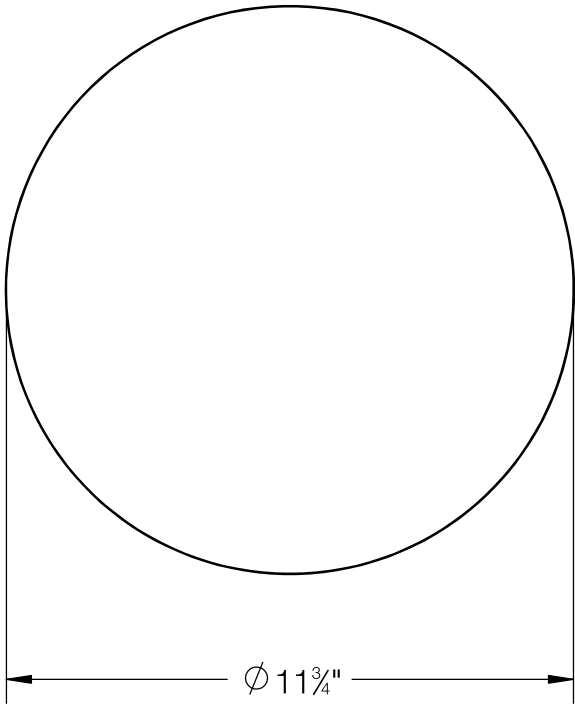
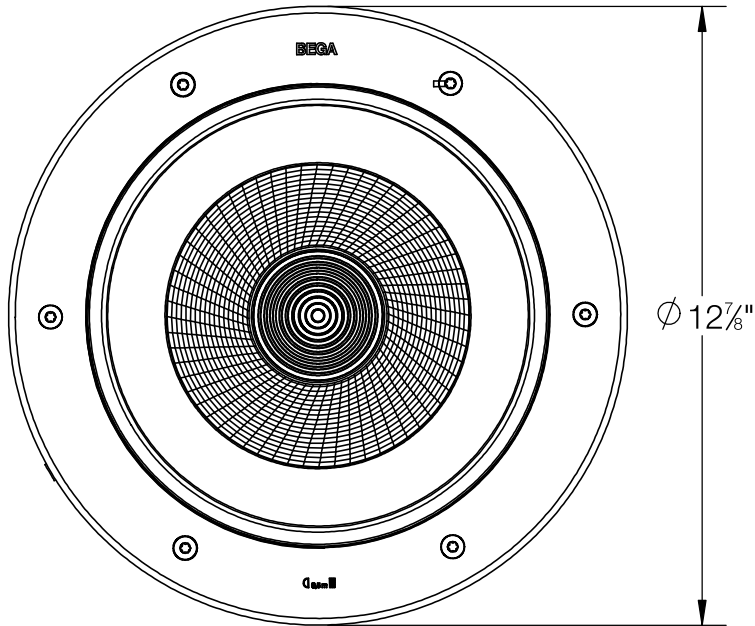

- NOTES:
1. INSTALLATION SLEEVE INCLUDED
 2. FIXING IS ACHIEVED BY USING FOUR WEDGE SHAPED CLAMPING ELEMENTS
 3. MUST SUPPLY MINIMUM OF 6" OF ADEQUATE DRAINING

BEGA				
1000 BEGA Way, Carpinteria, California 93013			P (805) 684-0533 - www.bega-us.com	
APPROVED: _____ DATE: _____		DESCRIPTION: IN-GRADE LUMINAIRE - SYMMETRIC - WIDE BEAM		
TYPE: _____				
PROPRIETARY AND CONFIDENTIAL THE INFORMATION CONTAINED IN THIS DRAWING IS THE SOLE PROPERTY OF BEGA NORTH AMERICA, INC. ANY REPRODUCTION IN PART OR AS A WHOLE WITHOUT THE WRITTEN PERMISSION OF BEGA NORTH AMERICA, INC. IS PROHIBITED.		SIZE	PART NO.	REV
		B	84561	-
		NOT TO SCALE	10/26/2025	SHEET 1 OF 2

REV	CHANGED BY	DESCRIPTION	DATE

FINSIHED GRADE

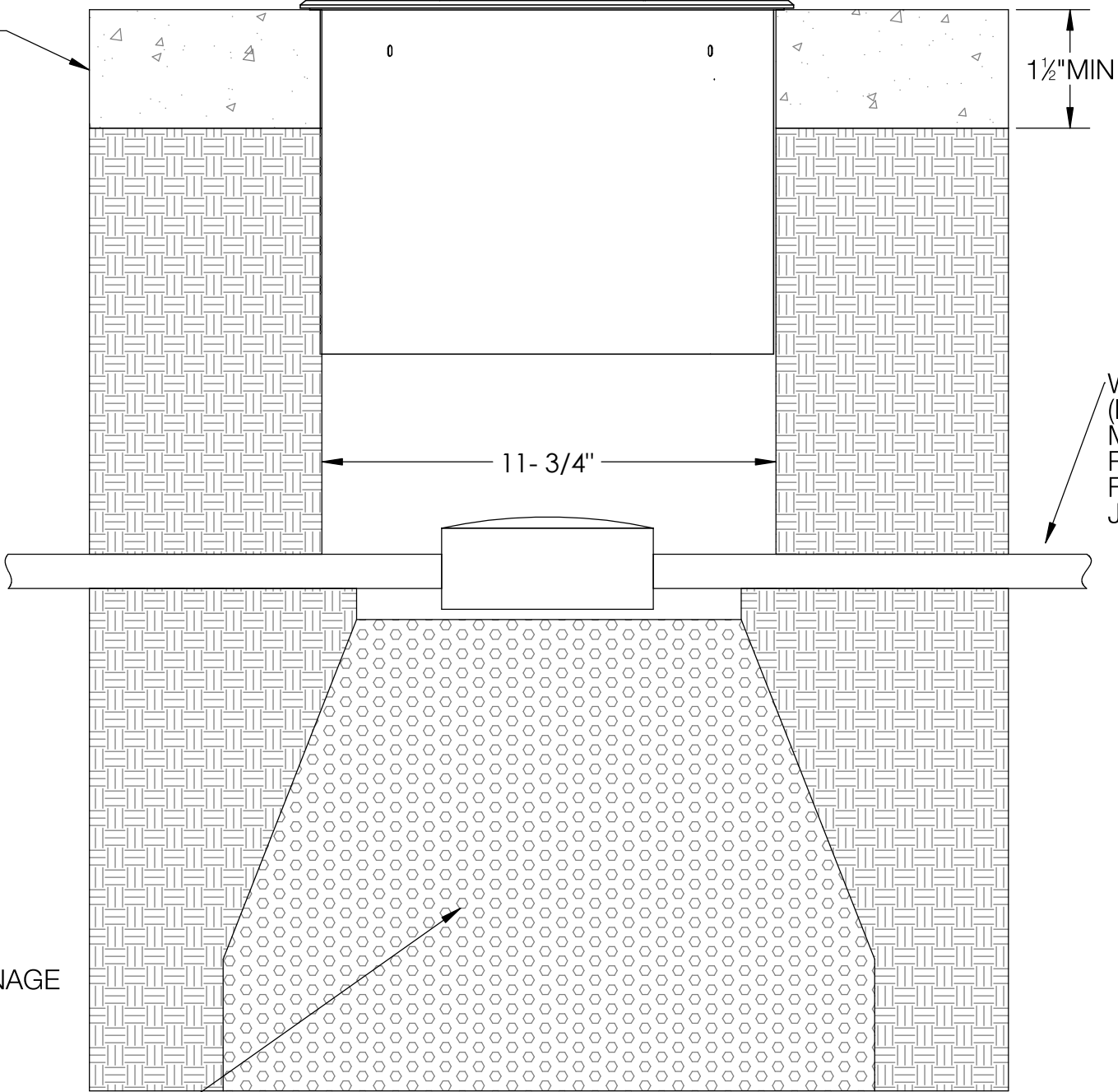

WATERPROOF J-BOX
(BY OTHERS)
MINIMUM 4"
RECOMMENDED BELOW
FIXTURE FOR CABLE AND
JUNCTION BOX

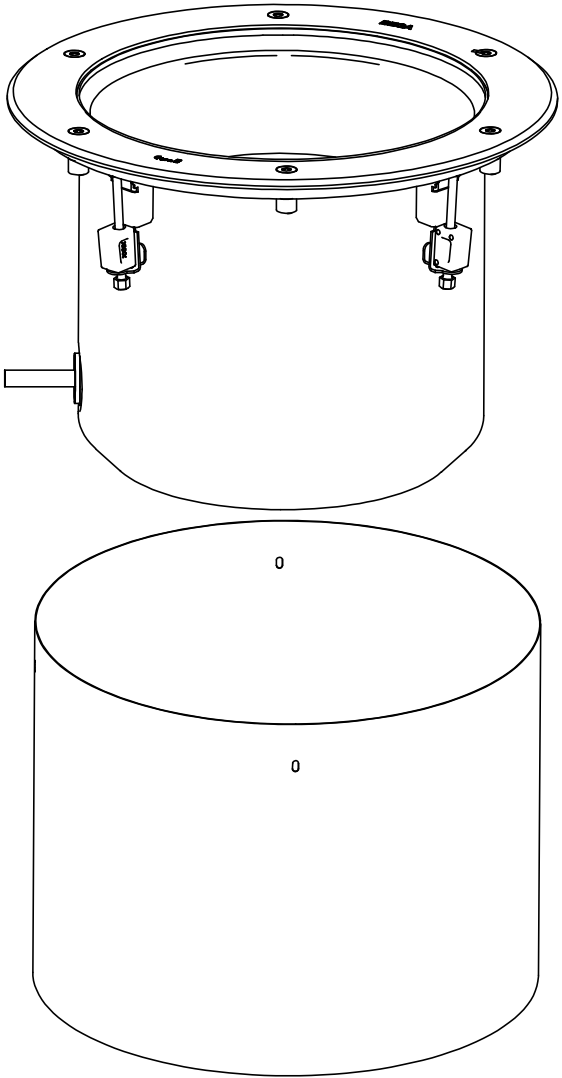

NOTES:

1. INSTALLATION HOUSING/SLEEVE INCLUDED
2. REQUIRED RECESSED OPENING Ø 11 3/4"
3. MUST SUPPLY MINIMUM OF 6" OF ADEQUATE DRAINING
4. THE UPPER EDGE OF THE RECESS OPENING MUST BE FIRM ON A THICKNESS OF 1 1/2" MIN IN ORDER TO ACCEPT THE CLAMPING FORCES OF THE LUMINAIRE.

PROVIDE A MINIMUM OF 6" OF PEA GRAVEL TO MAINTAIN PROPER DRAINAGE

NOTE: MORE GRAVEL MAYBE BE REQUIRED IN AREAS THAT HAVE POOR SOIL DRAINAGE AND/OR ARE SUBJECT TO FREEZING

BEGA

1000 BEGA Way, Carpinteria, California 93013 P (805) 684-0533 - www.bega-us.com

APPROVED: _____ DATE: _____ DESCRIPTION: IN-GRADE LUMINAIRE - SYMMETRIC - WIDE BEAM
TYPE: _____

PROPRIETARY AND CONFIDENTIAL THE INFORMATION CONTAINED IN THIS DRAWING IS THE SOLE PROPERTY OF BEGA NORTH AMERICA, INC. ANY REPRODUCTION IN PART OR AS A WHOLE WITHOUT THE WRITTEN PERMISSION OF BEGA NORTH AMERICA, INC. IS PROHIBITED.	SIZE B	PART NO. 84561	REV -
	NOT TO SCALE	10/26/2025	SHEET 2 OF 2